

AVAILABLE FOR LEASE: ±28,528 SF (DIVISIBLE TO ±14,264 SF)

13651 DANIELSON STREET, SUITES D-G

PARKWAY COMMERCE CENTER :: POWAY, CA 92064



Bill Dolan

Lic 01188240
+1 858 546 4678
bill.dolan@cbre.com

Sean Williams

Lic 01475415
+1 858 546 4625
sean.williams@cbre.com

Ryan Sparks

Lic 01784736
+1 858 546 2606
ryan.sparks@cbre.com



AVAILABLE FOR LEASE: ±28,528 SF (DIVISIBLE TO ±14,264 SF)

13651 DANIELSON STREET, SUITES D-G

PARKWAY COMMERCE CENTER :: POWAY, CA 92064



FEATURES

- ±28,528 SF (divisible to ±14,264 SF)
- (10) Dock High Loading Doors
- (2) Grade Level Loading Doors
- ±20% office
- Excellent Truck Access with Full Drive Around Capability
- Approximate 22'-25' Clear Height
- Column Spacing ±47' x 50' (typical)
- Full Concrete Loading Area
- Sprinklered
- Gas Potentially Available
- Visibility from Scripps Poway Parkway
- ±51,053 SF Warehouse/ Distribution Building - Part of an Approximately 147,908 SF Project
- Close Proximity to Retail Amenities, Directly Across the Street from Costco & Home Depot
- All Cox Cable Business Class Services Available to Project (including Coax and Fiber)
- Skylights Throughout Building
- Outstanding On-site Deli
- Lease Rate: \$0.75/SF Net of Expenses (NNN exps = \$0.24/SF)

Bill Dolan

Lic 01188240
+1 858 546 4678
bill.dolan@cbre.com

Sean Williams

Lic 01475415
+1 858 546 4625
sean.williams@cbre.com

Ryan Sparks

Lic 01784736
+1 858 546 2606
ryan.sparks@cbre.com



CBRE

AVAILABLE FOR LEASE: ±28,528 SF (DIVISIBLE TO ±14,264 SF)

13651 DANIELSON STREET, SUITES D-G

PARKWAY COMMERCE CENTER :: POWAY, CA 92064

SINGLE TENANT FLOOR PLAN:

±28,528 SF (DIVISIBLE TO ±14,264 SF)

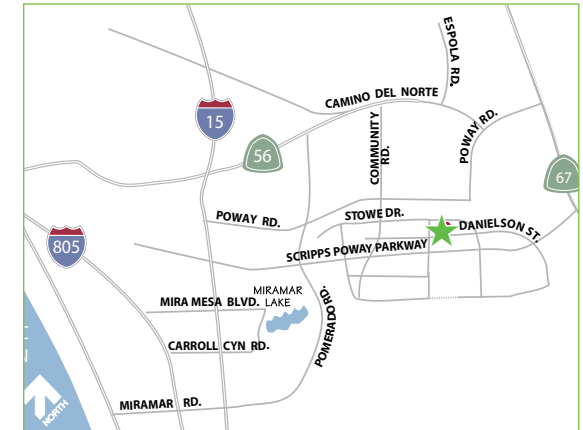
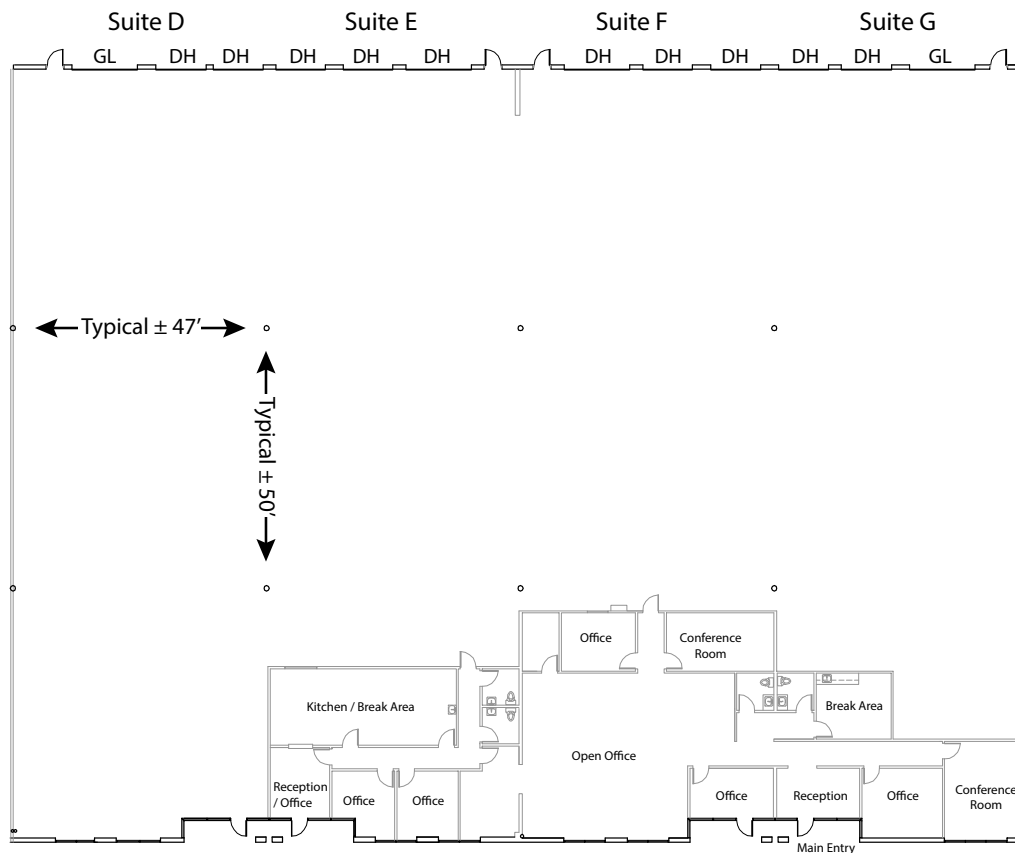

Bill Dolan
Lic 01188240
+1 858 546 4678
bill.dolan@cbre.com

Sean Williams
Lic 01475415
+1 858 546 4625
sean.williams@cbre.com

Ryan Sparks
Lic 01784736
+1 858 546 2606
ryan.sparks@cbre.com



AVAILABLE FOR LEASE: ±28,528 SF (DIVISIBLE TO ±14,264 SF)

13651 DANIELSON STREET, SUITES D-G

PARKWAY COMMERCE CENTER :: POWAY, CA 92064

DIVISIBILITY FLOOR PLAN: ±14,264 SF

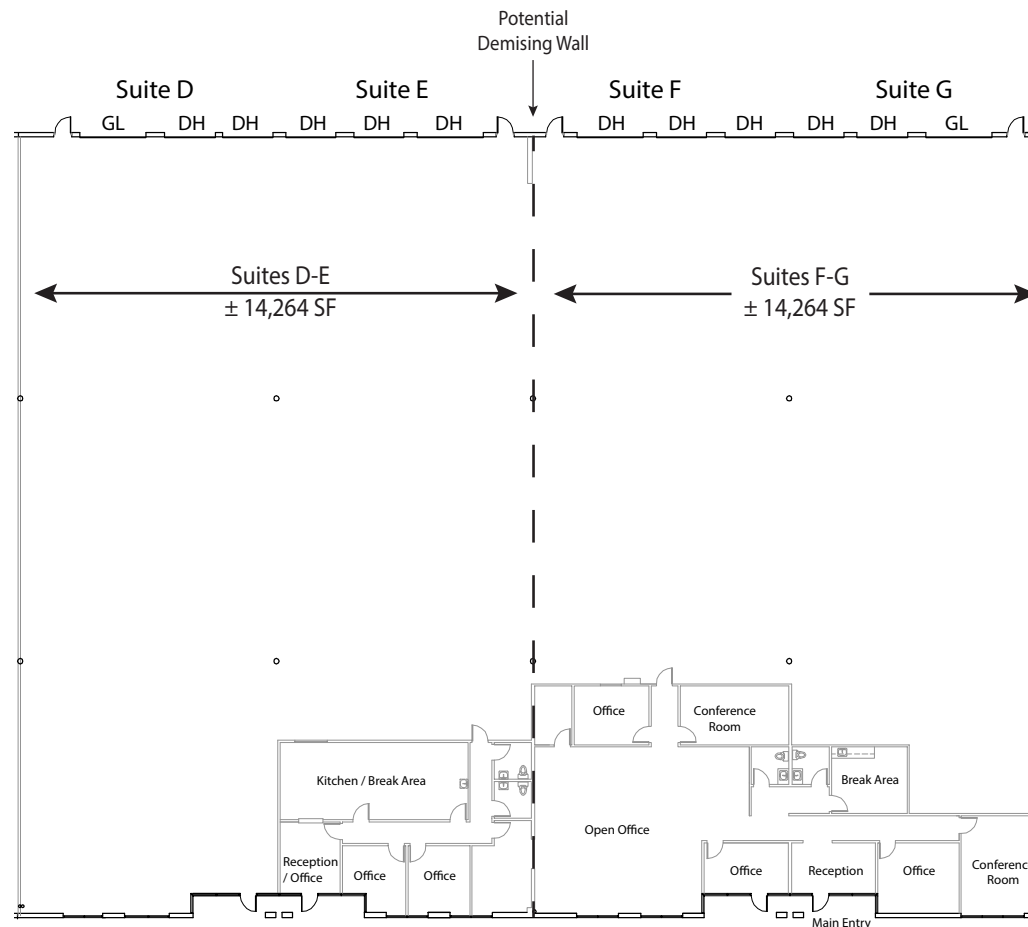

Bill Dolan

Lic 01188240
+1 858 546 4678
bill.dolan@cbre.com

Sean Williams

Lic 01475415
+1 858 546 4625
sean.williams@cbre.com

Ryan Sparks

Lic 01784736
+1 858 546 2606
ryan.sparks@cbre.com



AVAILABLE FOR LEASE: ±28,528 SF (DIVISIBLE TO ±14,264 SF)

13651 DANIELSON STREET, SUITES D-G

PARKWAY COMMERCE CENTER :: POWAY, CA 92064



CBRE, Inc. | 4365 Executive Drive, Suite 1600 | San Diego, CA 92121 | www.cbre.com/sandiego

© 2014 CBRE, Inc. This information has been obtained from sources believed reliable. We have not verified it and make no guarantee, warranty or representation about it. Any projections, opinions, assumptions or estimates used are for example only and do not represent the current or future performance of the property. You and your advisors should conduct a careful, independent investigation of the property to determine to your satisfaction the suitability of the property for your needs. Photos herein are the property of their respective owners and use of these images without the express written consent of the owner is prohibited. N:\Team-Dolan\Listings\Parkway Commerce Center\Active Brochures\P- Danielson Street 13651\For Lease\P-Danielson Street_13651.indd

