

Dolphin Business Park

999 Rancheros Dr, Ste B
San Marcos, CA 92069

**Freeway Exposure
and Fenced Yard!**

±4,700 SF available

Fenced yard parking

2 grade level doors

Reception, open office, two
restrooms, and warehouse

Frontage along Hwy 78

Easy access to Hwy 78 via
Woodland Pwky and Barham Dr

Available 12/1/2016

Call to show

\$1.00 PSF Industrial Gross



Location

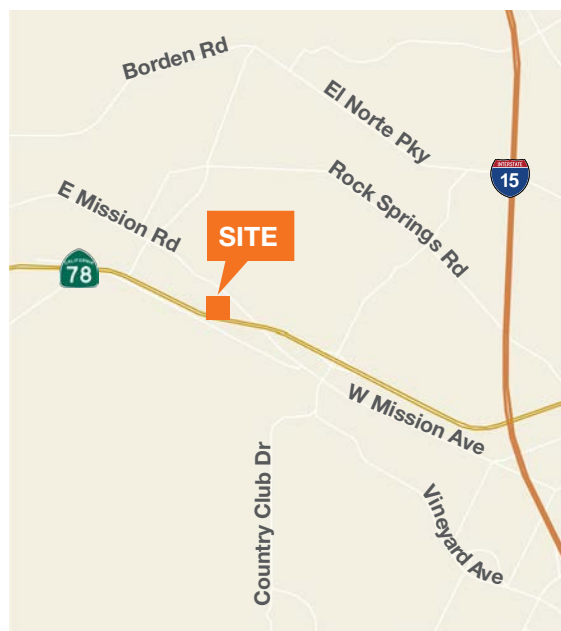

Contact

Joseph S. McDermott
858.369.3012
joem@kiddermathews.com
LIC #01329963



John Witherall
760.930.7927
john.witherall@colliers.com
LIC #01759453



Dolphin Business Park

999 Rancheros Dr
Suite B | ±4,700 SF

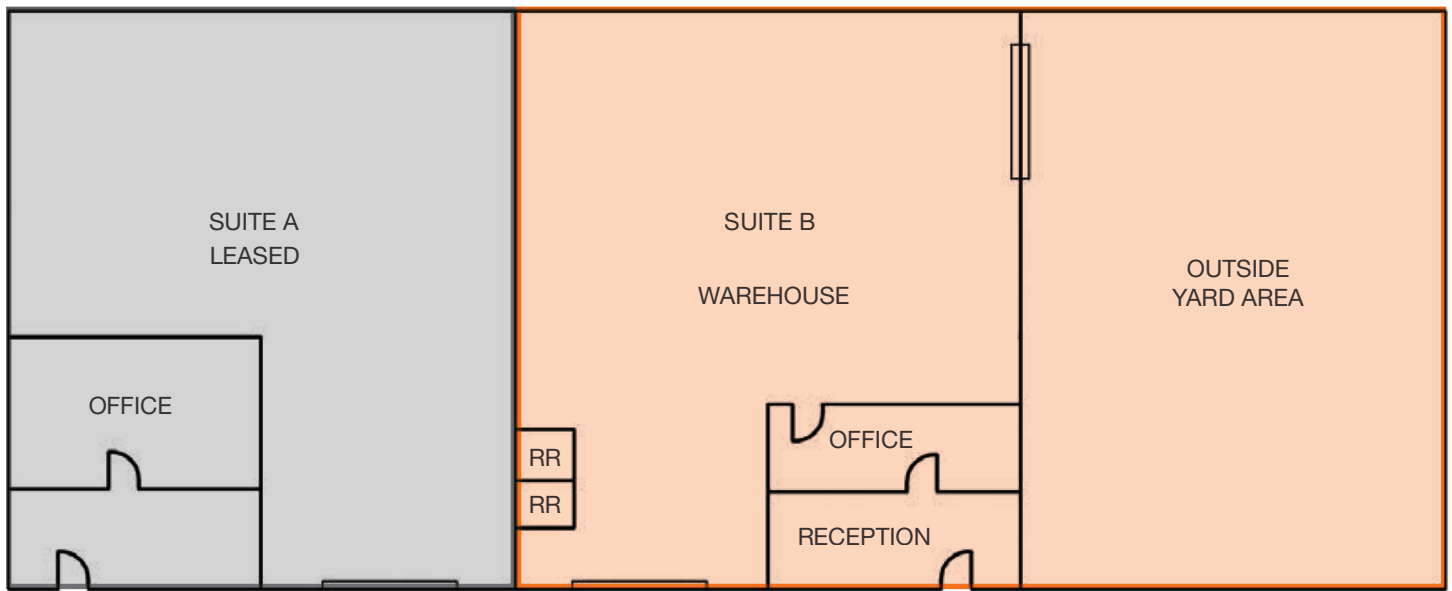

Contact

KIDDER MATHEWS

Joseph S. McDermott

858.369.3012 | LIC #01329963

joem@kiddermathews.com

COLLIERS INTERNATIONAL

John Witherall

760.930.7927 | LIC #01759453

john.witherall@colliers.com

CO-BROKERED BY



Dolphin Business Park

999 Rancheros Dr
Aerial

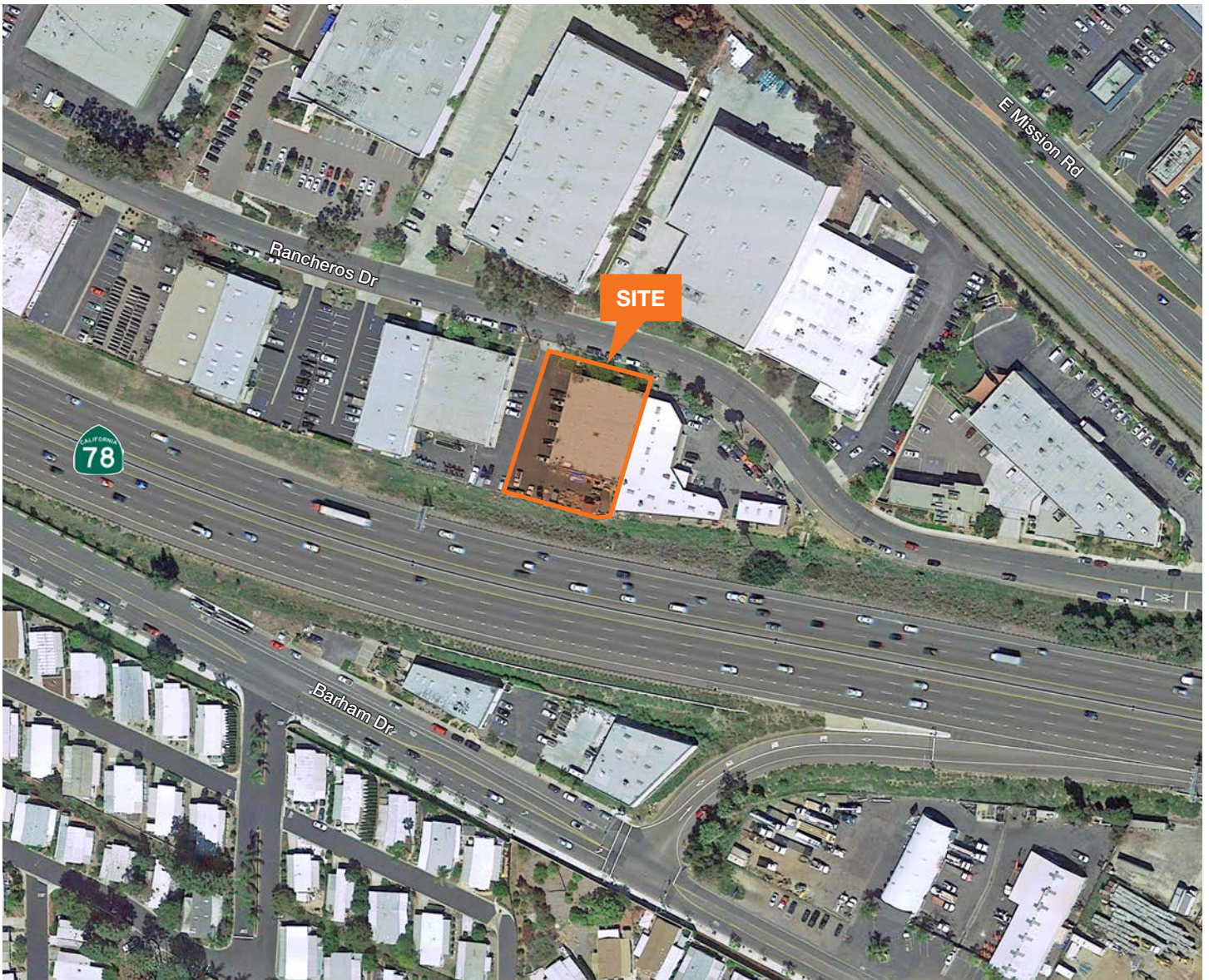

Contact

KIDDER MATHEWS

Joseph S. McDermott

858.369.3012 | LIC #01329963

joem@kiddermathews.com

COLLIERS INTERNATIONAL

John Witherall

760.930.7927 | LIC #01759453

john.witherall@colliers.com

CO-BROKERED BY



Dolphin Business Park

999 Rancheros Dr
Property Photos



Contact

KIDDER MATHEWS

Joseph S. McDermott

858.369.3012 | LIC #01329963

joem@kiddermathews.com

COLLIERS INTERNATIONAL

John Witherall

760.930.7927 | LIC #01759453

john.witherall@colliers.com

CO-BROKERED BY

