

FOR LEASE

Owned by
LINK



VISTA DISTRIBUTION CENTER

1225
Park Center Drive
Suite A

Industrial Suite
24,332 SF

TUCKER HOHENSTEIN, SIOR
Senior Executive Vice President
+1 760 930 7966
tucker.hohenstein@colliers.com
Lic. No. 00999360

MIKE ERWIN, SIOR
Senior Executive Vice President
+1 760 930 7971
mike.erwin@colliers.com
Lic. No. 01242826

San Diego - North
5901 Priestly Drive | Suite 100
Carlsbad, CA 92008
Main: +1 760 438 8950



©2020 Colliers International. Information herein has been obtained from sources deemed reliable, however its accuracy cannot be guaranteed. The user is required to conduct their own due diligence and verification.

FOR LEASE



24,332 SF

Industrial space ideal for manufacturing, distribution & warehouse users.

\$0.95/SF NNN

NNN ESTIMATED AT \$0.24/SF



600 amps
277/480V



2.00/1,000/SF



24' clear height

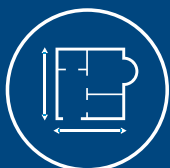

Office Area
3,648 SF



2 Dock High
2 Grade Level



Convenient access
to major roads

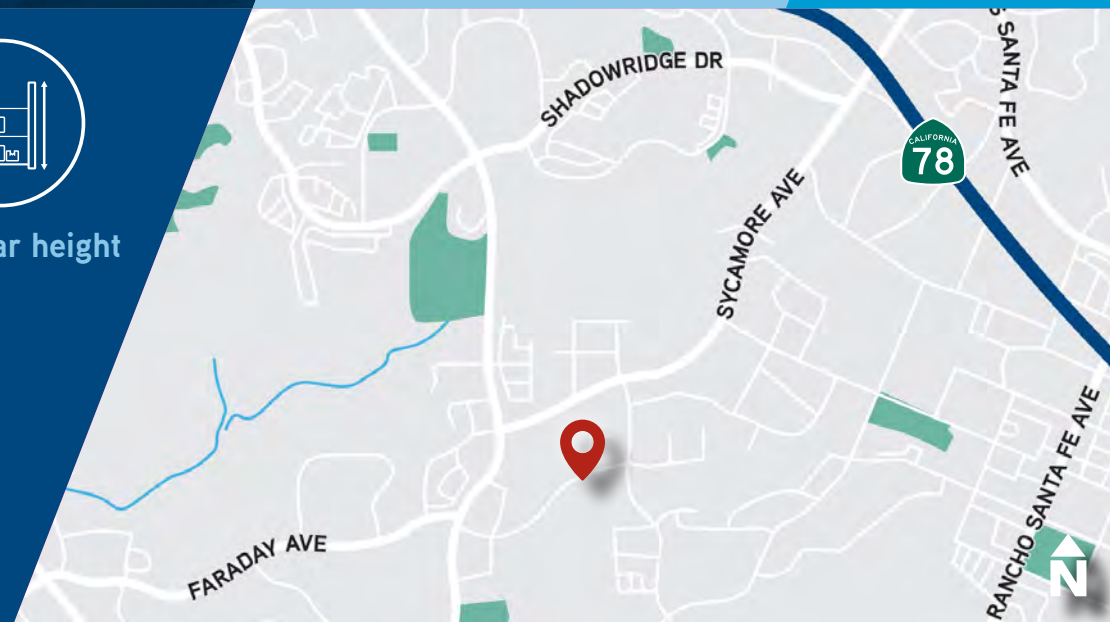

FOR LEASE

Floor Plan

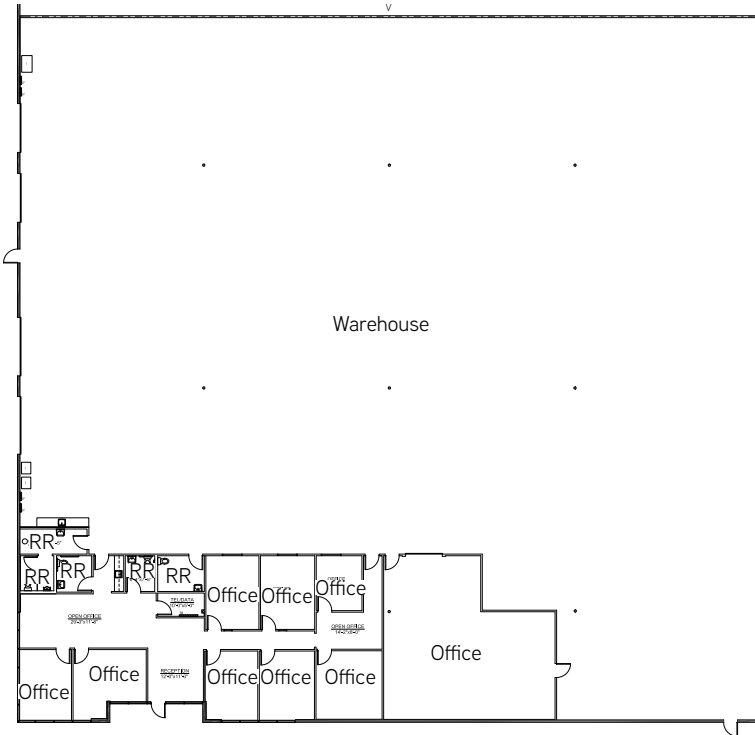

Site Plan

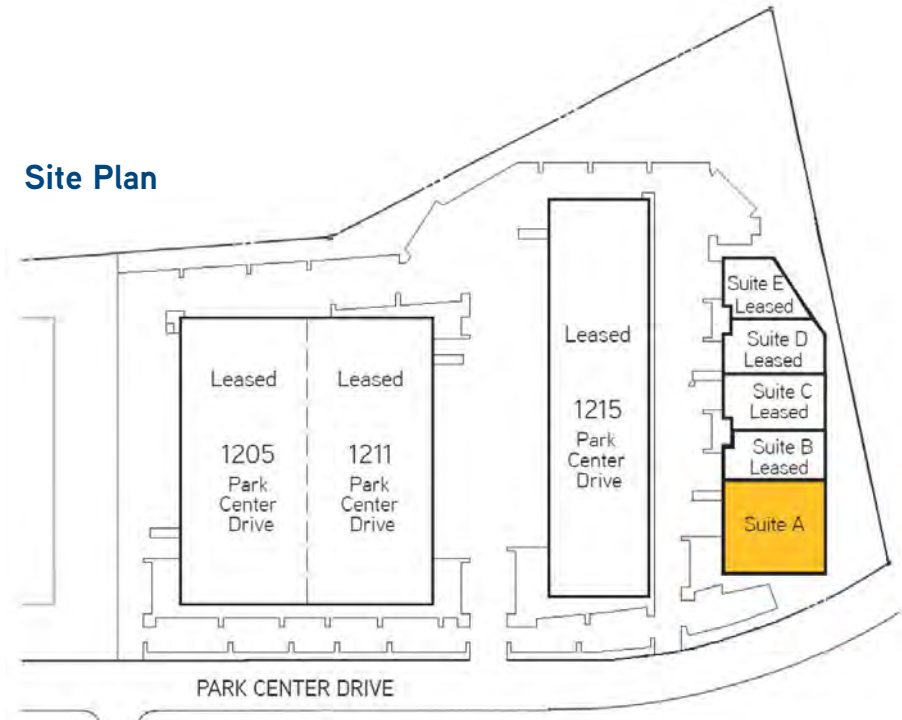

\$0.95/SF NNN
NNN ESTIMATED AT \$0.24/SF

FOR LEASE

Owned by
LINK



TUCKER HOHENSTEIN, SIOR
Senior Executive Vice President
+1 760 930 7966
tucker.hohenstein@colliers.com
Lic. No. 00999360

MIKE ERWIN, SIOR
Senior Executive Vice President
+1 760 930 7971
mike.erwin@colliers.com
Lic. No. 01242826

This document has been prepared by Colliers International for advertising and general information only. Colliers International makes no guarantees, representations or warranties of any kind, expressed or implied, regarding the information including, but not limited to, warranties of content, accuracy and reliability. Any interested party should undertake their own inquiries as to the accuracy of the information. Colliers International excludes unequivocally all inferred or implied terms, conditions and warranties arising out of this document and excludes all liability for loss and damages arising there from. This publication is the copyrighted property of Colliers International and/or its licensor(s). ©2020. All rights reserved.

San Diego - North
5901 Priestly Drive | Suite 100
Carlsbad, CA 92008
Main: +1 760 438 8950

