

SCOTT ROAD COMMERCE CENTER

BUILDINGS 1 AND 2

MENIFEE, CALIFORNIA

FOR LEASE OR SALE



BUILDING 1 (2018)

33380 Zeiders Road

72,835 S.F. — Divisible
LEASED



BUILDING 2 (2022)

33360 Zeiders Road

84,312 S.F. — Divisible
13,000 — 15,000 S.F. Units

JUPITER



BUILDING SPECIFICATIONS

BUILDING #	S.F.	Unit Sizes	Acres	Clear Height	Dock-High Doors	Office Space SF	Grade Level Doors	Parking	Power	Gas	Sprinkler
1 33380 Zeiders Rd. LEASED	72,835	36,417	5.23	24'	20	± 9%	6	109	4,000 Amps 277/480V	Yes	.37/3,000 SF
2 33360 Zeiders Rd.	84,312	13,432 -26,864	5.36	24'	18	± 9%	6	122	2,000 Amps 277/480V	Yes	.80/2,000 SF *

*Allows a variety of high pile storage options

JUPITER

SITE PLAN

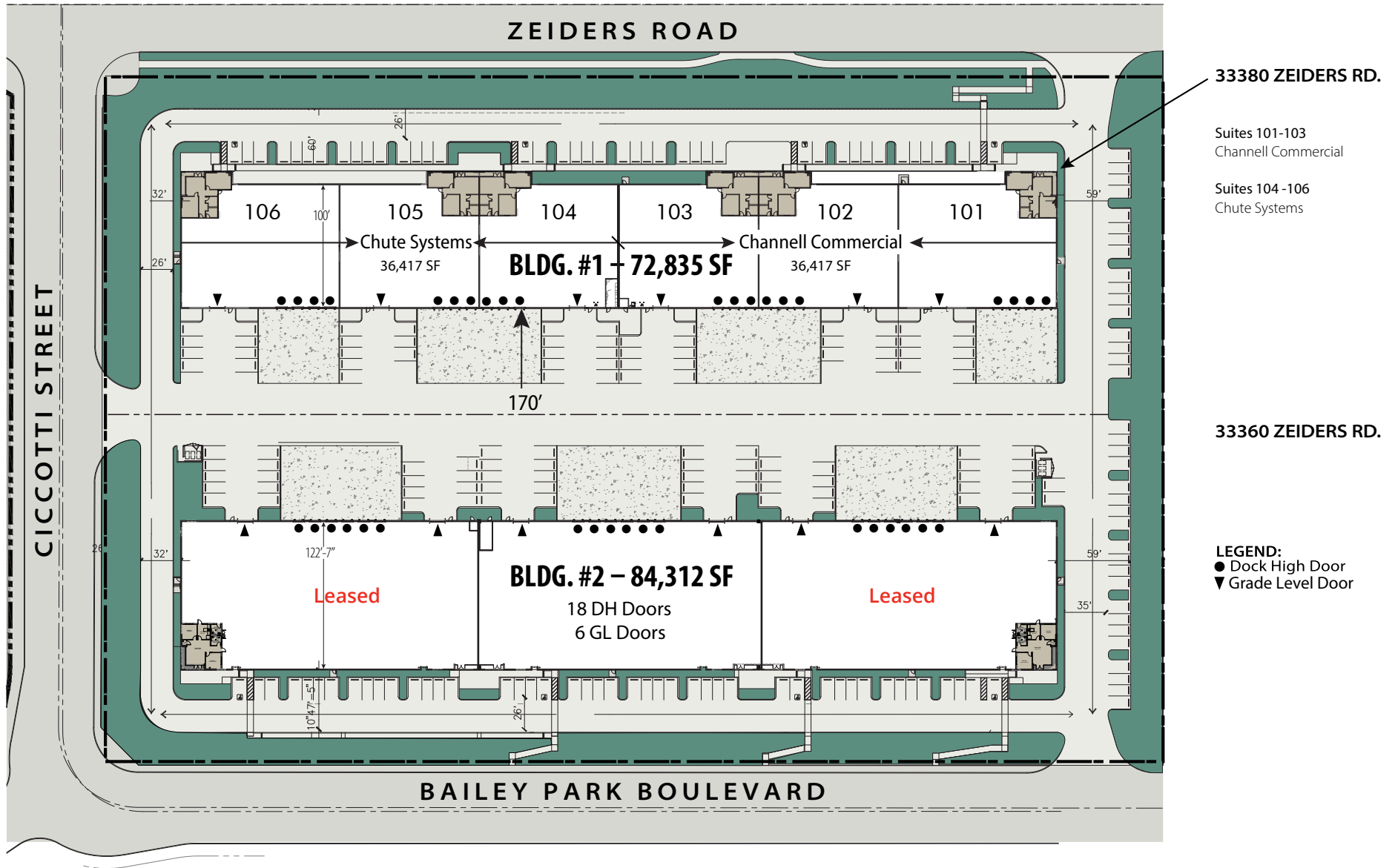

JUPITER

PROPOSED DIVISIBILITY PLAN

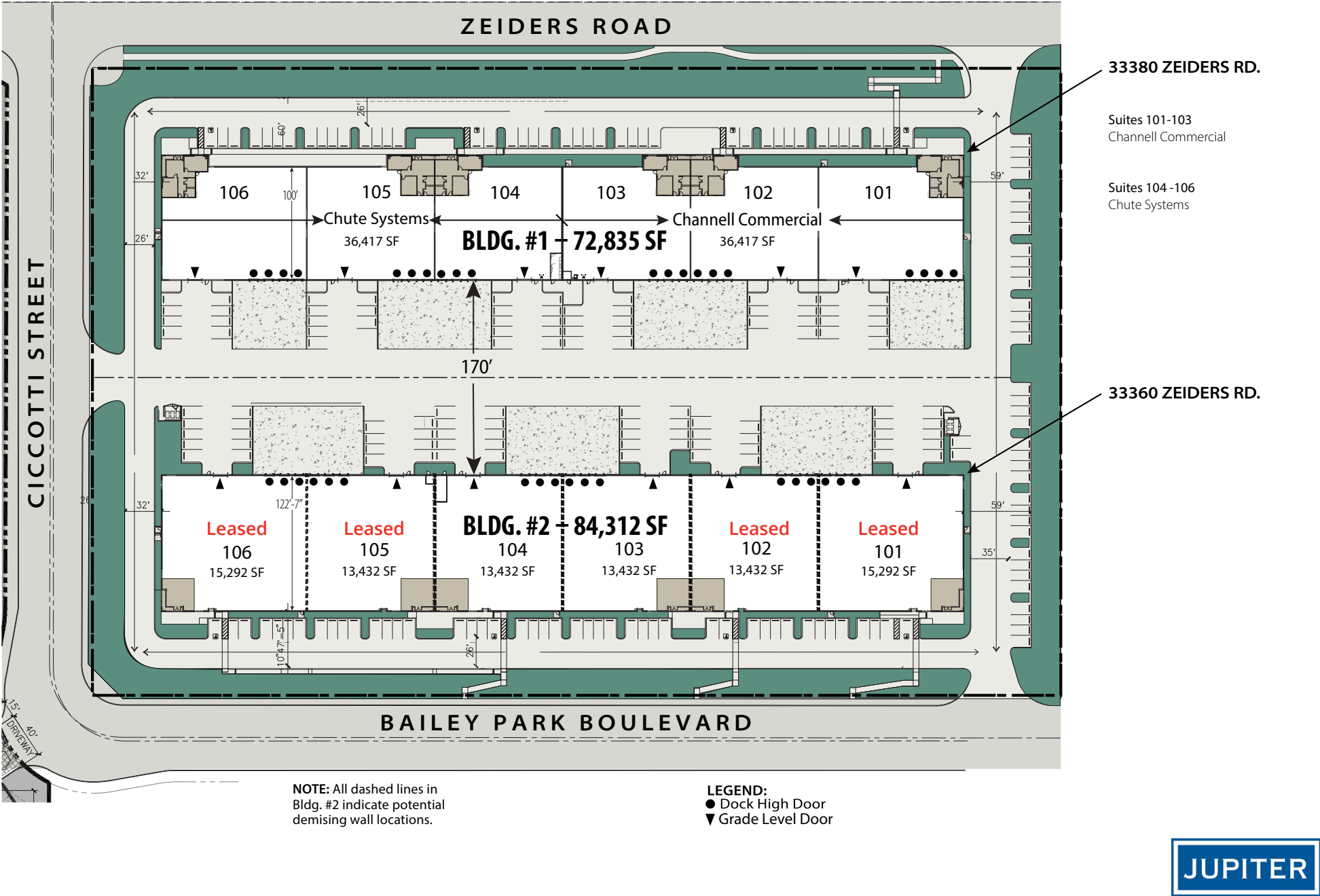

SCOTT ROAD COMMERCE CENTER



High Image Buildings

with Dock High and Grade Level Loading

Direct Access

off of Scott Road Interchange

Easy Access

to North San Diego County, the
Temecula Valley and Riverside County

For further information contact:



Tucker Hohenstein, SIOR

LICENSE NO. 00999360

tucker.hohenstein@colliers.com

+1 760 930 7966

Joey Jones

LICENSE NO. 01952925

joey.jones@colliers.com

+1 909 612 2628

Hank Jenkins

LICENSE NO. 01981328

hank.jenkins@colliers.com

+1 760 930 7904



Gordon Mize

LICENSE NO. 01275376

gmize@leetemecula.com

+1 951 445 4504



Drive Times

Murrieta | 14 minutes

Temecula | 17 minutes

North County San Diego | 45 minutes

Ontario | 50 minutes

Los Angeles | 75 minutes

JUPITER