

FOR LEASE | ±93,662 SF INDUSTRIAL WAREHOUSE  
WITH ±1 ACRE SECURED YARD

# 1445 | ENGINEER STREET

VISTA, CA 92081



For more information, please contact:

**ARIC STARCK**  
760.431.4211  
aric.starck@cushwake.com  
CA Lic. #01325461

**DENNIS VISSER**  
760.431.4216  
dennis.visser@cushwake.com  
CA Lic. #01255595

1000 Aviara Parkway, Suite 100  
Carlsbad, CA 92011  
P. +1 760 431 4200 F. +1 760 454 3869



# building specifications

<b>ADDRESS:</b>	1445 Engineer Street, Vista
<b>RBA:</b>	±93,662 SF
<b>% OFFICE:</b>	±10%
<b>YARD AREA:</b>	±1.0 acre secured yard
<b>LOADING DOORS:</b>	7 dock positions 5 grade level
<b>AVAILABLE:</b>	NOW
<b>YEAR BUILT:</b>	1999
<b>CLEAR HEIGHT:</b>	26' min.
<b>POWER:</b>	4,000A 277/480v
<b>PARKING:</b>	2.00/1,000
<b>FIRE SPRINKLERS:</b>	Upgraded to ESFR in 2022
<b>ROOF:</b>	Replaced in 2022
<b>CONSTRUCTION:</b>	C.T.U.

*\*Contact broker to schedule tours.*

# site plan

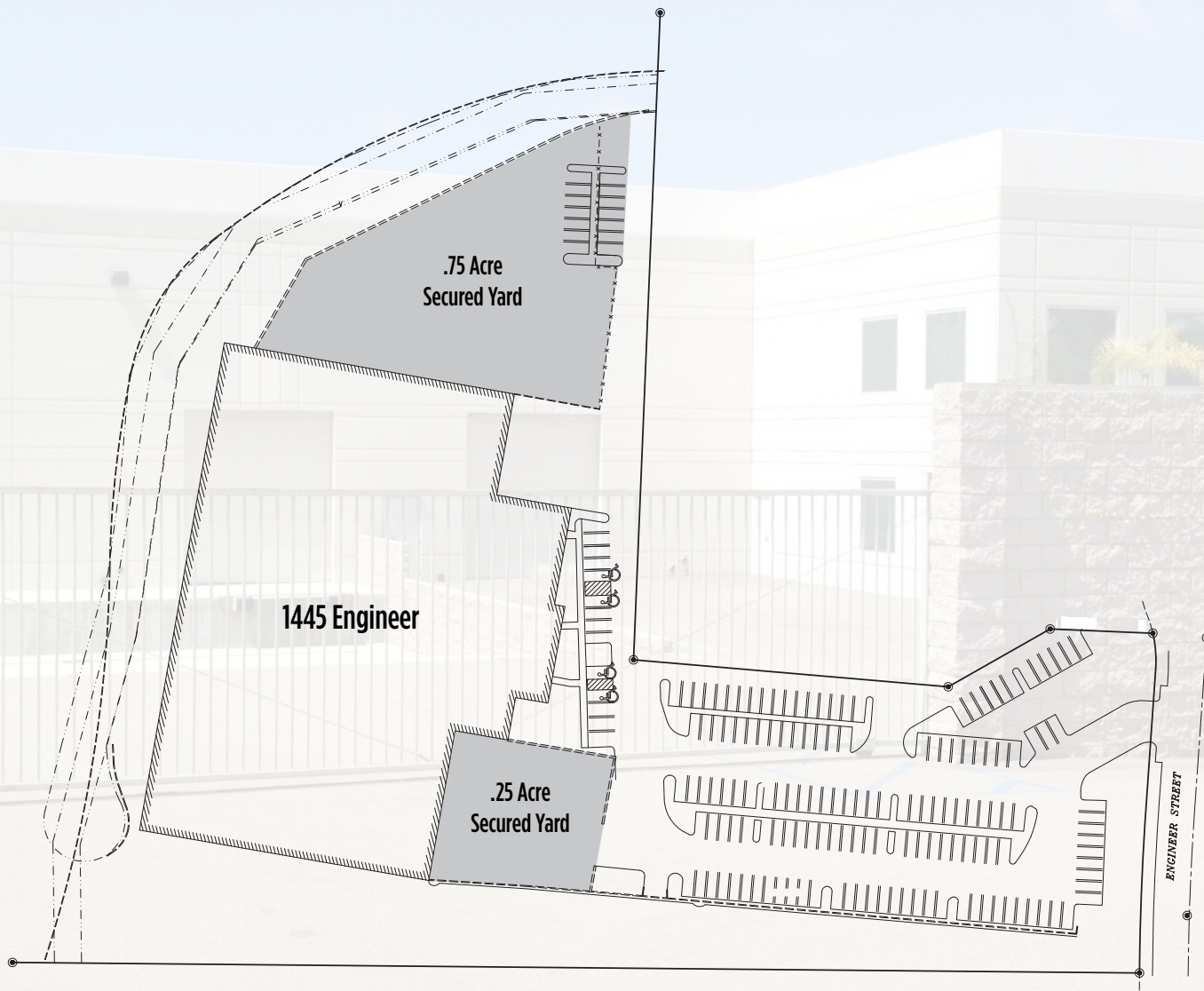

# floor plan

1445 Engineer St., Vista

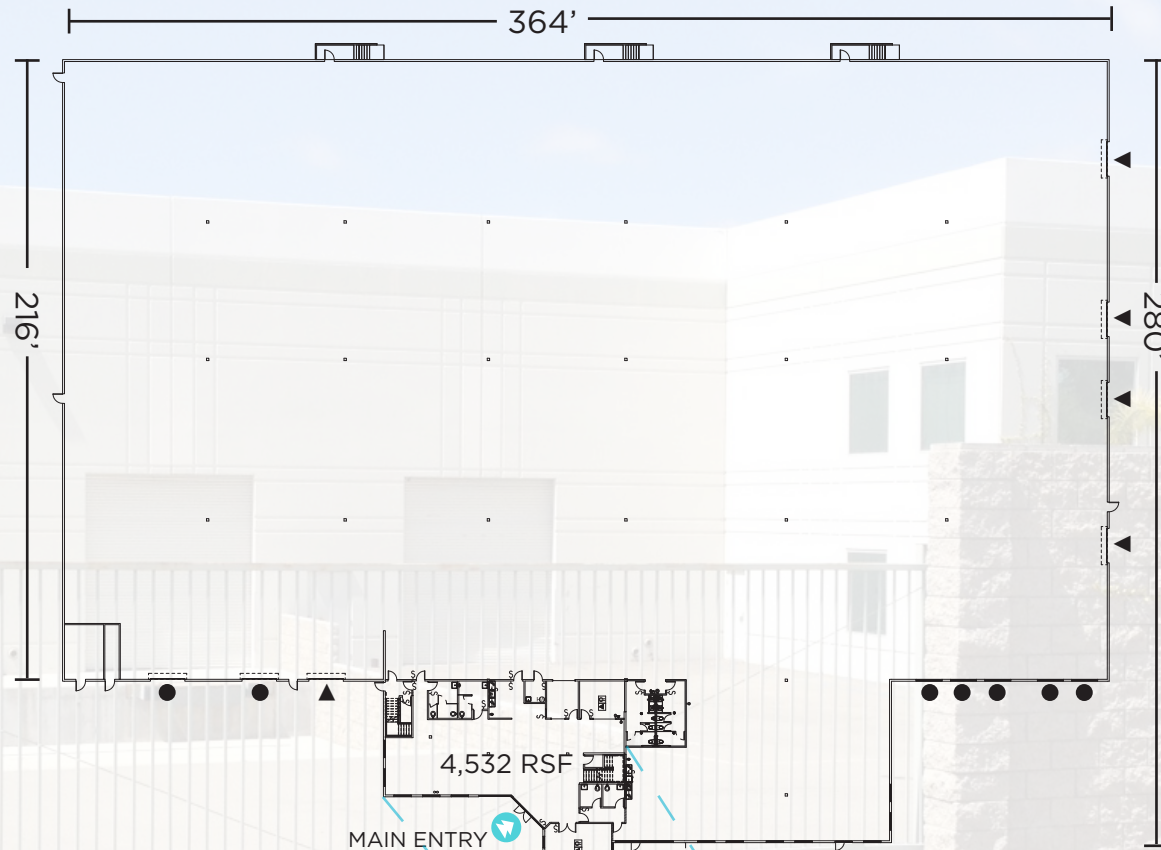

4,532 RSF  
MAIN ENTRY

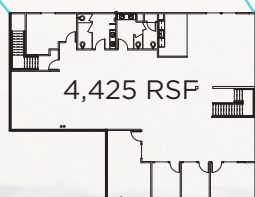

1<sup>ST</sup> FLOOR OFFICE: ±4,532 SF  
WAREHOUSE: ±84,298 SF  
UTILITY ROOM: ±407 SF  
2<sup>ND</sup> FLOOR OFFICE: ±4,425 SF  
**TOTAL: ±93,662 SF**

● Dock High Loading    ▲ Grade Level Loading

# gallery



market aerial



1445

ENGINEER ST.

ENGINEER ST.

BUSINESS PARK DR.

DISTRIBUTION WAY

SYCAMORE AVE.



FOR LEASE | ±93,662 SF INDUSTRIAL WAREHOUSE  
WITH ±1 ACRE SECURED YARD

# 1445 | ENGINEER STREET

VISTA, CA 92081

For more information, please contact:



**ARIC STARCK**  
760.431.4211  
aric.starck@cushwake.com  
CA Lic. #01325461

**DENNIS VISSER**  
760.431.4216  
dennis.visser@cushwake.com  
CA Lic. #01255595

1000 Aviara Parkway, Suite 100  
Carlsbad, CA 92011  
P. +1 760 431 4200 F. +1 760 454 3869

**VIEW SITE SPECIFIC COVID-19  
PREVENTION PLAN**

©2022 Cushman & Wakefield. All rights reserved. The information contained in this communication is strictly confidential. This information has been obtained from sources believed to be reliable but has not been verified. NO WARRANTY OR REPRESENTATION, EXPRESS OR IMPLIED, IS MADE AS TO THE CONDITION OF THE PROPERTY (OR PROPERTIES) REFERENCED HEREIN OR AS TO THE ACCURACY OR COMPLETENESS OF THE INFORMATION CONTAINED HEREIN, AND SAME IS SUBMITTED SUBJECT TO ERRORS, OMISSIONS, CHANGE OF PRICE, RENTAL OR OTHER CONDITIONS, WITHDRAWAL WITHOUT NOTICE, AND TO ANY SPECIAL LISTING CONDITIONS IMPOSED BY THE PROPERTY OWNER(S). ANY PROJECTIONS, OPINIONS OR ESTIMATES ARE SUBJECT TO UNCERTAINTY AND DO NOT SIGNIFY CURRENT OR FUTURE PROPERTY PERFORMANCE.