

FOR LEASE - 20,433 SF
INDUSTRIAL SPACE

13000

DANIELSON STREET
SUITE A-D | POWAY, CA



TED CUTHBERT
858 636 7988
ted.cuthbert@colliers.com
Lic# 00964042

5901 Priestly Drive, Suite 100 | Carlsbad, CA 92008 | www.colliers.com/carlsbad

FOR LEASE > 20,433 SF INDUSTRIAL SPACE (DIVISIBLE)

13000 DANIELSON STREET

SUITE A-D | POWAY, CA 92064

Property Features

- » Approximately 20,433 square feet available for lease (divisible)
- » Approximately 36% improved
- » Five (5) 12' X 14' grade-level loading doors
- » Power:
 - Suite A/B - two (2) electrical meters, each 400 amps of 277/480v
 - Suite C/D - one (1) electrical meter - 400 amps of 277/480v
- » Ample parking (3.5/1,000 parking ratio)
- » Approximately 24' clear height
- » **Lease Rate: \$0.98/SF Net of Operating Expenses**
(Net of Operating Expenses estimated to be \$0.18/SF/Month)

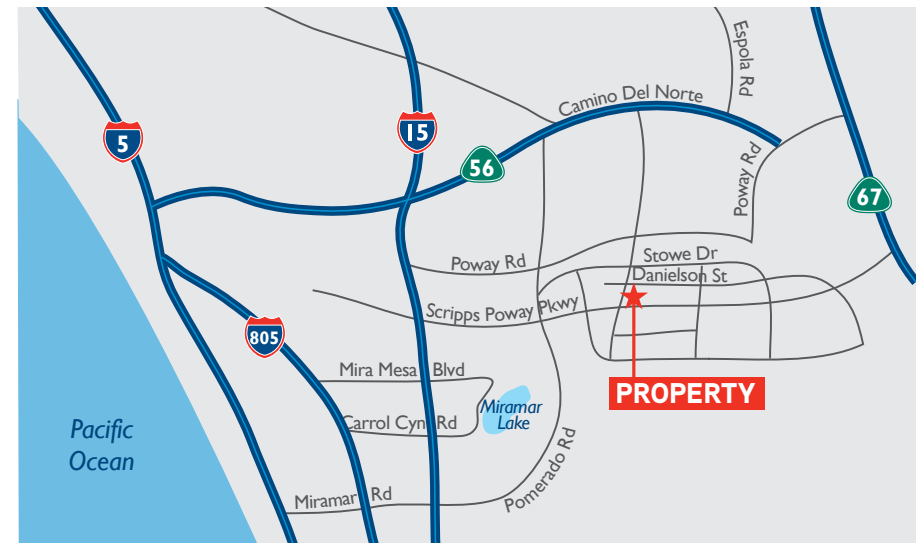

TED CUTHBERT
858 636 7988
ted.cuthbert@colliers.com
Lic# 00964042

5901 Priestly Drive, Suite 100
Carlsbad, CA 92008
www.colliers.com/carlsbad



FOR LEASE > 20,433 SF INDUSTRIAL SPACE (DIVISIBLE)

13000 DANIELSON STREET

SUITE A-D | POWAY, CA 92064

Floor Plan

First Floor

Suite A-B - 12,692 SF

Includes approx 2,500 SF improved area on the first floor

Approx. 2,243 SF improved mezzanine area

Suite C-D - 7,741 SF

Includes 1,593 improved area on the first floor

Approx. 1,225 SF improved mezzanine area

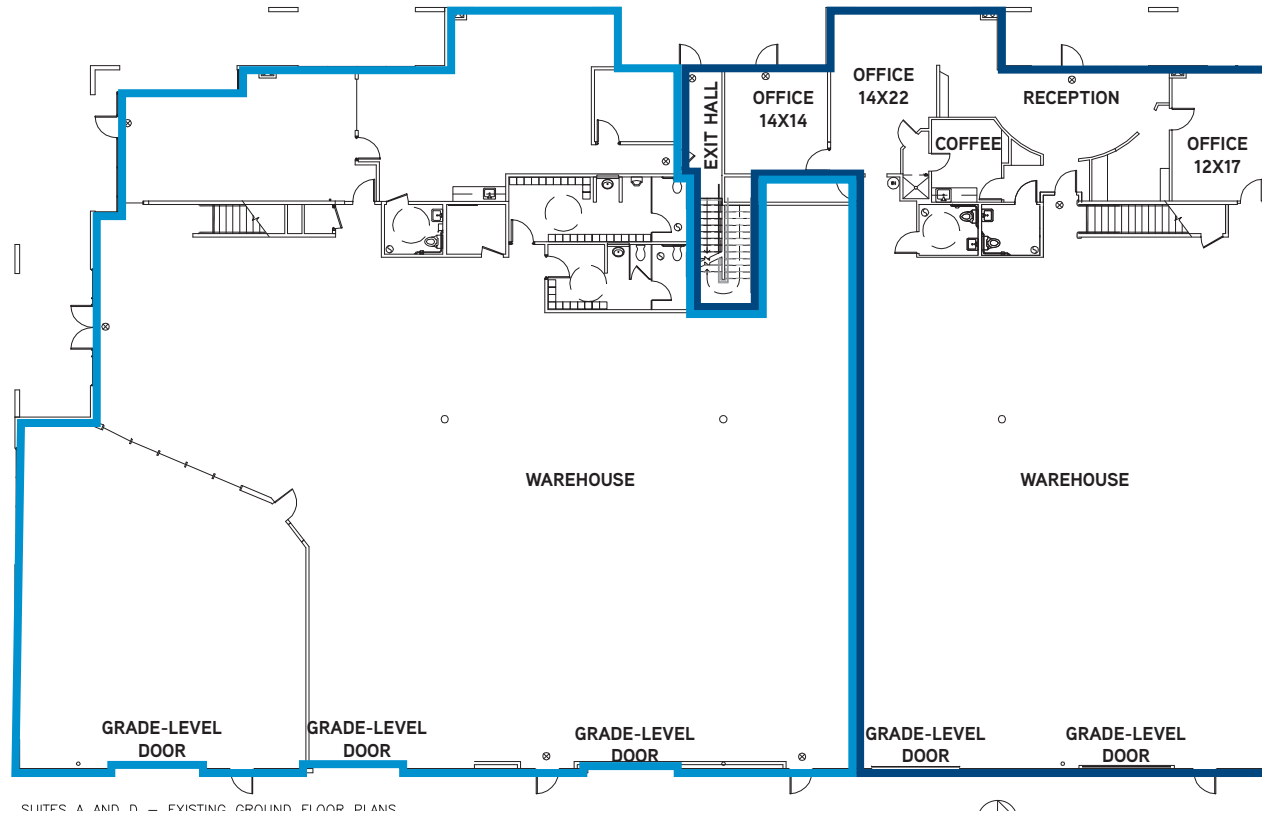

This document has been prepared by Colliers International for advertising and general information only. Colliers International makes no guarantees, representations or warranties of any kind, expressed or implied, regarding the information including, but not limited to, warranties of content, accuracy and reliability. Any interested party should undertake their own inquiries as to the accuracy of the information. Colliers International excludes unequivocally all inferred or implied terms, conditions and warranties arising out of this document and excludes all liability for loss and damages arising there from. Colliers International is a worldwide affiliation of independently owned and operated companies.

TED CUTHBERT
858 636 7988
ted.cuthbert@colliers.com
Lic# 00964042

5901 Priestly Drive, Suite 100
Carlsbad, CA 92008
www.colliers.com/carlsbad



FOR LEASE > 20,433 SF INDUSTRIAL SPACE (DIVISIBLE)

13000 DANIELSON STREET

SUITE A-D | POWAY, CA 92064

Floor Plan

Second Floor Mezzanine

- Suite A-B - 12,692 SF**
Includes approx 2,500 SF improved area on the first floor
Approx. 2,243 SF improved mezzanine area
- Suite C-D - 7,741 SF**
Includes 1,593 improved area on the first floor
Approx. 1,225 SF improved mezzanine area

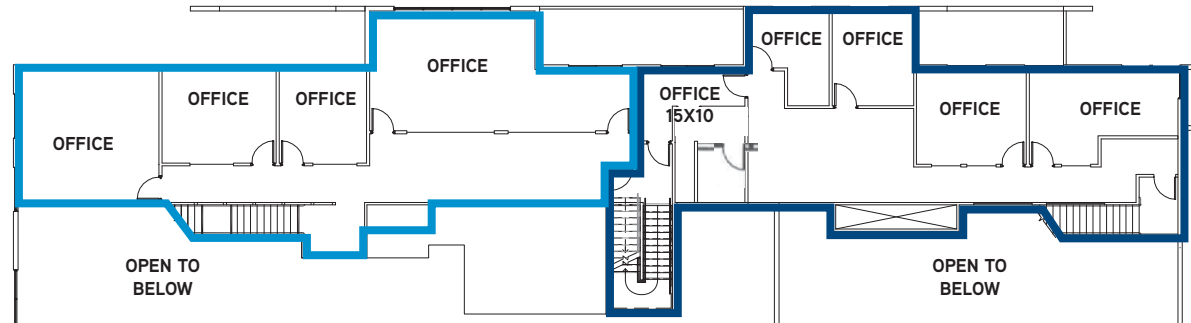

This document has been prepared by Colliers International for advertising and general information only. Colliers International makes no guarantees, representations or warranties of any kind, expressed or implied, regarding the information including, but not limited to, warranties of content, accuracy and reliability. Any interested party should undertake their own inquiries as to the accuracy of the information. Colliers International excludes unequivocally all inferred or implied terms, conditions and warranties arising out of this document and excludes all liability for loss and damages arising therefrom. Colliers International is a worldwide affiliation of independently owned and operated companies.

TED CUTHBERT
858 636 7988
ted.cuthbert@colliers.com
Lic# 00964042

5901 Priestly Drive, Suite 100
Carlsbad, CA 92008
www.colliers.com/carlsbad

