



164,840 SF Building located on 13.85 Acres

FOR LEASE

100 W. Sinclair Street | Perris, CA

100 W. Sinclair Street is an excellent manufacturing/distribution facility located in the highly desirable Inland Empire submarket. The site is located 30 miles from Ontario International Airport, is accessible to I-215 via Ramona Expressway. Corporate neighbors include Hanes, Whirlpool, Ross (DC), Wayfair, Lowes, Harbor Freight and Walgreen's. The property includes a 164,840 square-foot manufacturing/distribution facility featuring 10,174 SF two-story office, loading doors on all 4 sides, 27.5' - 32' clear height and power distributed throughout.

Highlights

- Available Space:** 164,840 SF
- Land Area:** ±13.85 Acres
- Ceiling Height:** Min 27.5' - Max 32'
- Sprinkler System:** .40 GPM/2,500 SF
- Loading:** 5 Dock High Doors
23 Ground Level Doors
- Office:** ±10,174 SF of
Two (2) Story Office
- Car Parking:** 320 spaces
Secured Parking
- Electrical:** 2000 Amps
Power Distributed
Throughout

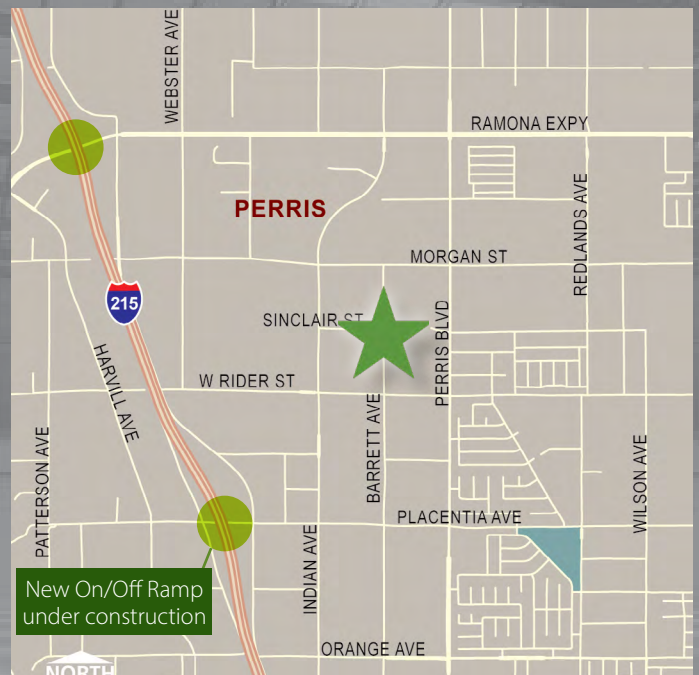

For Lease

100 W. Sinclair Street | Perris, CA

Site Plan

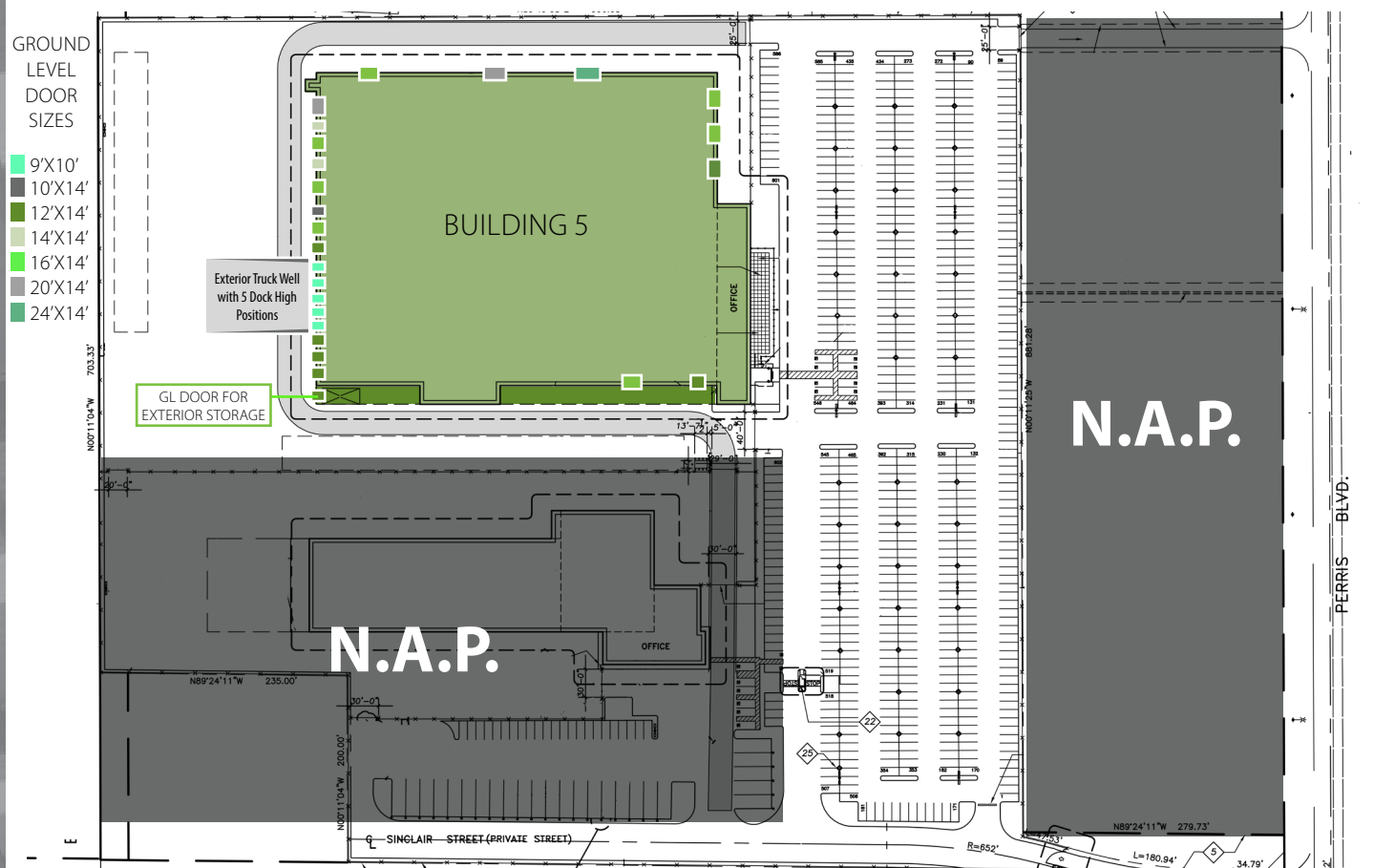

Broker Contact

Milo Lipson
Senior Director
Direct: (909) 942-4648
milo.lipson@cushwake.com

Ryan Velasquez
Senior Director
Direct: (909) 942-4673
ryan.velasquez@cushwake.com



www.cushmanwakefield.com

Owner Contact

Ryan McClean
Market Leader
898 N. Pacific Coast Highway, Suite 175
El Segundo, CA 90245

Direct: (310) 617-3384
rmcclean@firstindustrial.com



www.firstindustrial.com

For Lease

100 W. Sinclair Street | Perris, CA



Milo Lipson
Direct: (909) 942-4648
milo.lipson@cushwake.com

Ryan Velasquez
Direct: (909) 942-4673
ryan.velasquez@cushwake.com

