

FOR LEASE

1626 FRONTAGE RD

± 16,000 SF Industrial Distribution Space
Lease Rate Undisclosed



EXCLUSIVELY LISTED BY

JACOB CASTRO
jacob.castro@ip-cre.com
714.300.3005
Lic. #02128663

SAM SUKUT
sam.sukut@ip-cre.com
619.535.1269
Lic. #02030355

CHRIS NELSON
chris.nelson@ip-cre.com
619.356.1223
Lic. #02055962

INLAND PACIFIC

PROPERTY HIGHLIGHTS



1626 FRONTAGE RD
CHULA VISTA, CA 91911



TOTAL SF: ± 36,000
RSF: ± 16,000 SF



1 STORY BUILDING



ZONING M-52,
CHULA VISTA



1 ACRE LOT



25 PARKING SPACES



22' CLEAR HEIGHT



CONSTRUCTION:
MASONRY



4 EXTERIOR DOCK
HIGH DOORS



1 GRADE LEVEL DOOR



± 1,800 SF
BONUS STORAGE MEZ



EASY ACCESS TO
I-5 FREEWAY

Information herein has been obtained from sources deemed reliable, however its accuracy cannot be guaranteed. The user is required to conduct their own due diligence and verification.

FLOOR PLAN

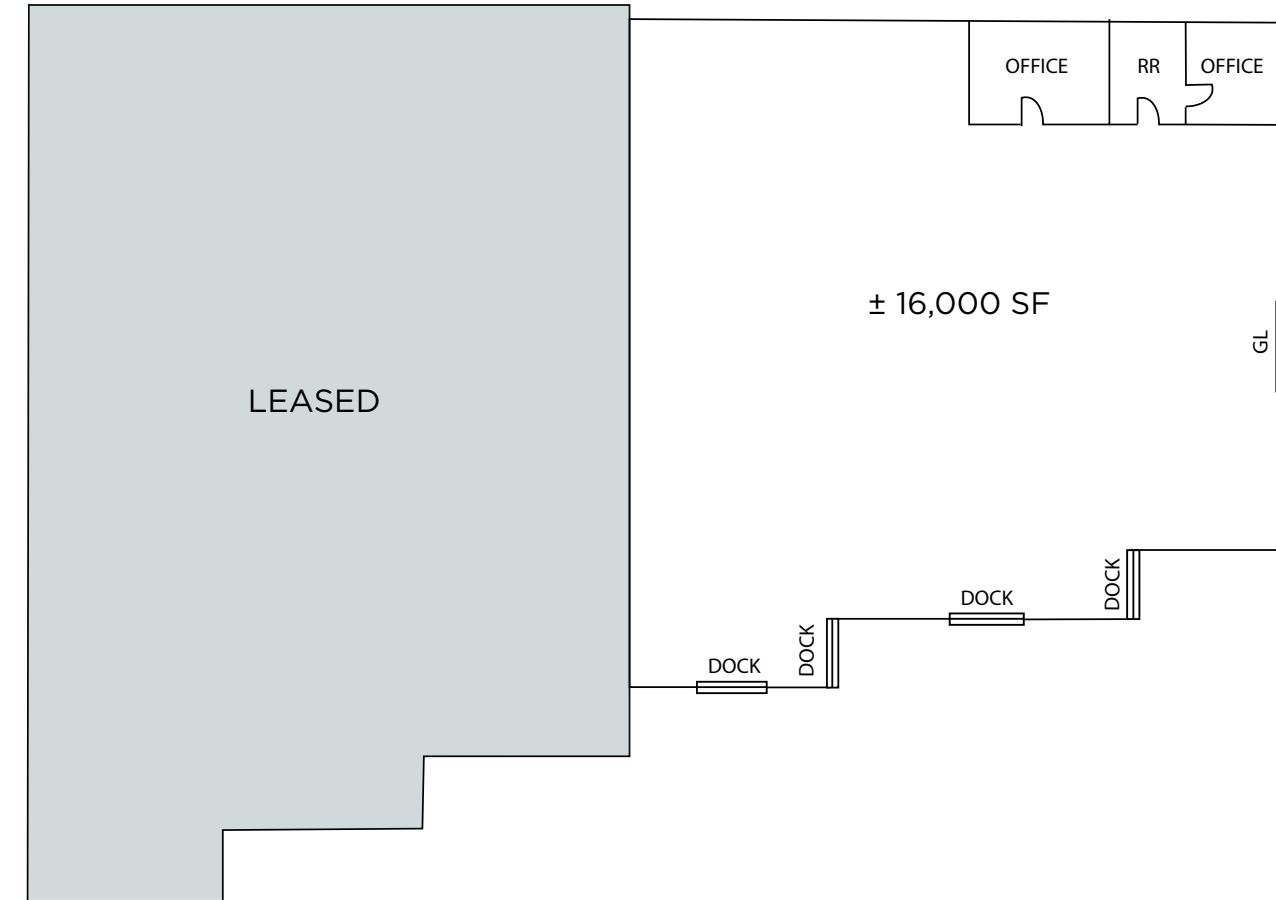

Information herein has been obtained from sources deemed reliable, however its accuracy cannot be guaranteed. The user is required to conduct their own due diligence and verification.

INTERIOR/ LOADING BUILDOUT



AMENITY MAP

- Starbucks
- IHOP
- Applebee's
- Carl's Jr
- WaBa Grill
- Target
- Costco
- Walmart
- CVS
- UPS
- Michaels
- Arco
- 7-Eleven
- Bank of America
- Wells Fargo



1626
FRONTAGE RD

CORPORATE NEIGHBORS



FOR MORE INFORMATION PLEASE CONTACT

JACOB CASTRO
jacob.castro@ip-cre.com
714.300.3005
Lic. #02128663

SAM SUKUT
sam.sukut@ip-cre.com
619.535.1269
Lic. #02030355

CHRIS NELSON
chris.nelson@ip-cre.com
619.356.1223
Lic. #02055962

