

2055

DUBLIN DRIVE

OTAY MESA, CA

136,350 SF INDUSTRIAL SPACE
Single or Multi-Tenant Options Available

8,000 amps of Power

AVAILABLE FOR LEASE



ANDY IRWIN

+1 858 410 6376

andy.irwin@jll.com

RE lic. # 01302674

JOE ANDERSON

+1 858 410 6360

joe.anderson@jll.com

RE lic. #01509782



Jones Lang LaSalle Brokerage, Inc.
RE License #01856260

SINGLE TENANT FLOOR PLAN

AVAILABLE 02/01/2024



136,350 SF
AVAILABLE SIZE



16
DOCK HIGH DOORS



1
GRADE LEVEL DOOR



28'
CLEAR HEIGHT



**CALL BROKER FOR RENTAL RATE
BELOW MARKET NNN'S = \$0.184**

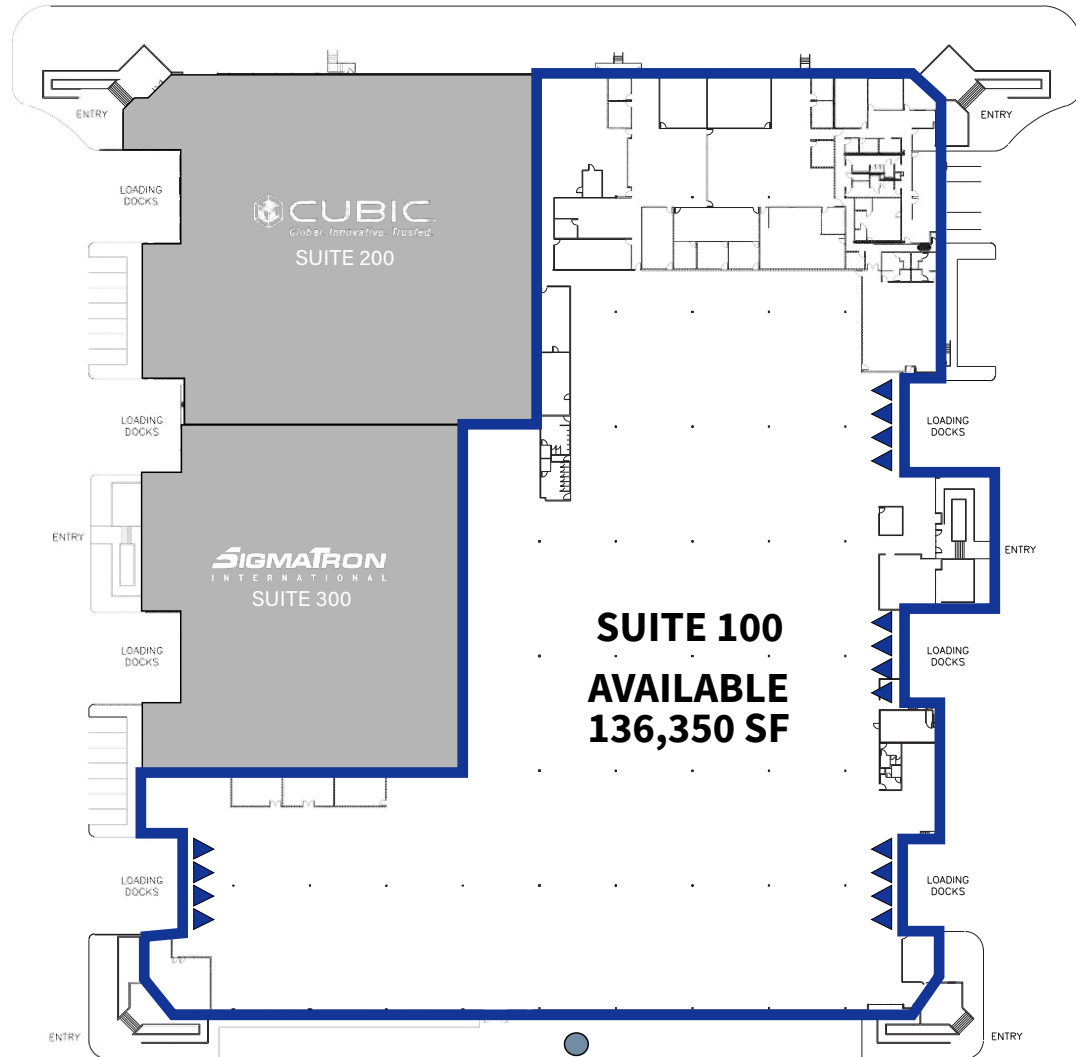

▲ GRADE DOOR
● DOCK DOOR

MULTI TENANT FLOOR PLAN

AVAILABLE 02/01/2024



25,000 - 136,350 SF
AVAILABLE SIZES



16
DOCK HIGH DOORS



1
GRADE LEVEL DOOR



28'
CLEAR HEIGHT



CALL BROKER FOR RENTAL RATE
BELOW MARKET NNN'S = \$0.184

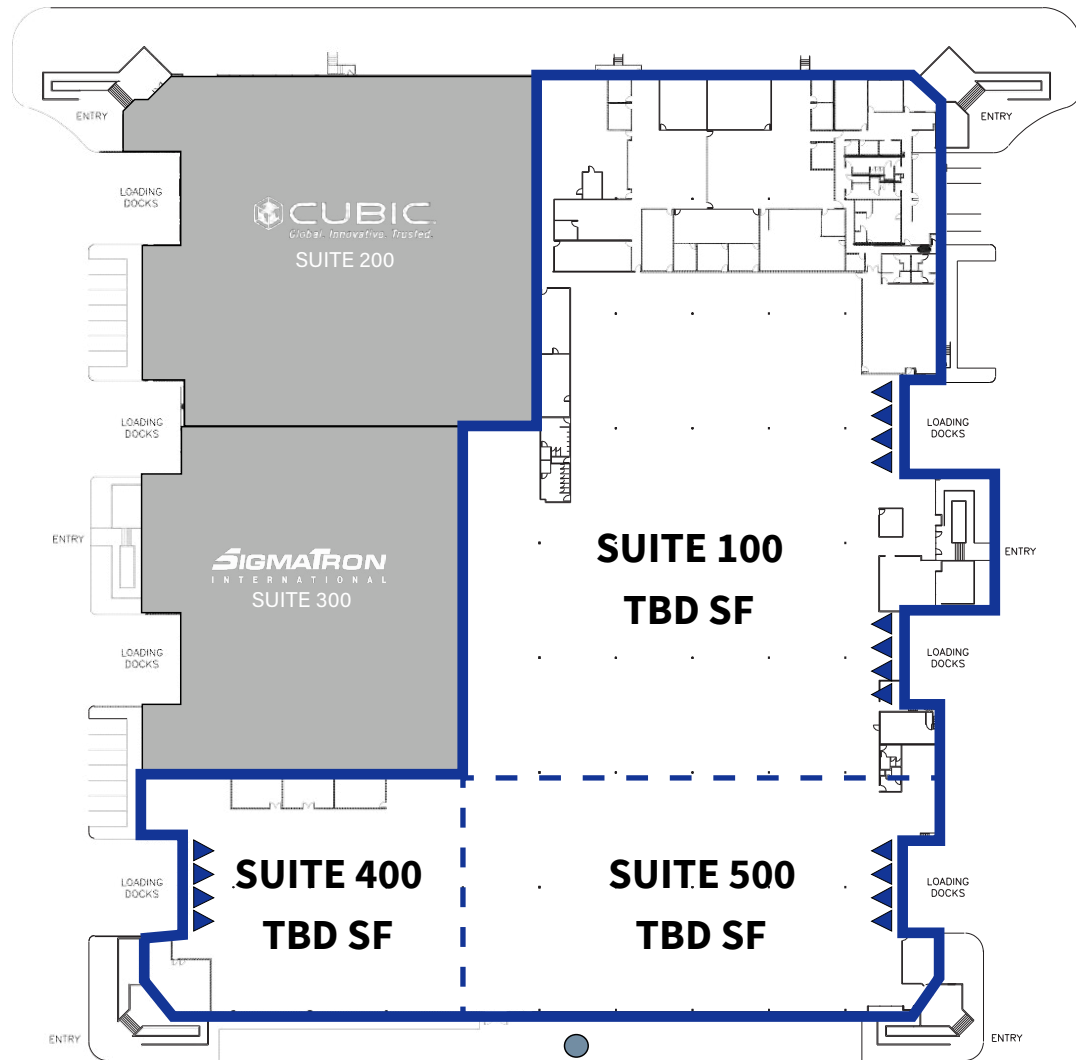

- ▲ GRADE DOOR
- DOCK DOOR
- - - POTENTIAL DEMISING WALL

SITE PLAN



205,800 SF
TOTAL BUILDING SIZE



ESFR
SPRINKLERS



HEAVY POWER
8,000 amps 277/480, 3 phase



2.0:1,000
PARKING



FOREIGN TRADE ZONE
LOCATION

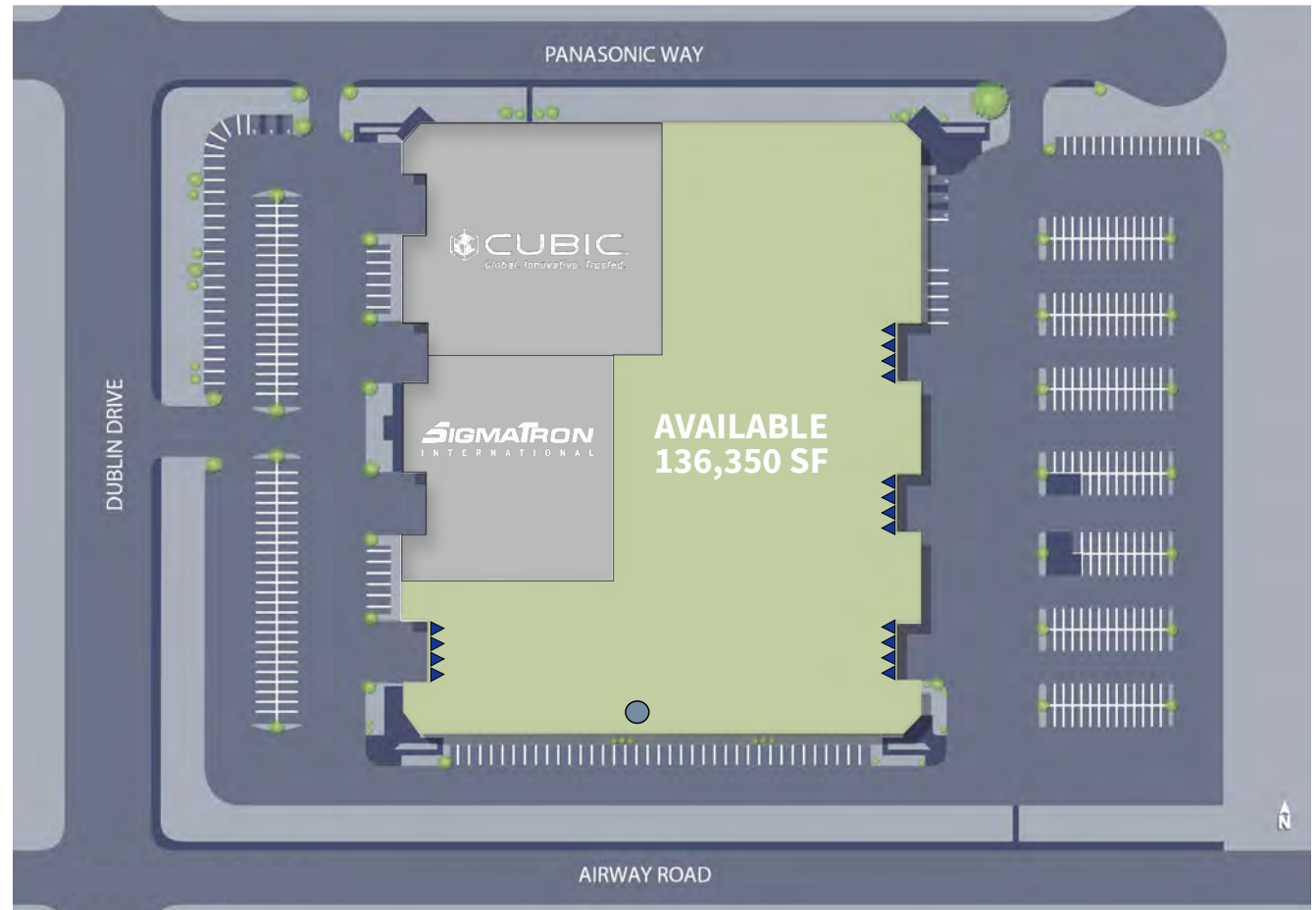

▲ DOCK DOOR
● DOCK DOOR



2055
DUBLIN
DRIVE
 OTAY MESA, CA

ANDY IRWIN
 +1 858 410 6376
 andy.irwin@jll.com
 RE lic. # 01302674

JOE ANDERSON
 +1 858 410 6360
 joe.anderson@jll.com
 RE lic. #01509782



Although information has been obtained from sources deemed reliable, neither Owner nor JLL makes any guarantees, warranties or representations, express or implied, as to the completeness or accuracy as to the information contained herein. Any projections, opinions, assumptions or estimates used are for example only. There may be differences between projected and actual results, and those differences may be material. The Property may be withdrawn without notice. Neither Owner nor JLL accepts any liability for any loss or damage suffered by any party resulting from reliance on this information. If the recipient of this information has signed a confidentiality agreement regarding this matter, this information is subject to the terms of that agreement. ©2023. Jones Lang LaSalle IP, Inc. All rights reserved.