



**SANYO  
LOGISTICS  
CENTER**

**2-BUILDING INDUSTRIAL CENTER IN OTAY MESA**

TOTALING 242,969 SF | DIVISIBLE TO 25,995 SF

DELIVERY Q4 2023



**SANYO LOGISTICS CENTER**

**FOR LEASE**

**CHRIS HOLDER, SIOR**

Executive Vice President

License No. 00894854

+1 619 871 9028

chris.holder@colliers.com

**MARK LEWKOWITZ, SIOR**

Executive Vice President

License No. 01785338

+1 858 922 8988

mark.lewkowitz@colliers.com

**WILL HOLDER**

Associate Vice President

License No. 02034306

+1 619 964 1307

will.holder@colliers.com



**BADIEE  
DEVELOPMENT**

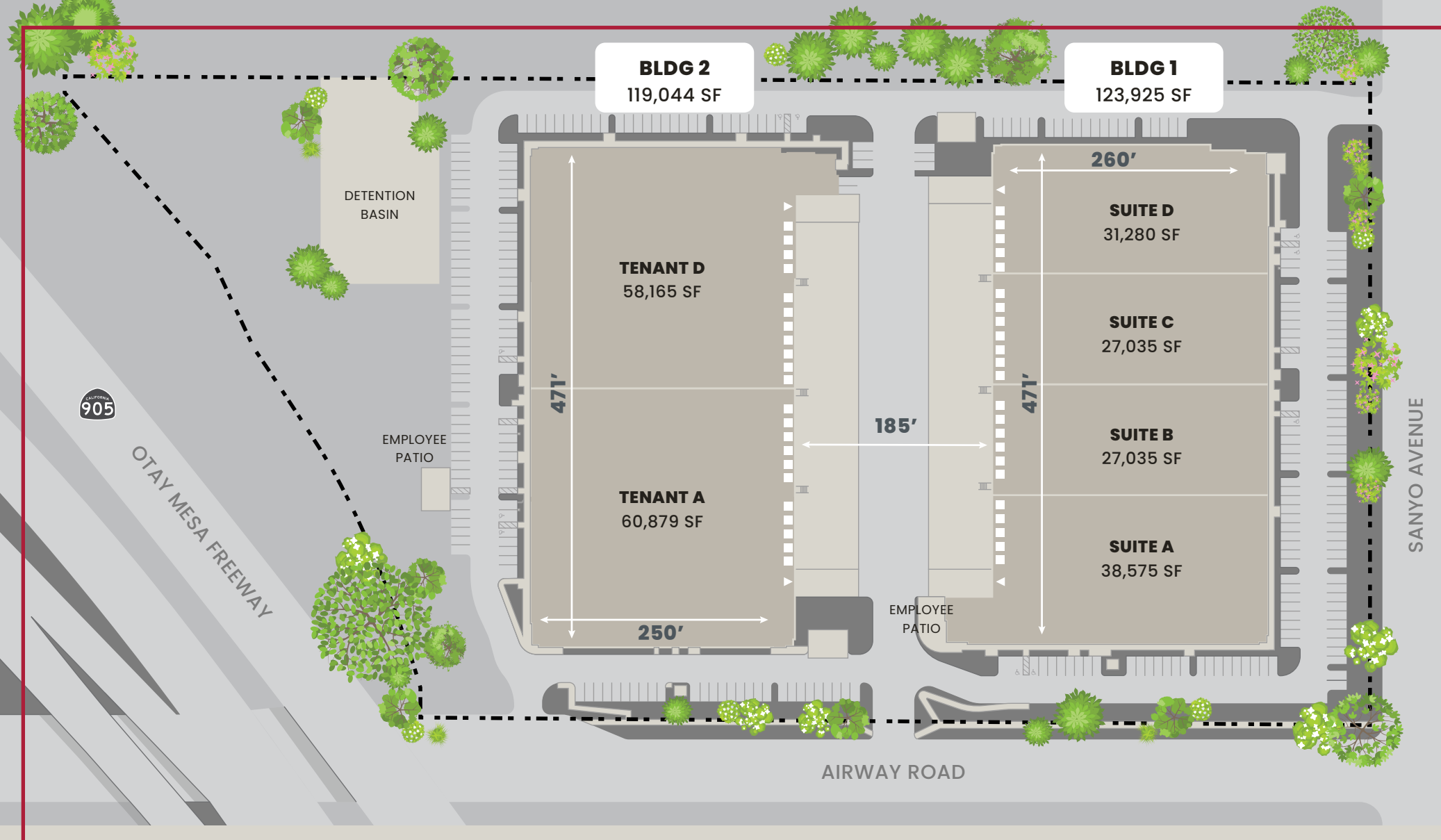

- Class A Corporate Facility
- Best Access in Otay Mesa
- Freeway Frontage Signage

- Superior Dock Loading
- No Mezzanine, Maximum Warehouse Area

- Directly off SR 905 and Otay Mesa Road

## BUILDING 1 FLOORPLAN 2080 SANYO AVENUE

- 123,925 Square Feet
- Divisible to 27,035 SF
- Dock Positions: 23
- Grade-Level Doors: 2
- Clear Height: 32'
- Typical Bay - 52' x 60'
- 60' Speed Bays
- Parking Ratio 1.1/1,000 SF
- Spec Office: 2,463 SF
- ESFR Sprinklers
- Electrical Service: 3,000 Amps  
277/480v, 3 Phase
- All Concrete Truck Court

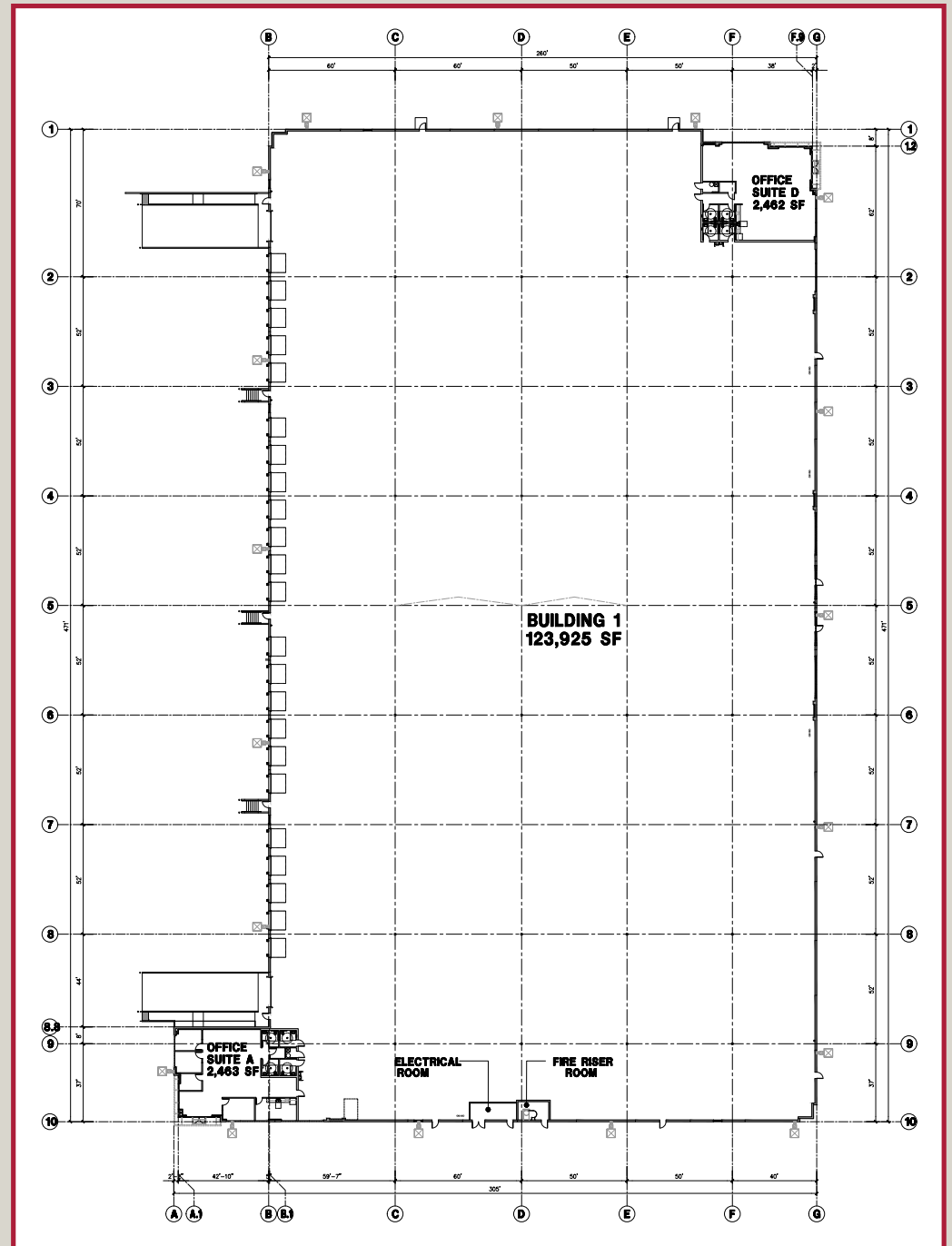

## BUILDING 2 FLOORPLAN 7133 AIRWAY ROAD

- 119,044 Square Feet
- Divisible to 25,995 SF
- Dock Positions: 22
- Grade-Level Doors: 2
- Clear Height: 32'
- Typical Bay - 52' x 60'
- 60' Speed Bays
- Parking Ratio: 1.2/1,000 SF
- Spec Office: 2,460 SF
- ESFR Sprinklers
- Electrical Service: 3,000 Amps  
277/480v, 3 Phase
- All Concrete Truck Court

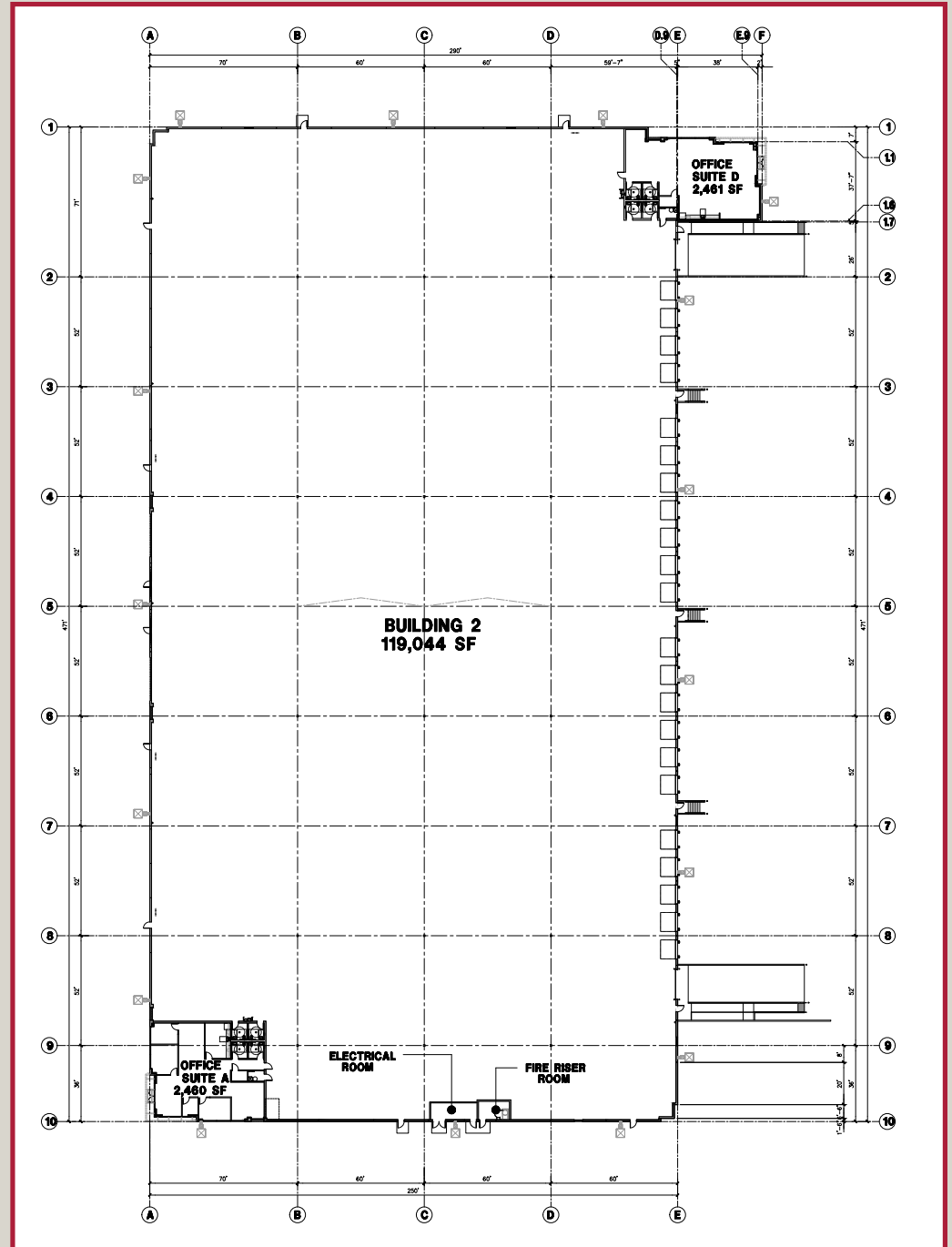

# PACIFIC OCEAN

**BOSE**

**CUBIC** **TOYOTA**  
Global. Innovative. Trusted.

**GENERAL DYNAMICS** **Chosen**  
FOODS

**KraftHeinz** **MANFREIGHT**

**SHARP**



**MAD**  
ENGINE  
GLOBAL

**IRON MOUNTAIN**

**Honeywell**

**Solar Turbines**

A Caterpillar Company

**Raytheon**

UTC Aerospace Systems

plantronics

**Chipman**  
Relocation & Logistics

**ZEBRA**

**W** WHALEN

**STERIS**

Expeditors

**Mor**  
EQUIPMENT FOR TRUCKS

**Pilot**

**BROWN  
FIELD  
AIRPORT**



**SANYO LOGISTICS  
CENTER**

**SANYO AVE**

**OTAY MESA  
PORT OF ENTRY**



**amazon**

**FedEx** **CHP**

**BD** **COSTCO**  
WHOLESALE

**Panasonic**

**FUTURE SITE OF  
OTAY MESA EAST  
PORT OF ENTRY**

**NORTH**

# CORPORATE NEIGHBORS & ACCESSIBILITY

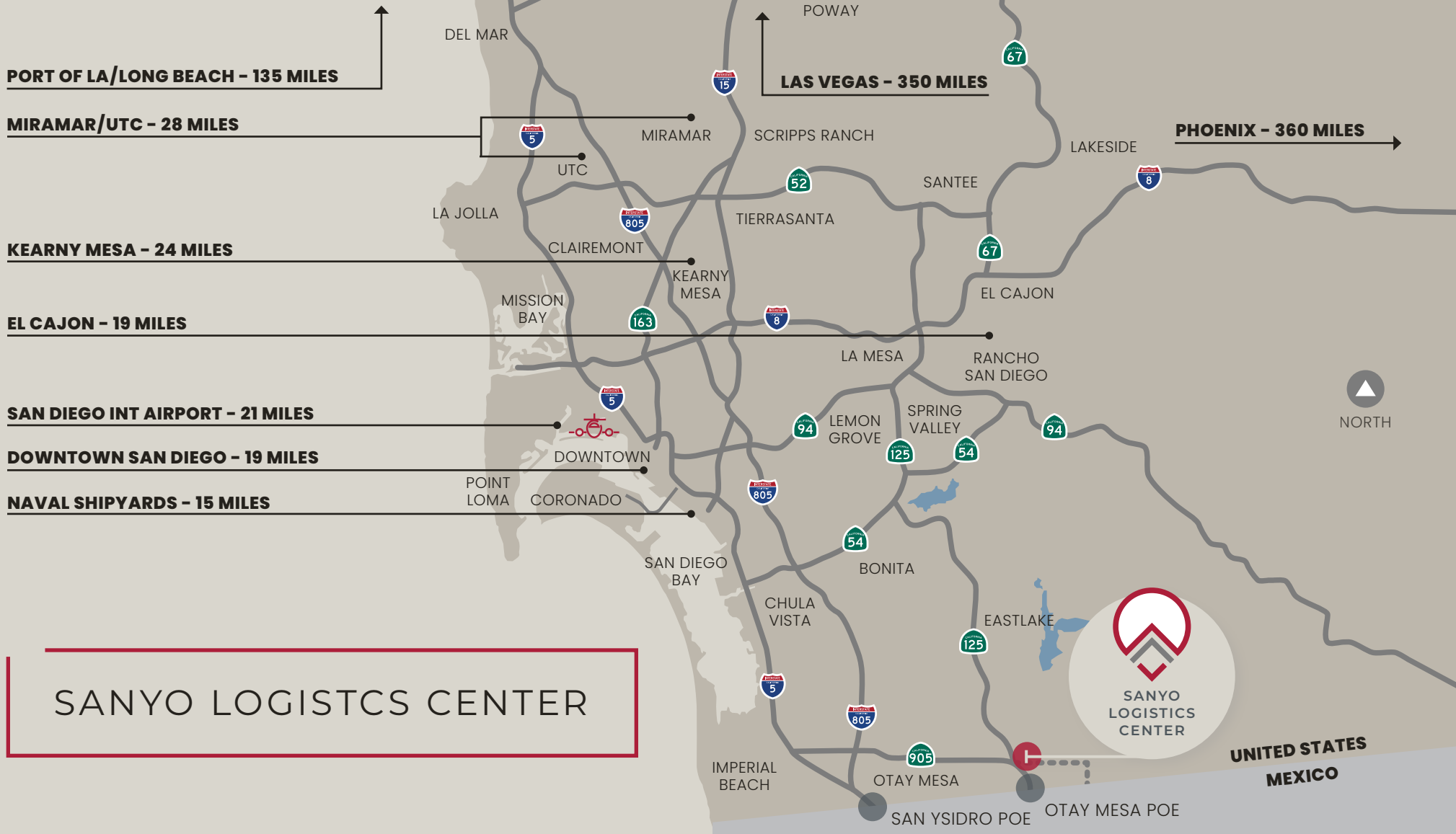

# SANYO LOGISTICS CENTER

FOR LEASE | 2-BUILDING INDUSTRIAL CENTER IN OTAY MESA  
 242,969 SF TOTAL | 2080 SANYO AVENUE & 7133 AIRWAY ROAD, SAN DIEGO, CA 92154

## CONTACT

**CHRIS HOLDER, SIOR**

Executive Vice President  
 License No. 00894854  
 +1 619 871 9028  
 chris.holder@colliers.com

**MARK LEWKOWITZ, SIOR**

Executive Vice President  
 License No. 01785338  
 +1 858 922 8988  
 mark.lewkowitz@colliers.com

**WILL HOLDER**

Associate Vice President  
 License No. 02034306  
 +1 619 964 1307  
 will.holder@colliers.com

