

±23,765 SF AVAILABLE FOR LEASE
730 DESIGN COURT, CHULA VISTA, CA 91911



MICHAEL MOSSMER, SIOR
Senior Vice President/Partner
Lic. #00998326 | 858.458.3347
mmossmer@voitco.com

PATRICK CONNORS
Vice President/Partner
Lic. #02009924 | 858.458.3359
pconnors@voitco.com

Voit
REAL ESTATE SERVICES

PROPERTY DESCRIPTION

ADDRESS 730 Design Court, Chula Vista, CA 91911

SUITE AVAILABLE 405

SF OFFICES \pm 2,500 SF

YEAR BUILT 1987

DOORS 3 Dock Platforms/1 Grade

ZONING I-General Industrial

CLEAR HEIGHT 22'-24'

PARKING 2.50/1,000 SF

YARD Small area for outside storage

RACKING Existing racking potentially available

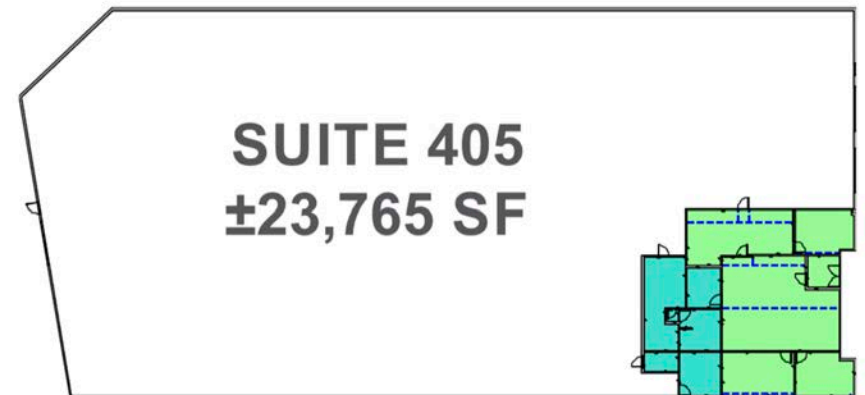

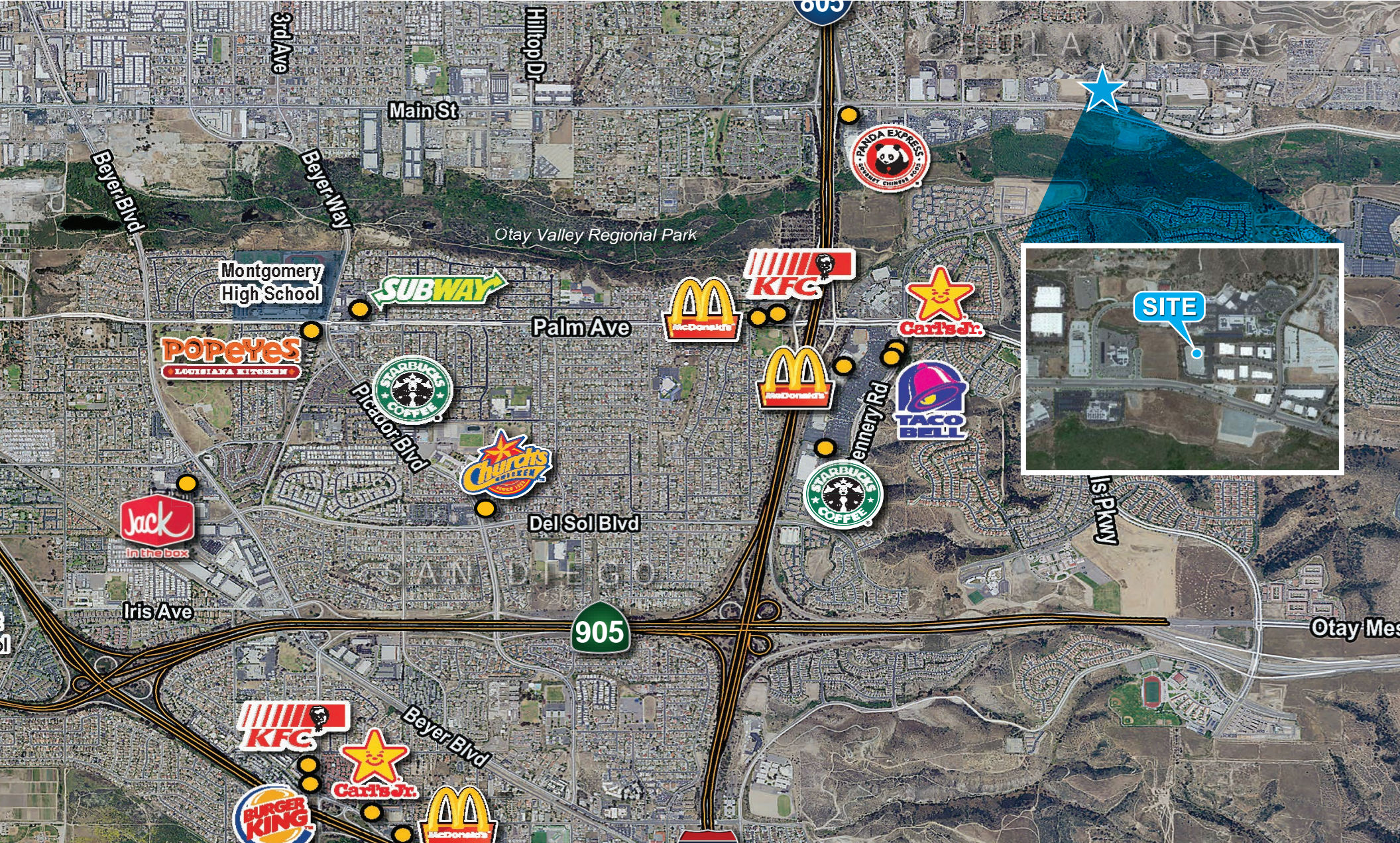

MICHAEL MOSSMER, SIOR
 Senior Vice President/Partner
 Lic. #00998326 | 858.458.3347
mmossmer@voitco.com

PATRICK CONNORS
 Vice President/Partner
 Lic. #02009924 | 858.458.3359
pconnors@voitco.com

4180 La Jolla Village Drive, Suite 100, La Jolla, CA 92037 | 858.453.0505 | 858.408.3976 Fax | Lic #01991785 | www.voidco.com

Licensed as Real Estate Salespersons by the DRE. The information contained herein has been obtained from sources we deem reliable. While we have no reason to doubt its accuracy, we do not guarantee it. ©2022 Voit Real Estate Services, Inc. All Rights Reserved.

Voit
 REAL ESTATE SERVICES