



9575 AERO DRIVE

±48,635 SF Freestanding Industrial / Flex Building

For Sale or Lease

Centrally located in Kearny
Mesa & recently renovated
with a huge fenced yard

For more information contact

MICKEY MORERA

858.369.3030

mickey.morera@kidder.com

LIC N° 00950071

JAMES DUNCAN

858.369.3015

james.duncan@kidder.com

LIC N° 01253770

**Kidder
Mathews**



FOR SALE OR LEASE

±48,635 SF Freestanding Industrial / Flex Building

9575 AERO DRIVE, KEARNY MESA / SAN DIEGO, CA 92123

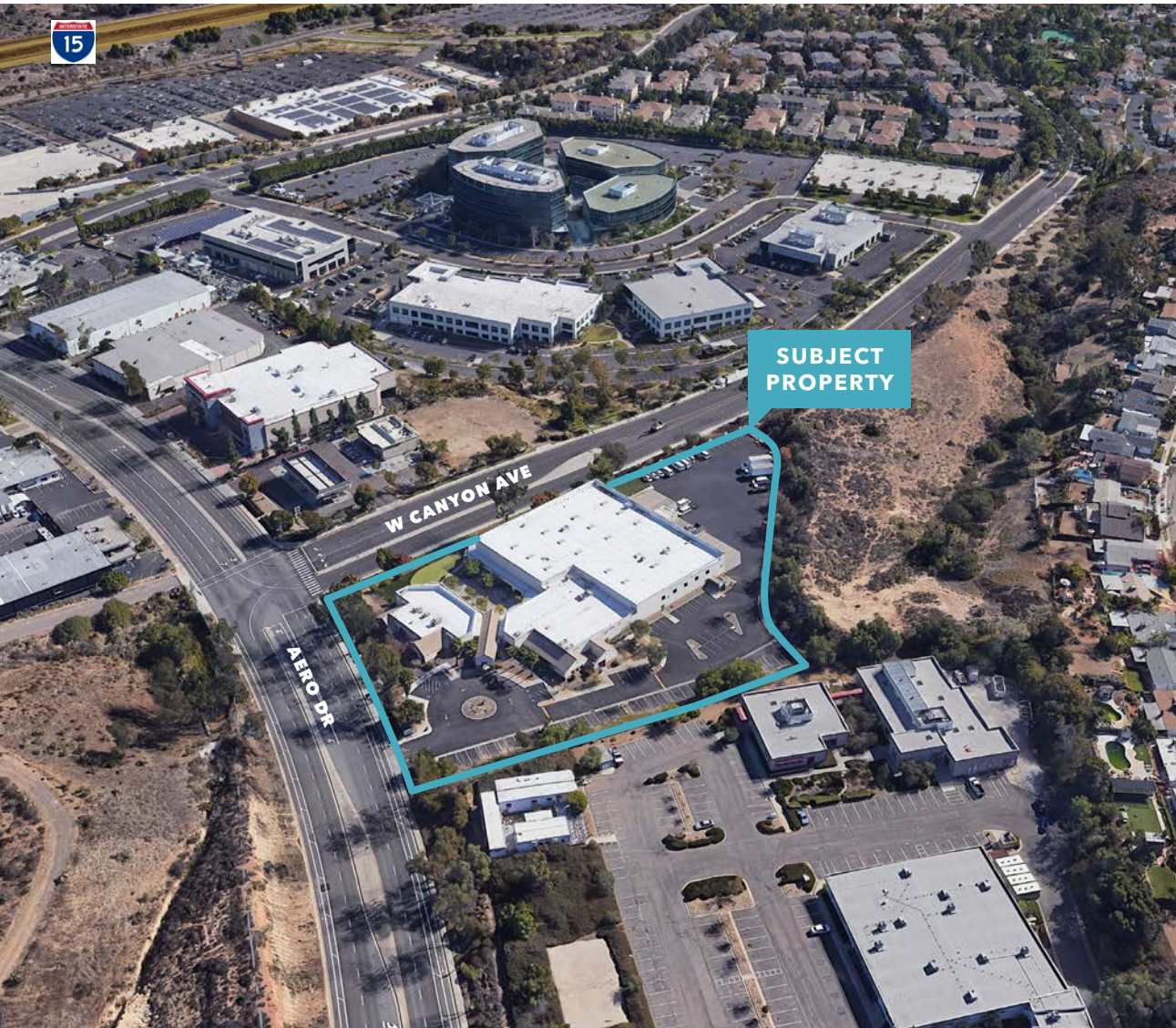

PROPERTY FEATURES

| | |
|-----------------------|--|
| Improvements | 30% office area 70% R&D / warehouse with bonus ±7,000 SF mezzanine storage area |
| Amenities | Cafeteria, large courtyard, multiple patios, putting green, bocce ball court, and outdoor fitness area |
| Clear Height | Minimum 18 Feet in Warehouse |
| Truck Loading Doors | 2 Dock High Doors & 2 Drive-In Doors |
| Parking | Approx. 85 Spaces (expandable) |
| Public Transportation | MTS bus stop located directly in front of the property |
| Showers | Men's and Women's facilities on-site |
| Zoning | IP-2-1 |
| Year Constructed | 1992 |
| Fenced Yard | Fully secured fenced yard & loading area |
| Land Area | Approx. 4.51 Gross Acres |
| Roof | Newer energy efficient TPO roof over warehouse still under warranty |
| Fire Suppression | Fully Sprinklered, 0.16 GPM / 1,500 SF |
| Natural Gas | Natural gas service in place |
| Electric Service | 2500 amps, 120 / 208 Volts |
| Solar System | Newly installed 97.96 KW rooftop solar system providing reduced energy costs |
| Asking Lease Rate | \$1.95 / SF NNN |
| Sale Price | Make Offer |

KIDDER.COM

This information supplied herein is from sources we deem reliable. It is provided without any representation, warranty, or guarantee, expressed or implied as to its accuracy. Prospective Buyer or Tenant should conduct an independent investigation and verification of all matters deemed to be material, including, but not limited to, statements of income and expenses. Consult your attorney, accountant, or other professional advisor.



FOR SALE OR LEASE

±48,635 SF Freestanding Industrial / Flex Building

9575 AERO DRIVE, KEARNY MESA / SAN DIEGO, CA 92123

Floor Plan

INTERIOR FEATURES

Multiple patios, restrooms / showers, office space area, a cafeteria, high bay warehouse with a bonus ±7,000 SF mezzanine storage area, two grade level doors & two dock high doors. Exterior amenities include an outdoor fitness area, a bocce ball court, golf putting green & a courtyard.

G Grade Level Door

D Dock High Door

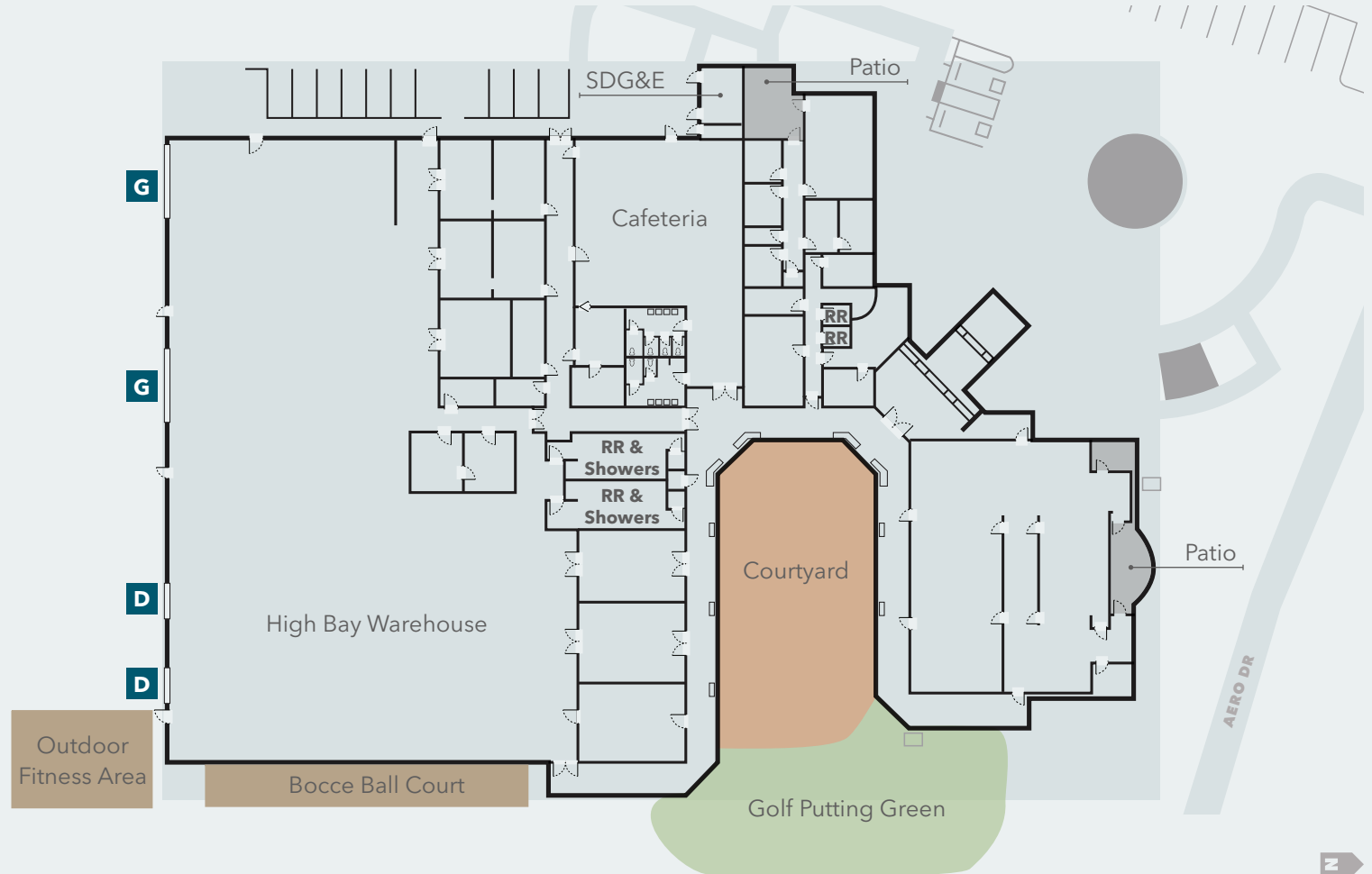

KIDDER.COM

This information supplied herein is from sources we deem reliable. It is provided without any representation, warranty, or guarantee, expressed or implied as to its accuracy. Prospective Buyer or Tenant should conduct an independent investigation and verification of all matters deemed to be material, including, but not limited to, statements of income and expenses. Consult your attorney, accountant, or other professional advisor.

km Kidder Mathews

FOR SALE OR LEASE

±48,635 SF Freestanding Industrial / Flex Building

9575 AERO DRIVE, KEARNY MESA / SAN DIEGO, CA 92123

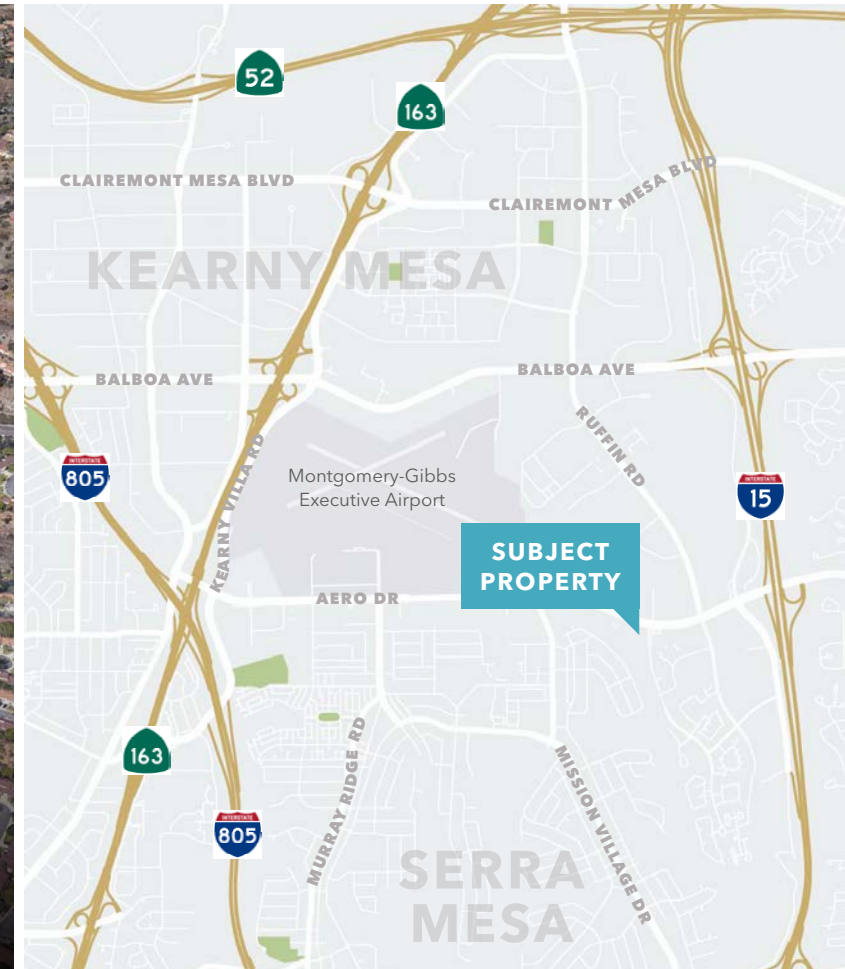
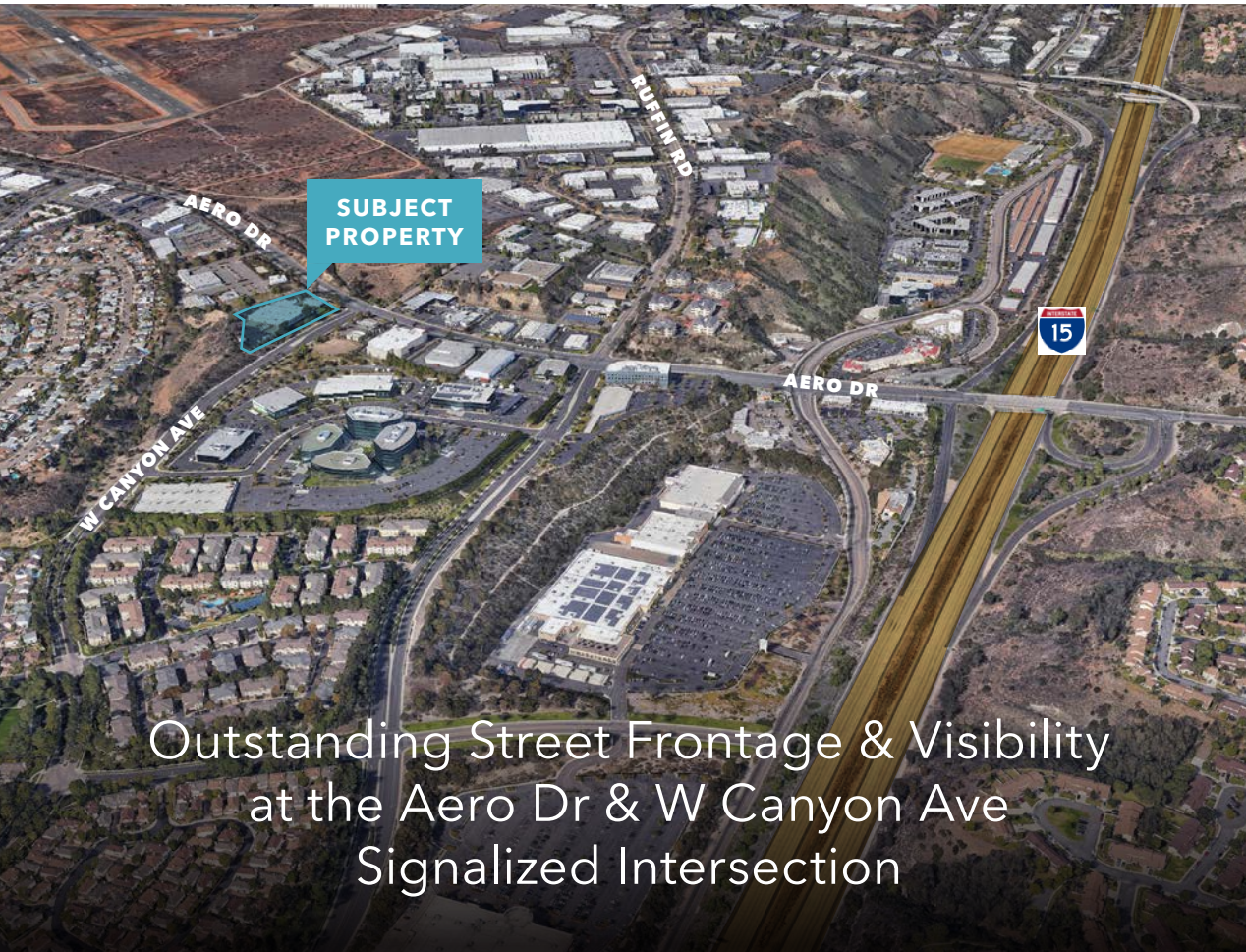

Outstanding Street Frontage & Visibility
at the Aero Dr & W Canyon Ave
Signalized Intersection

For more
information
contact

MICKEY MORERA
858.369.3030
mickey.morera@kidder.com
LIC N° 00950071

JAMES DUNCAN
858.369.3015
james.duncan@kidder.com
LIC N° 01253770

KIDDER.COM

This information supplied herein is from sources we deem reliable. It is provided without any representation, warranty, or guarantee, expressed or implied as to its accuracy. Prospective Buyer or Tenant should conduct an independent investigation and verification of all matters deemed to be material, including, but not limited to, statements of income and expenses. Consult your attorney, accountant, or other professional advisor.



FOR SALE OR LEASE

±48,635 SF Freestanding Industrial / Flex Building

9575 AERO DRIVE, KEARNY MESA / SAN DIEGO, CA 92123

Nearby Amenities



KIDDER.COM

This information supplied herein is from sources we deem reliable. It is provided without any representation, warranty, or guarantee, expressed or implied as to its accuracy. Prospective Buyer or Tenant should conduct an independent investigation and verification of all matters deemed to be material, including, but not limited to, statements of income and expenses. Consult your attorney, accountant, or other professional advisor.

km Kidder Mathews

FOR SALE OR LEASE

±48,635 SF Freestanding Industrial / Flex Building

9575 AERO DRIVE, KEARNY MESA / SAN DIEGO, CA 92123

Nearby Corporations



KIDDER.COM

This information supplied herein is from sources we deem reliable. It is provided without any representation, warranty, or guarantee, expressed or implied as to its accuracy. Prospective Buyer or Tenant should conduct an independent investigation and verification of all matters deemed to be material, including, but not limited to, statements of income and expenses. Consult your attorney, accountant, or other professional advisor.

km Kidder Mathews

FOR SALE OR LEASE

±48,635 SF Freestanding Industrial / Flex Building

9575 AERO DRIVE, KEARNY MESA / SAN DIEGO, CA 92123



KIDDER.COM

This information supplied herein is from sources we deem reliable. It is provided without any representation, warranty, or guarantee, expressed or implied as to its accuracy. Prospective Buyer or Tenant should conduct an independent investigation and verification of all matters deemed to be material, including, but not limited to, statements of income and expenses. Consult your attorney, accountant, or other professional advisor.





9575 AERO DRIVE

For more information contact

MICKEY MORERA

858.369.3030

mickey.morera@kidder.com

LIC N° 00950071

JAMES DUNCAN

858.369.3015

james.duncan@kidder.com

LIC N° 01253770

KIDDER.COM

This information supplied herein is from sources we deem reliable. It is provided without any representation, warranty, or guarantee, expressed or implied as to its accuracy. Prospective Buyer or Tenant should conduct an independent investigation and verification of all matters deemed to be material, including, but not limited to, statements of income and expenses. Consult your attorney, accountant, or other professional advisor.