

FOR LEASE | FROM ±46,858 SF TO ±99,407 SF INDUSTRIAL WAREHOUSE  
WITH ±1 ACRE SECURED YARD

# 1445 | ENGINEER STREET

VISTA, CA 92081



For more information, please contact:

**ARIC STARCK**  
760.431.4211  
aric.starck@cushwake.com  
CA Lic. #01325461

**DENNIS VISSER**  
760.431.4219  
dennis.visser@cushwake.com  
CA Lic. #01255595

1000 Aviara Parkway, Suite 100  
Carlsbad, CA 92011  
P. +1 760 431 4200 F. +1 760 454 3869



# suite specifications

<b>ADDRESS:</b> 1445 Engineer St., Vista Suite A	1445 Engineer St., Vista Suite B	1445 Engineer St., Vista Suite A & B
<b>RBA:</b> ±52,549 SF	±46,858 SF	±99,407 SF
<b>% OFFICE:</b> ±17%	±13%	±15%
<b>YARD AREA:</b> ±.25 acre secured yard	±.75 acre secured yard	±1.0 acre secured yard
<b>LOADING DOORS:</b> 2 dock positions 1 grade level	5 dock positions 4 grade level	7 dock positions 5 grade level
<b>AVAILABLE:</b> 3/1/2022	7/18/2021	3/1/2022

# building specifications

<b>YEAR BUILT:</b> 1999	<b>POWER:</b> 4,000A 277/480v	<b>FIRE SPRINKLERS:</b> .33/3,000 GPM
<b>CLEAR HEIGHT:</b> 26' min.	<b>PARKING:</b> 2.0/1,000	<b>CONSTRUCTION:</b> C.T.U

*\*Please do not disturb tenant. Contact broker to schedule tours.*

# site plan

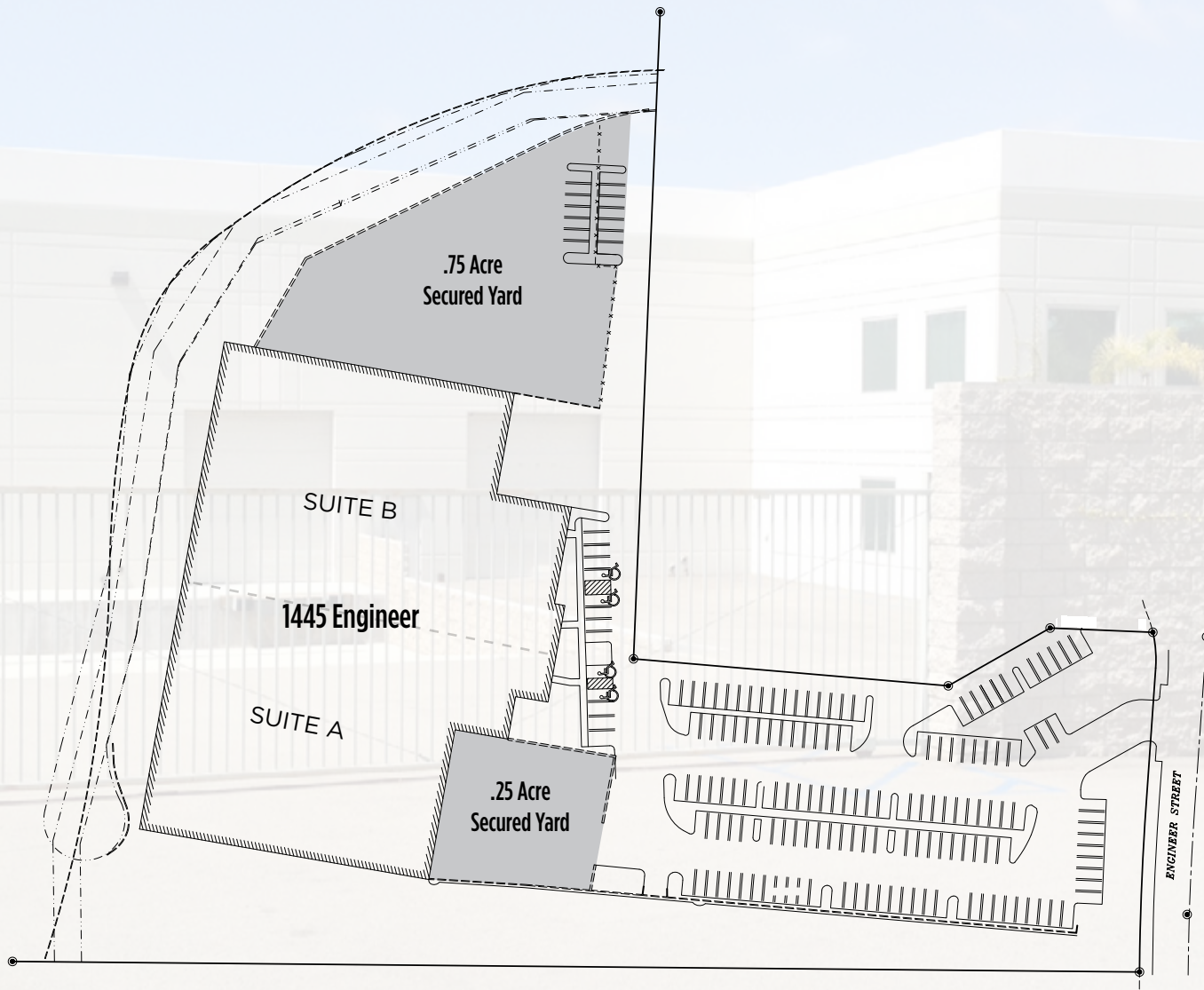

# floor plan

1445 Engineer St., Vista

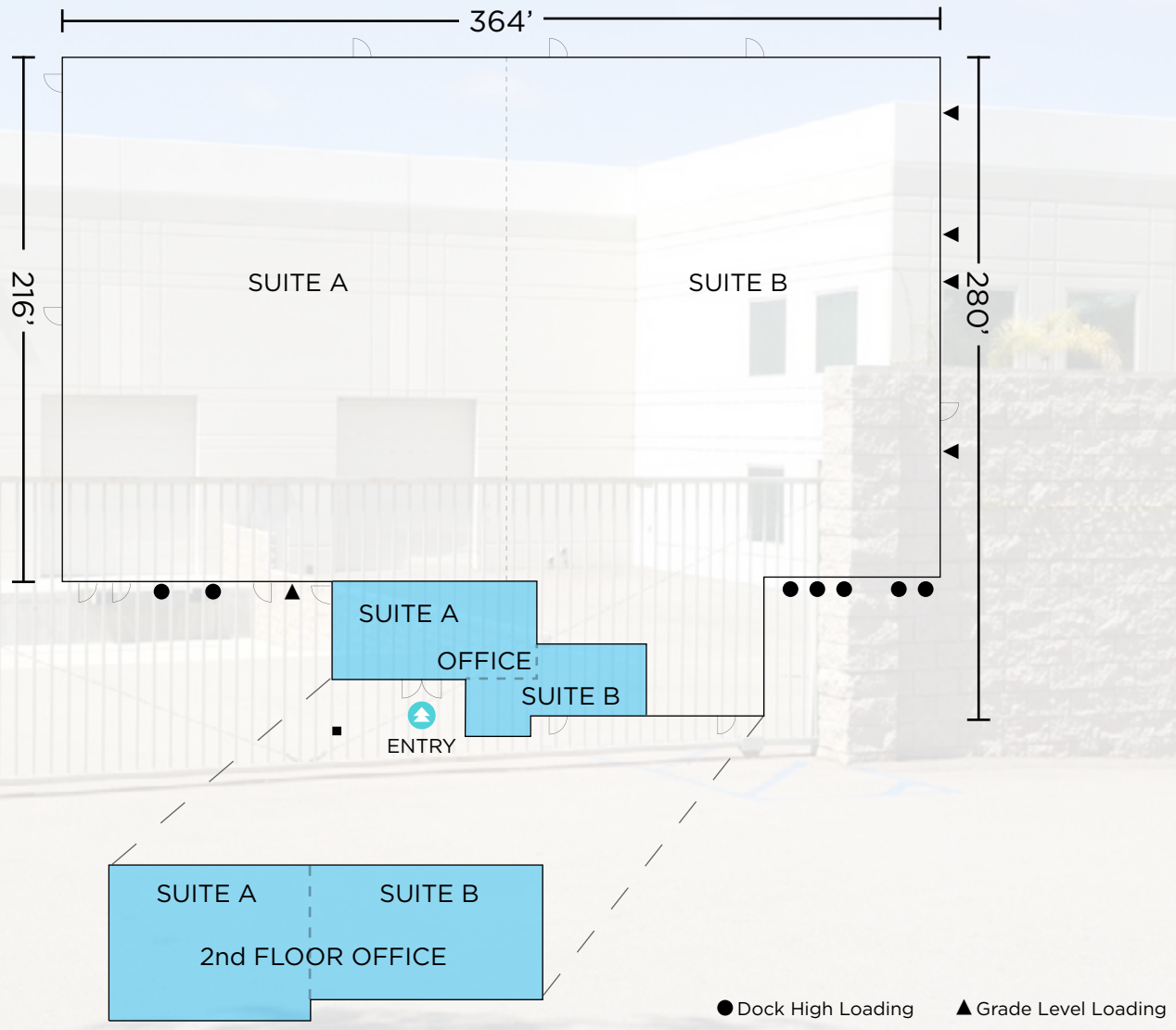

# as-built floor plan

1445 Engineer St., Vista

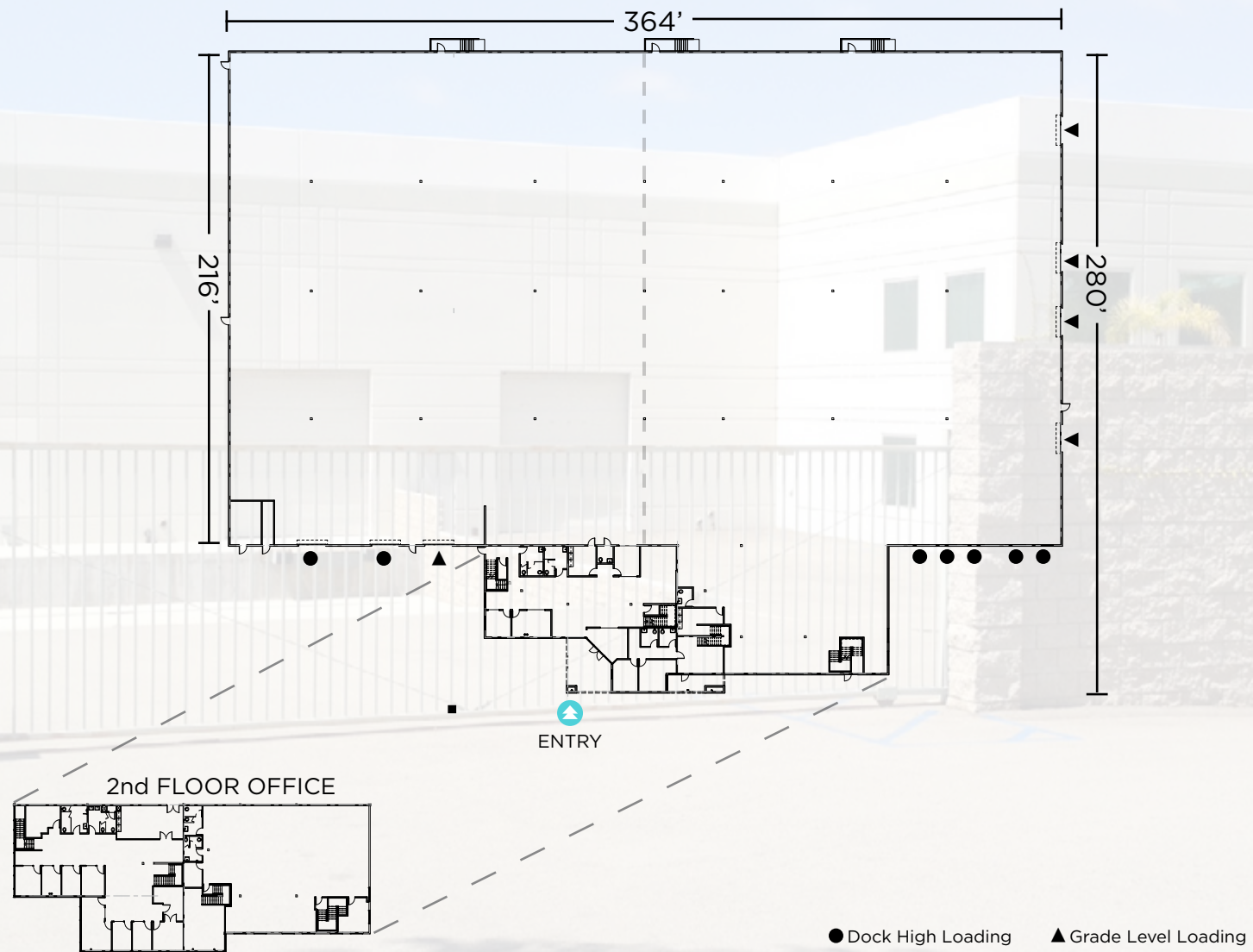

# gallery



# market aerial

1445  
A B

ENGINEER ST.

ENGINEER ST.

DISTRIBUTION WAY

BUSINESS PARK DR.

SYCAMORE AVE.



FOR LEASE | FROM ±46,858 SF TO ±99,407 SF INDUSTRIAL WAREHOUSE  
WITH ±1 ACRE SECURED YARD

# 1445 | ENGINEER STREET

VISTA, CA 92081

For more information, please contact:



**ARIC STARCK**  
760.431.4211  
aric.starck@cushwake.com  
CA Lic. #01325461

**DENNIS VISSER**  
760.431.4219  
dennis.visser@cushwake.com  
CA Lic. #01255595

1000 Aviara Parkway, Suite 100  
Carlsbad, CA 92011  
P. +1 760 431 4200 F. +1 760 454 3869

**VIEW SITE SPECIFIC COVID-19  
PREVENTION PLAN**

©2018 Cushman & Wakefield. All rights reserved. The information contained in this communication is strictly confidential. This information has been obtained from sources believed to be reliable but has not been verified. NO WARRANTY OR REPRESENTATION, EXPRESS OR IMPLIED, IS MADE AS TO THE CONDITION OF THE PROPERTY (OR PROPERTIES) REFERENCED HEREIN OR AS TO THE ACCURACY OR COMPLETENESS OF THE INFORMATION CONTAINED HEREIN, AND SAME IS SUBMITTED SUBJECT TO ERRORS, OMISSIONS, CHANGE OF PRICE, RENTAL OR OTHER CONDITIONS, WITHDRAWAL WITHOUT NOTICE, AND TO ANY SPECIAL LISTING CONDITIONS IMPOSED BY THE PROPERTY OWNER(S). ANY PROJECTIONS, OPINIONS OR ESTIMATES ARE SUBJECT TO UNCERTAINTY AND DO NOT SIGNIFY CURRENT OR FUTURE PROPERTY PERFORMANCE.