

FOR LEASE

Owned by  LINK

NorthPointe

6197 & 6215 El Camino Real Carlsbad, CA

63,600 - 135,300 sqft

Freestanding cGMP
Manufacturing Facilities



LEASING INFO
& CONTACT

Aric Starck
Brian Starck

+1 (760) 431-4211 / aric.starck@cushwake.com
+1 (858) 546-5486 / brian.starck@cushwake.com

 CUSHMAN &
WAKEFIELD





Address:	6215 El Camino Real
Size:	63,600 SF (7,900 SF of Mezzanine)
Dock:	1 Dock-High Door
Grade:	2 Grade-Level Doors
Clear Height:	24'
Power:	3,000 AMP
Parking Ratio:	3.3/1,000
HVAC:	100% Improved



Address:	6197 El Camino Real
Size:	63,833 SF (16,600 SF of Mezzanine)
Dock:	2 Dock-High Door
Grade:	2 Grade-Level Doors
Clear Height:	24'
Power:	3,000 AMP
Parking Ratio:	3.3/1,000
HVAC:	100% Improved

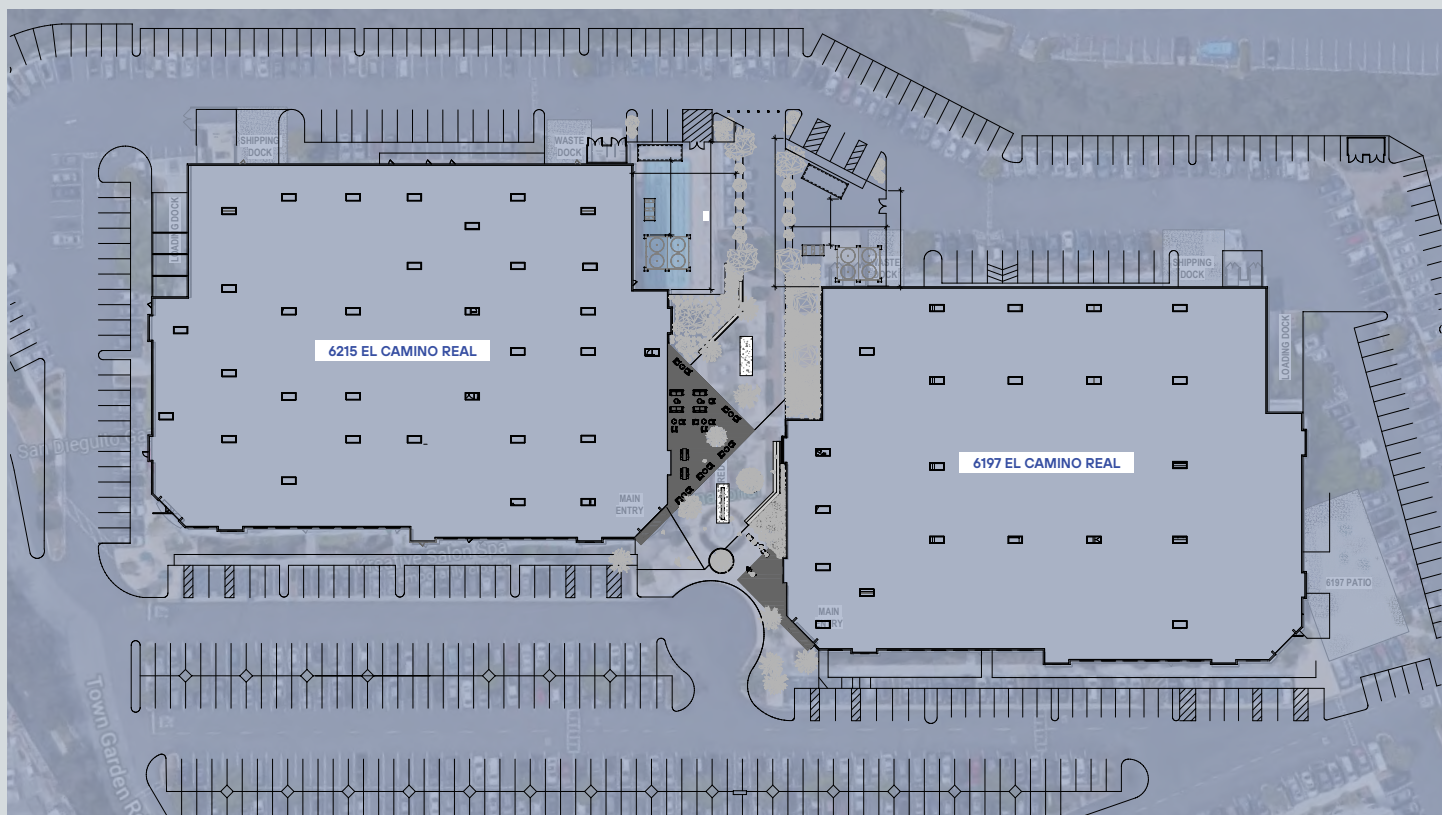

PROJECT HIGHLIGHTS

- Ownership is currently converting the building to a World Class cGMP space.
- The buildings are located amongst a wide range of strong corporate neighbors in the third largest Life Science hub in the nation.
- Walkable Amenities - adjacent retail centers with restaurants, retail shops and services.
- Unsurpassed access and visibility from El Camino Real with a signalized entrance. El Camino Real is North San Diego's major north-to-south thoroughfare.
- 4 minute drive to McClellan Palomar Airport, 10 minute drive to Interstate 5 and an 11 minute drive to the Coast Highway and Beaches.



Address:	6215 El Camino Real
Size:	63,600 SF (7,900 SF of Mezzanine)
Dock:	1 Dock-High Door
Grade:	2 Grade-Level Doors
Clear Height:	24'
Power:	3,000 AMP
Parking Ratio:	3.3/1,000
HVAC:	100% Improved



Address:	6197 El Camino Real
Size:	63,833 SF (16,600 SF of Mezzanine)
Dock:	2 Dock-High Door
Grade:	2 Grade-Level Doors
Clear Height:	24'
Power:	3,000 AMP
Parking Ratio:	3.3/1,000
HVAC:	100% Improved



PROJECT HIGHLIGHTS

- Ownership is currently converting the building to a World Class cGMP space.
- The buildings are located amongst a wide range of strong corporate neighbors in the third largest Life Science hub in the nation.
- Walkable Amenities - adjacent retail centers with restaurants, retail shops and services.
- Unsurpassed access and visibility from El Camino Real with a signalized entrance. El Camino Real is North San Diego's major north-to-south thoroughfare.
- 4 minute drive to McClellan Palomar Airport, 10 minute drive to Interstate 5 and an 11 minute drive to the Coast Highway and Beaches.

6197 EL CAMINO REAL

TOTAL AREA - 71,700 SF

LEVEL 1	APPROX. AREA
Admin.	6,400 SF
Amenities	2,300 SF
Building Services (Restrooms...)	5,300 SF
Circulation	6,900 SF
Laboratory	5,600 SF
Manufacturing	14,300 SF
Warehouse	14,300 SF
LEVEL 1 SUBTOTAL	55,100 SF



LEVEL 2	APPROX. AREA
Admin.	8,500 SF
Building Services (Restrooms...)	8,100 SF
LEVEL 2 SUBTOTAL	16,600 SF

CONCEPTUAL FLOOR PLAN - 6197

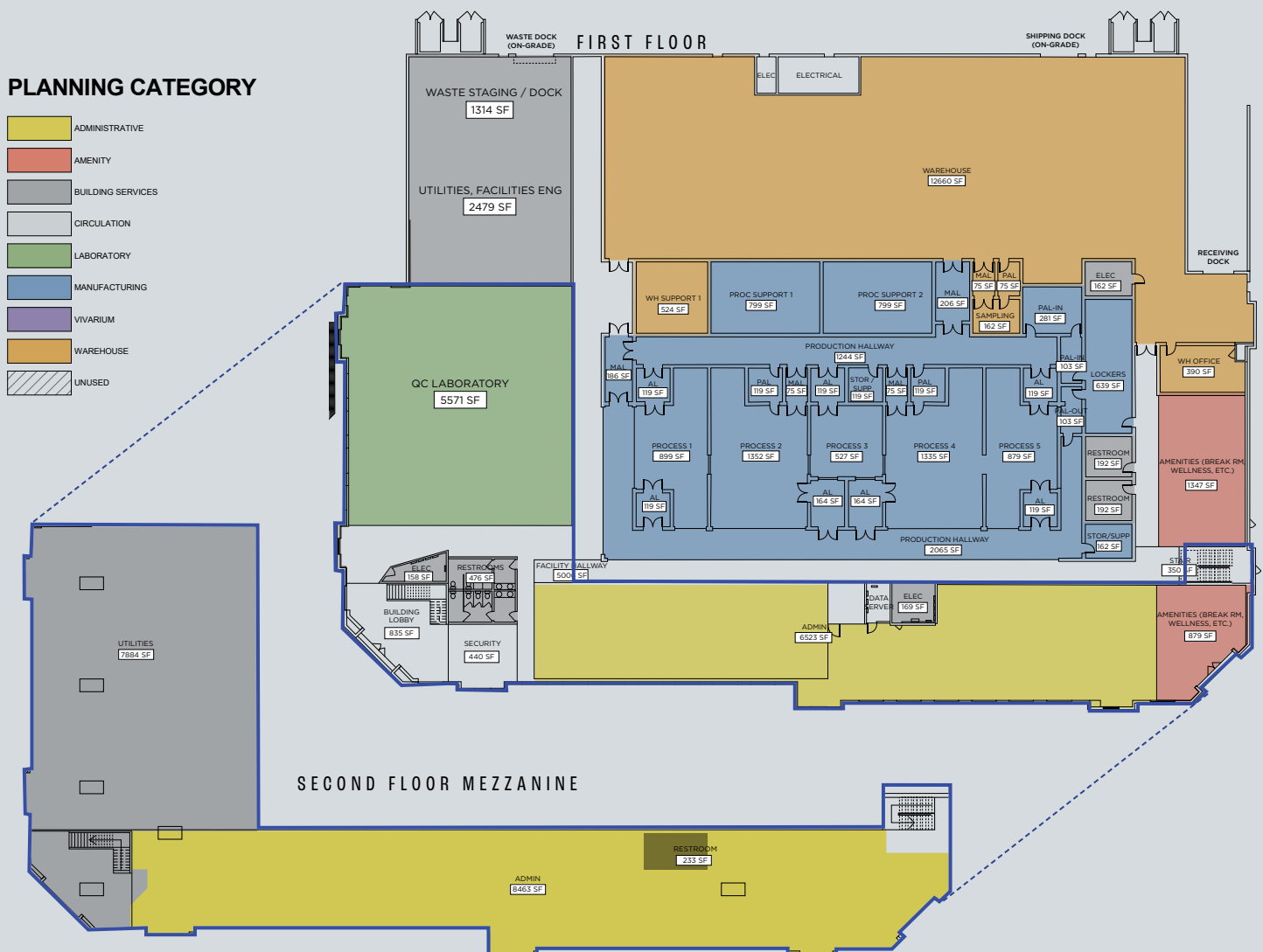



6215 EL CAMINO REAL

TOTAL AREA - 63,600 SF

LEVEL 1	APPROX. AREA
Admin.	9,500 SF
Amenities	2,800 SF
Building Services (Restrooms...)	7,400 SF
Circulation	2,500 SF
Laboratory	6,400 SF
Manufacturing	13,800 SF
Warehouse	13,300 SF
LEVEL 1 SUBTOTAL	55,700 SF

LEVEL 2	APPROX. AREA
Admin.	7,800 SF
Building Services (Restrooms...)	100 SF
LEVEL 2 SUBTOTAL	7,900 SF

CONCEPTUAL FLOOR PLAN - 6215

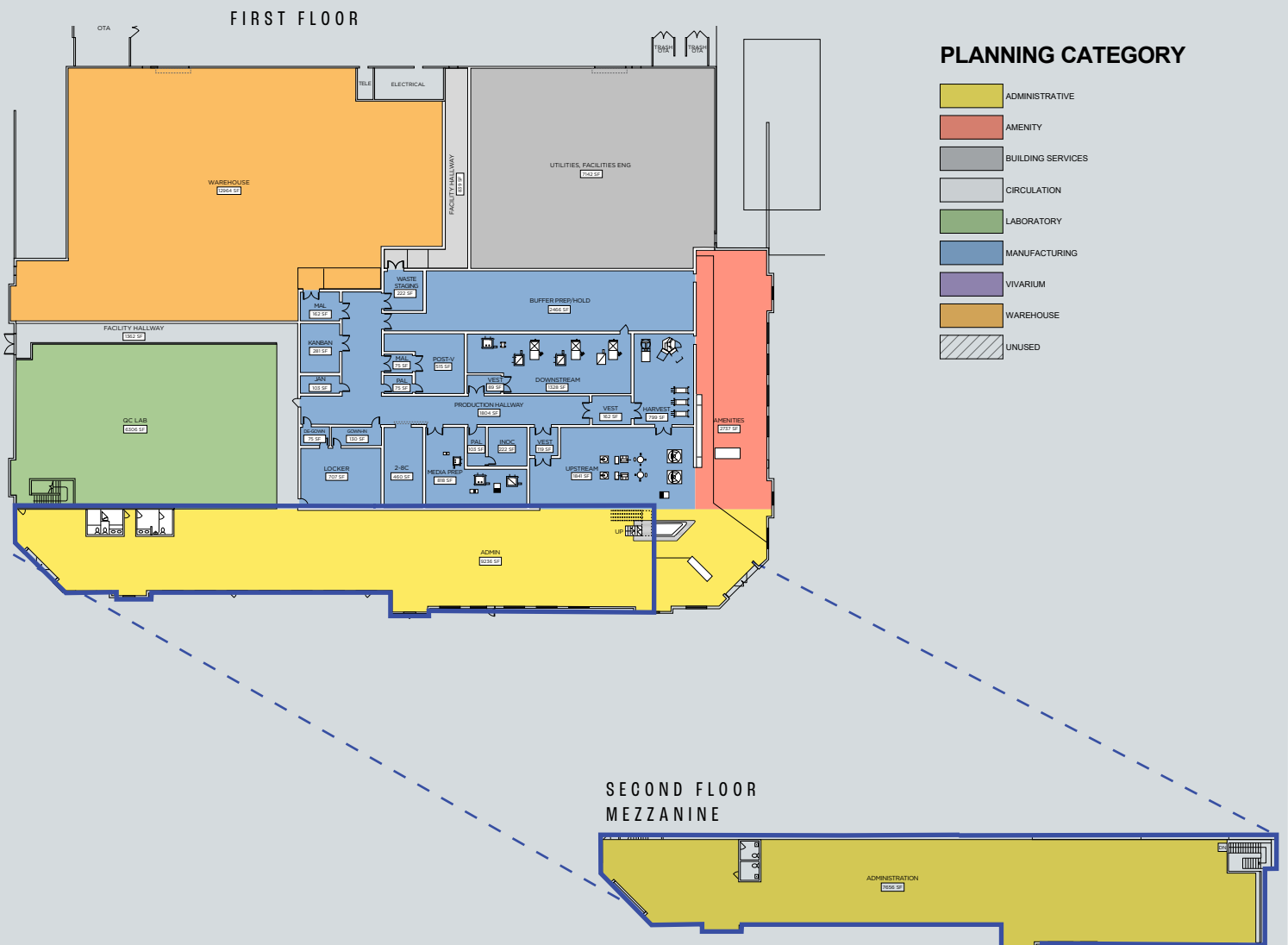





COURTYARD CONCEPTUAL RENDERINGS



COURTYARD CONCEPTUAL RENDERINGS



6197 NORTHPOINTE



6215 NORTHPOINTE

CORPORATE NEIGHBORS



RETAIL AMENITIES



AMENITIES - BRESSI RANCH

ENCINITAS

DOWNTOWN CARLSBAD

NORTHPOINTE

5 5 MIN

PALOMAR AIRPORT

PALOMAR COMMONS

LIFT

Eureka! DEL LUSSO

BRESSI RANCH

Logos for Bressi Ranch amenities:

- YATER
- PICK UP STIX
- CHASE
- petco
- TRADER JOE'S
- rubio's
- Board & Brew
- SUPERCUTS
- Peets COFFEE
- FISH DISTRICT
- nékter JUICE BAR
- Tommy's
- Luna Grill fresh mediterranean
- twig hair lounge
- BLOOM a women's boutique
- BOYS & GIRLS CLUBS
- verizon

Logos for Palomar Commons amenities:

- LOWE'S
- Chipotle
- FIVE GUYS BURGERS and FRIES
- noodles
- Jersey Mike's
- Tanera
- CALIFORNIA BANK

Logos for The Square amenities:

- BevMo!
- SPROUTS
- CVS pharmacy
- RICHARD WALKERS
- CASERO
- BIRD ROCK COFFEE ROASTERS
- MENDOCINO FARMS
- MISSION FEDERAL CREDIT UNION
- Manzo • Manzo
- TRADING



WALKABLE AMENITIES

INTERSTATE 5 5 MIN



PALOMAR AIRPORT

NORTHPOINTE



El Camino Real

Palomar Airport Road

PALOMAR COMMONS



Chipotle

FIVE GUYS
BURGERS and FRIES





CARLSBAD, CA

The site is centrally located in a Carlsbad, North County San Diego’s largest and most desired market, as well as San Diego’s fastest growing submarket.

Beyond its regional importance, NorthPointe is located in one of Southern California’s most appealing live/work/play communities.

An abundance of restaurants, shops, conveniences and recreation are all within ten minutes of the property.

DRIVE TIMES

8	10	35	42	96
8 minutes to McClellan Palomar Airport Highway 78	10 minutes to Interstate 5 Pacific Ocean Interstate 15	35 minutes to Orange County	42 minutes to Downtown San Diego	96 minutes to Riverside County



NorthPointe

6197 & 6215 El Camino Real
Carlsbad, CA

Aric Starck +1 (760) 431-4211 / aric.starck@cushwake.com
Brian Starck +1 (858) 546-5486 / brian.starck@cushwake.com



©2021 Cushman & Wakefield. All rights reserved. The information contained in this communication is strictly confidential. This information has been obtained from sources believed to be reliable but has not been verified. NO WARRANTY OR REPRESENTATION, EXPRESS OR IMPLIED, IS MADE AS TO THE CONDITION OF THE PROPERTY (OR PROPERTIES) REFERENCED HEREIN OR AS TO THE ACCURACY OR COMPLETENESS OF THE INFORMATION CONTAINED HEREIN, AND SAME IS SUBMITTED SUBJECT TO ERRORS, OMISSIONS, CHANGE OF PRICE, RENTAL OR OTHER CONDITIONS, WITHDRAWAL WITHOUT NOTICE, AND TO ANY SPECIAL LISTING CONDITIONS IMPOSED BY THE PROPERTY OWNER(S). ANY PROJECTIONS, OPINIONS OR ESTIMATES ARE SUBJECT TO UNCERTAINTY AND DO NOT SIGNIFY CURRENT OR FUTURE PROPERTY PERFORMANCE.

NORTHPOINTE DOCK LOADING

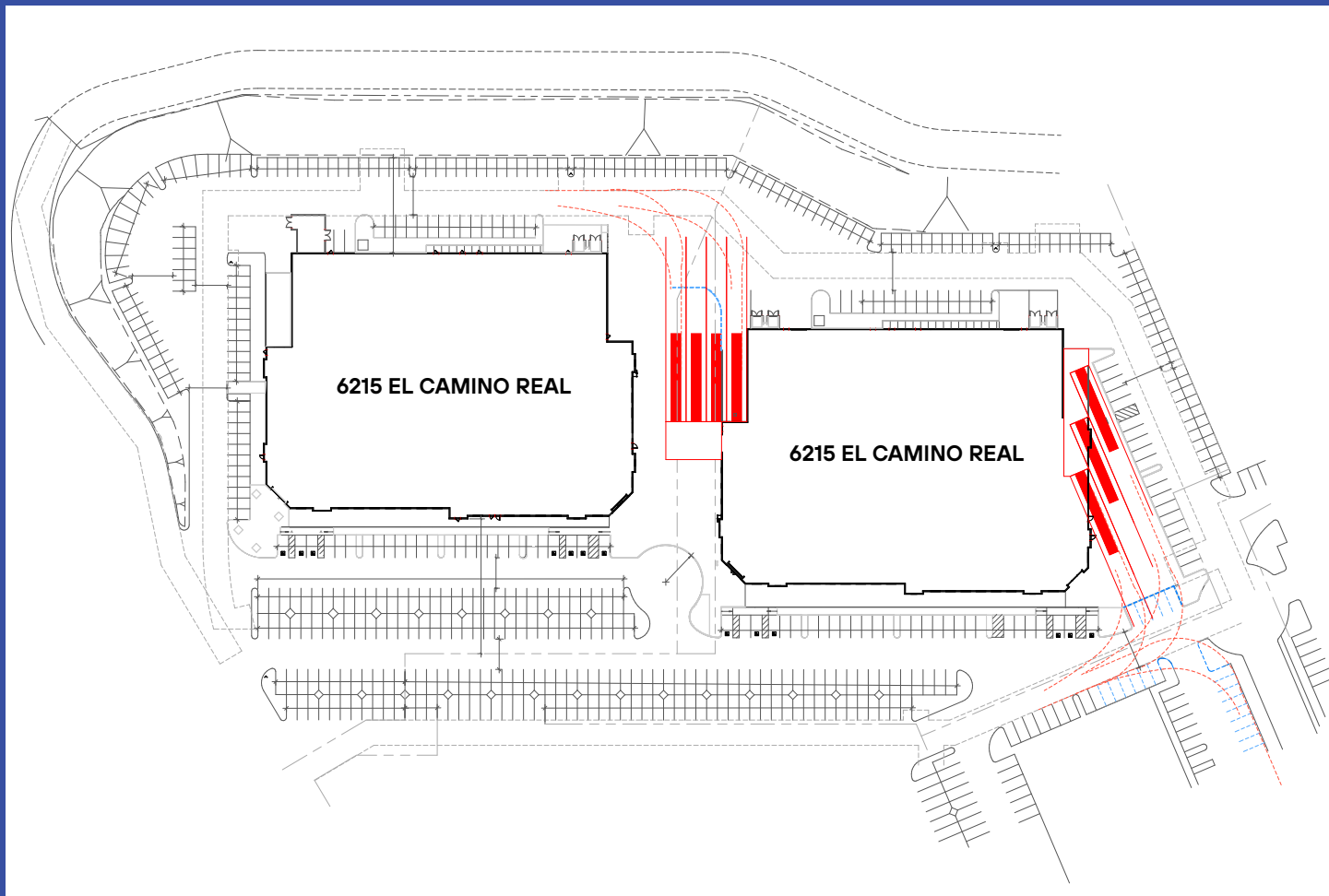

SITE LEGEND

- (E) EASEMENT
- DEMOLISHED ITEMS
- █ TRUCK (70' TOTAL LENGTH W/ 53' TRAILER)
- - - TRUCK TURNING RADIUS
- █ LOADING DOCK BAY (16' W)

