



# 260 SOUTH PACIFIC STREET

**FOR LEASE**  
**260 S. Pacific Street, San Marcos**

**23,108 + 38,680 SF**  
Warehouse/Distribution/Manufacturing

**GREG LEWIS**  
+1 858 699 1629  
greg.lewis@jll.com  
RE lic. #01365602

**ANDY IRWIN**  
+1 858 232 1709  
andy.irwin@jll.com  
RE lic. #01302674

**BLAKE RODGERS**  
+1 858 410 1192  
blake.rodgers@jll.com  
RE lic. #02015513



Jones Lang LaSalle Brokerage, Inc., Real estate license #01856260



### Convenient Loading

Easy access to dock high loading off S. Pacific Street



### Prominent Frontage

Front units offering excellent signage/identity



### Secure Site

Gated access and parking

# THE SITE

## FOR LEASE

### 23,108 SF + 38,680 SF

Unique opportunity to secure a strategic location in a supply constrained market.

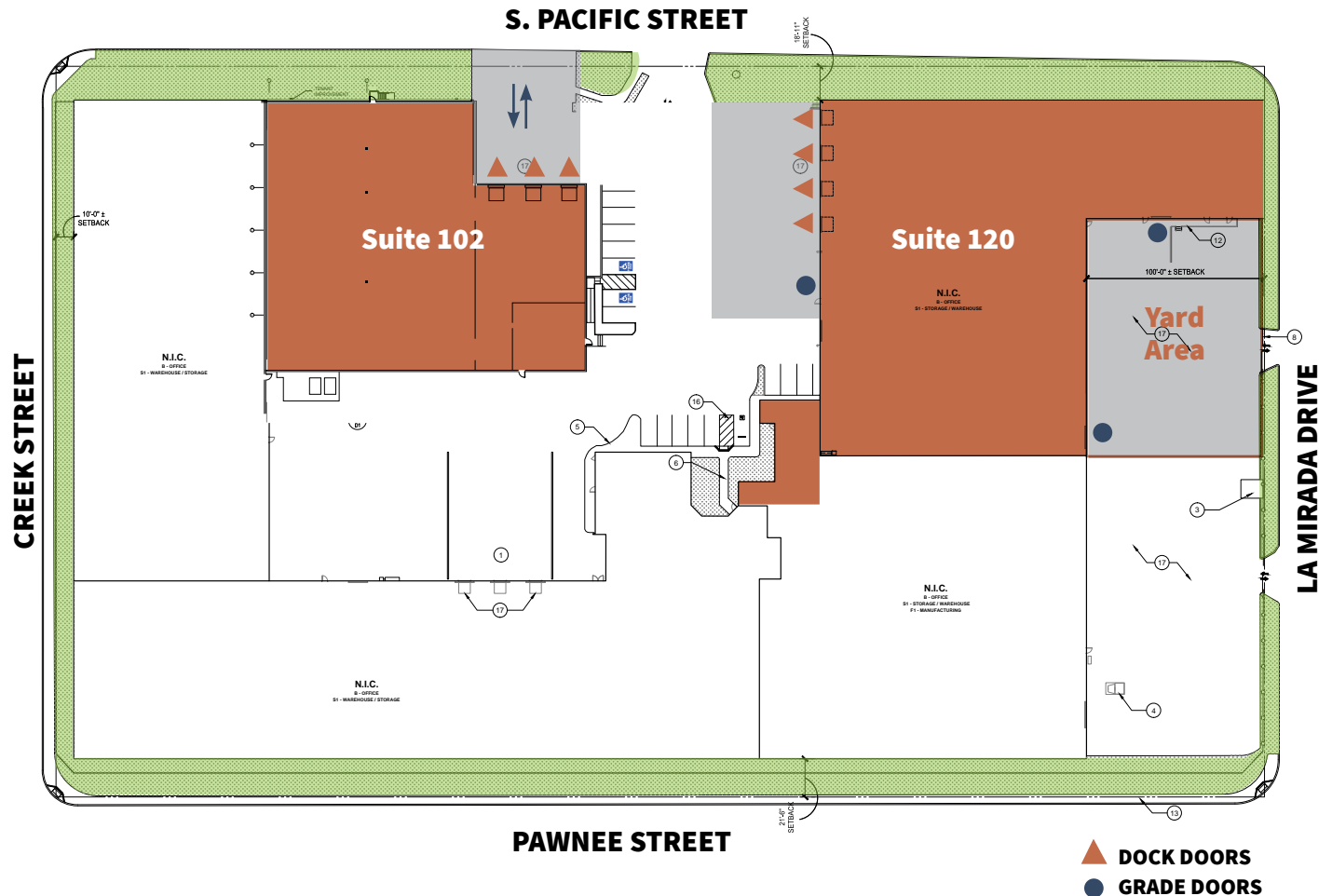



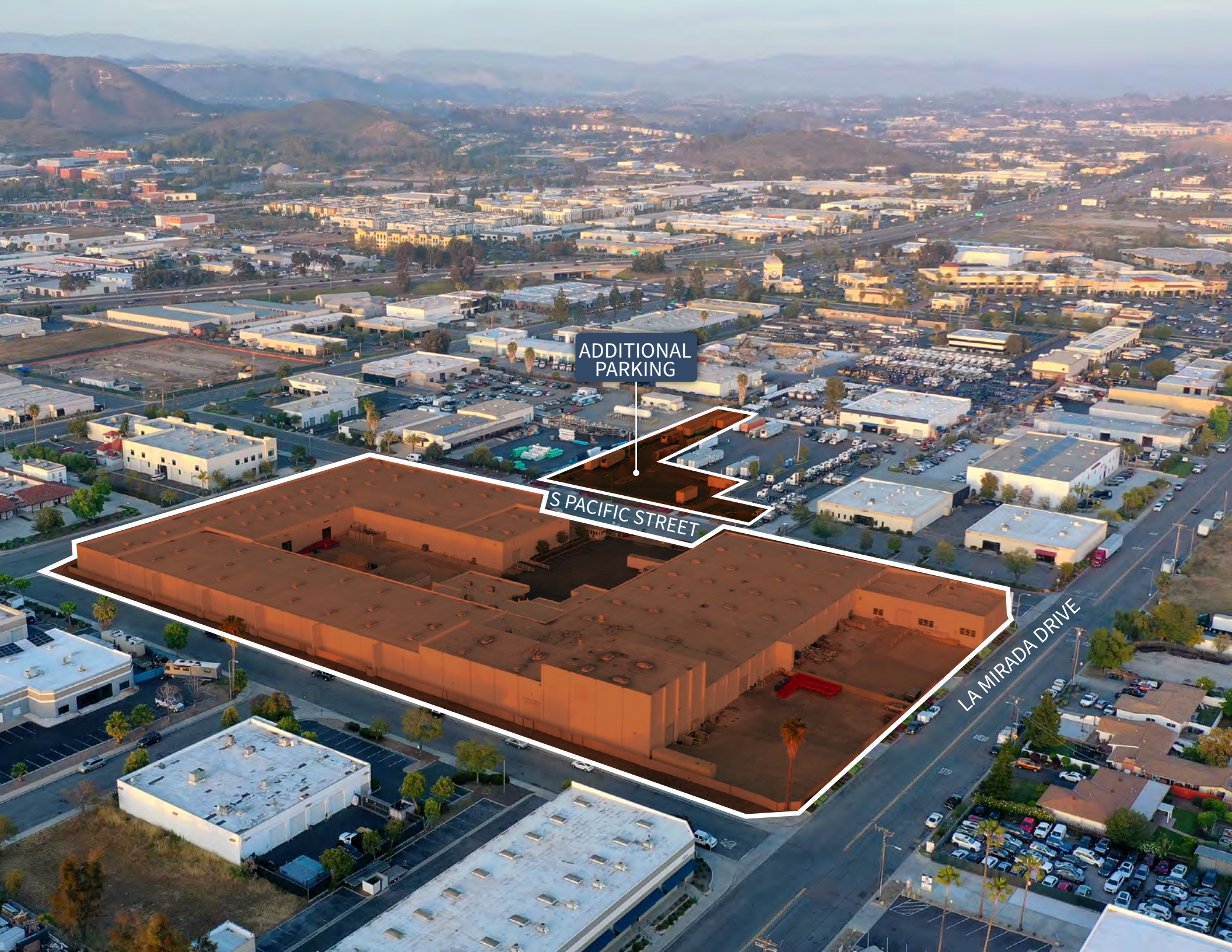

ADDITIONAL  
PARKING

S PACIFIC STREET

LA MIRADA DRIVE



260 S. Pacific Street, Suite 102

# FLOOR PLAN Available NOW



23,108 SF



3 Dock High Doors



1,396 SF Spec Office Planned



18'-20' clear height



ESFR



Heavy Power Potential

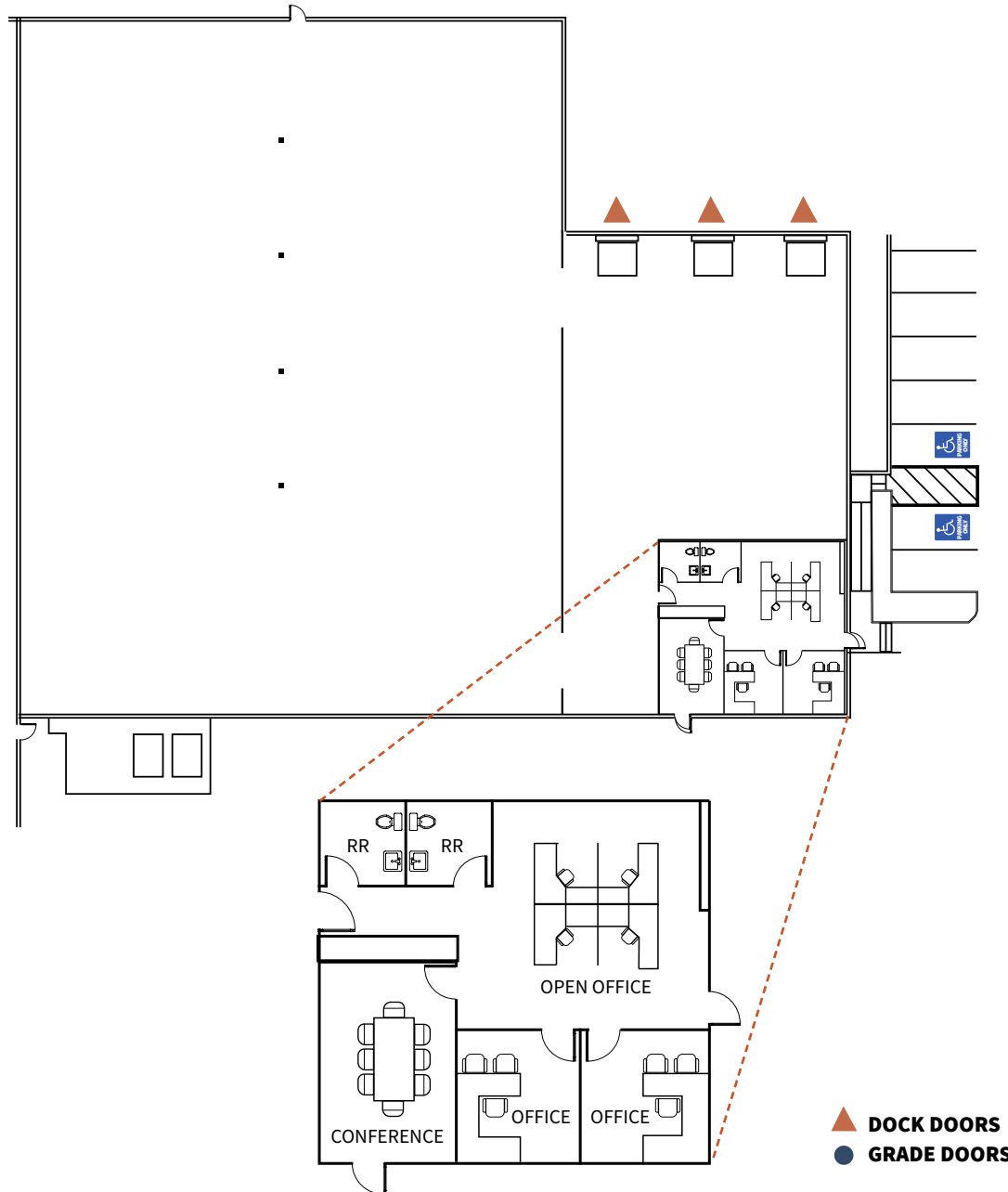



38,680 SF



4 Dock High Doors  
3 Grade Level Doors



1,910 SF Existing  
Office Area



16'-20' clear height



ESFR



Heavy Power  
Potential



0.30 Acre Fenced  
Yard

260 S. Pacific Street, Suite 120

# FLOOR PLAN

Available  
03/01/2024

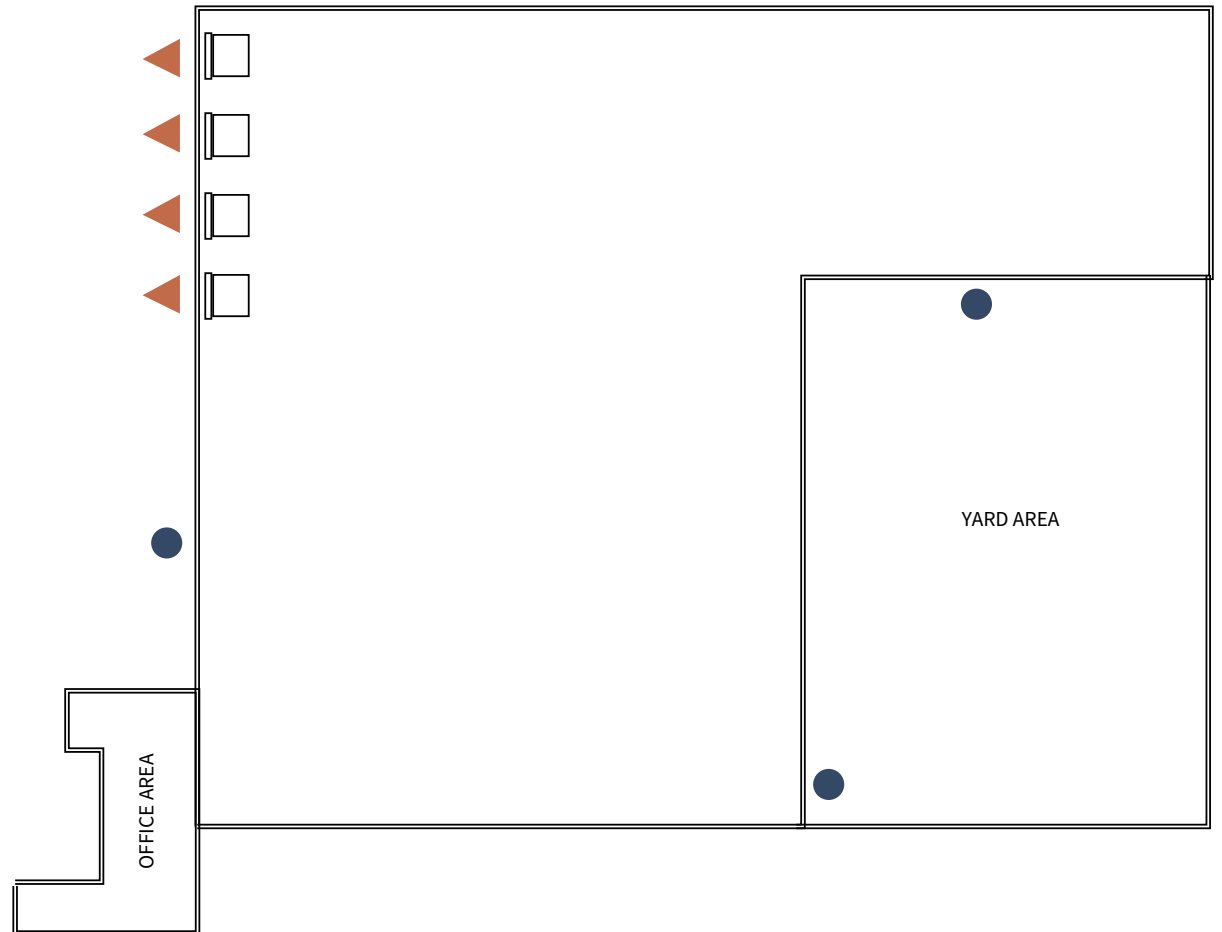

▲ DOCK DOORS  
● GRADE DOORS

# ACCESS AT YOUR DOORSTEP



**Equidistant to  
Interstates 5 & 15**



**Less than 1 mile from  
multiple access points to  
Hwy 78**



**Close proximity to  
Cal State San Marcos**



# THE LOCATION

Unparalleled access to customers

## SURROUNDING AREA



### POPULATION

**724,870**  
within 10 miles

**198,081**  
within 5 miles

**76,783**  
within 3 miles



### 2020 HOUSING UNITS

**267,264**  
within 10 miles

**73,408**  
within 5 miles

**19,132**  
within 3 miles



### 2020 MEDIAN HOUSEHOLD INCOME

**\$89,200**  
within 10 miles

**\$101,212**  
within 5 miles

**\$109,343**  
within 3 miles

Oceanside

San Marcos

Carlsbad

3 miles

5 miles

10 miles

78

15

5

La Costa

Encinitas

Rancho Santa Fe

Solana Beach



## Drive times to:

- 1 hr 36 min**  
Port of LA/Long Beach
- 40 min**  
Orange County
- 45 min**  
Riverside County
- 45 min**  
Downtown/Airport
- 55 min**  
Mexico Border

## San Diego quick stats:

**3.3M**

**5TH MOST POPULOUS COUNTY IN US**

**#2**

**FASTEST GROWING ECONOMY IN CALIFORNIA**

**158K**

**COLLEGE STUDENTS IN SAN DIEGO INCLUDING 46K IN SAN MARCOS**







# CORPORATE NEIGHBORS







CALIFORNIA  
78

ADDITIONAL  
PARKING

S PACIFIC STREET

NAVAJO STREET

LA MIRADA DRIVE

# FOR MORE INFORMATION

**GREG LEWIS**

+1 858 699 1629  
greg.lewis@jll.com  
RE lic. #01365602

**ANDY IRWIN**

+1 858 410 6376  
andy.irwin@jll.com  
RE lic. #01302674

**BLAKE RODGERS**

+1 949 273 1192  
blake.rodgers@jll.com  
RE lic. #02015513

Although information has been obtained from sources deemed reliable, neither Owner, nor JLL, makes any guarantees, warranties, or representations, express or implied, as to the completeness or accuracy as to the information contained herein. Any projections, opinions, assumptions, or estimates used are for example only. There may be differences between projected and actual results, and those differences may be material. The Property may be withdrawn without notice. Neither Owner nor JLL accepts any liability for any loss or damage suffered by any party resulting from reliance on this information. If the recipient of this information has signed a confidentiality agreement regarding this matter, this information is subject to the terms of that agreement. ©2023. Jones Lang LaSalle IP, Inc. All rights reserved.