

±48,976 SF INDUSTRIAL WAREHOUSES ON 3.79 ACRES

For Lease | 480 North Spruce Street, Escondido, CA



FOR MORE INFORMATION CONTACT

TODD DAVIS, CCIM, SIOR
760.430.1000
todd.davis@kidder.com
LIC N° 01383147

JIM BENSON
760.822.7428
jim.benson@kidder.com
LIC N° 01204845



FOR LEASE | ±48,976 SF

Industrial Warehouses on 3.79 Acres

480 NORTH SPRUCE STREET, ESCONDIDO, CA 92025

PROPERTY FEATURES

Address	480 North Spruce St, Escondido, CA 92025
Year Built	1982
RBA	±48,976 SF Building 1 - 33,976 SF Building 2 - 15,000 SF
Office	7% Office Space with 1,500 SF of 2nd story lunchroom, restrooms and lockers
Parking	76 Parking Spaces (Expandable)
Land Area	3.79 AC
Zoning	M-1 (City of Escondido)
Power	2,000 Amps, 277 / 480 Volt, 3-Phase
Loading	7 Dock High Doors 7 Grade Level Doors 9 Dock High Platforms
Ceiling Height	21'
Driveways	Concrete
Outdoor Storage	20,000 SF
Sprinklers	Sprinkler System Throughout
Date Available	Now

Lease Rate

Submit Offer*

*Low NNNs - City does not pay property taxes

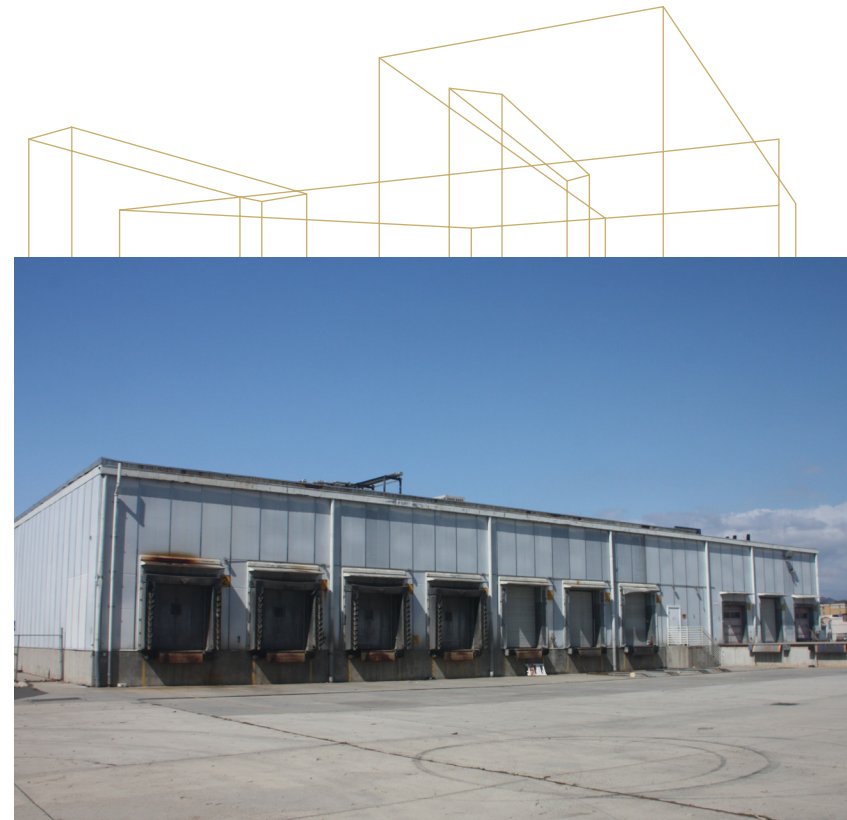

FOR LEASE | ±48,976 SF

Industrial Warehouses on 3.79 Acres

480 NORTH SPRUCE STREET, ESCONDIDO, CA 92025

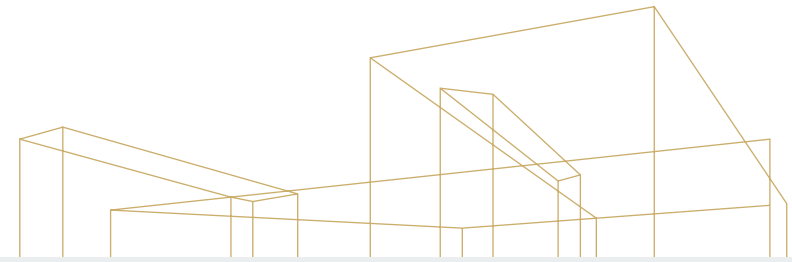

FLOOR PLAN

±48,976

SQUARE FEET AVAILABLE

20,000

SQUARE FEET OUTDOOR STORAGE

- G** Grade Level
- D** Dock Position
- * Cold Storage Docks with Levelors
- ** Dock High Doors with Levelors

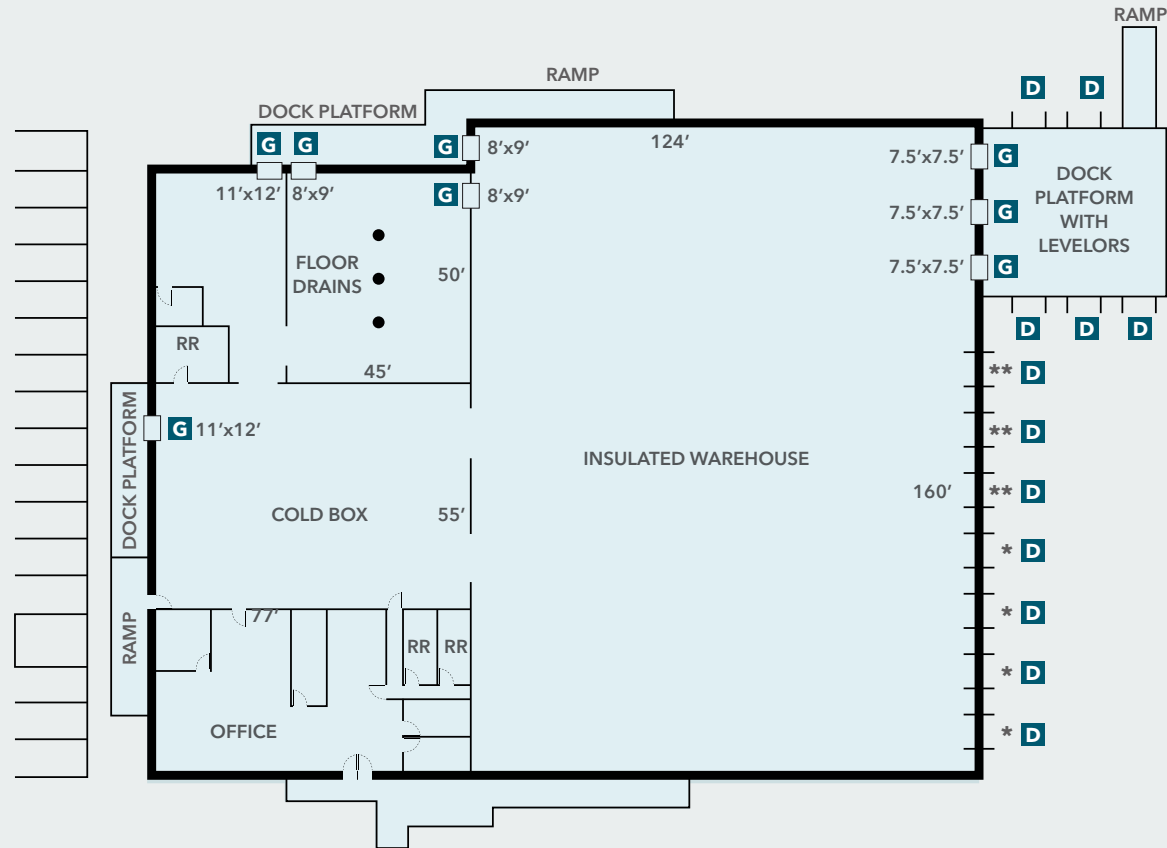

For more
information
contact

TODD DAVIS, CCIM, SIOR
760.430.1000
todd.davis@kidder.com
LIC N° 01383147

JIM BENSON
760.822.7428
jim.benson@kidder.com
LIC N° 01204845

KIDDER.COM

This information supplied herein is from sources we deem reliable. It is provided without any representation, warranty, or guarantee, expressed or implied as to its accuracy. Prospective Buyer or Tenant should conduct an independent investigation and verification of all matters deemed to be material, including, but not limited to, statements of income and expenses. Consult your attorney, accountant, or other professional advisor.



FOR LEASE | ±48,976 SF

Industrial Warehouses on 3.79 Acres

480 NORTH SPRUCE STREET, ESCONDIDO, CA 92025

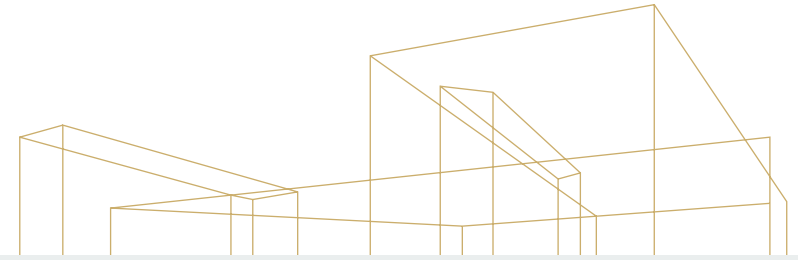

SITE PLAN

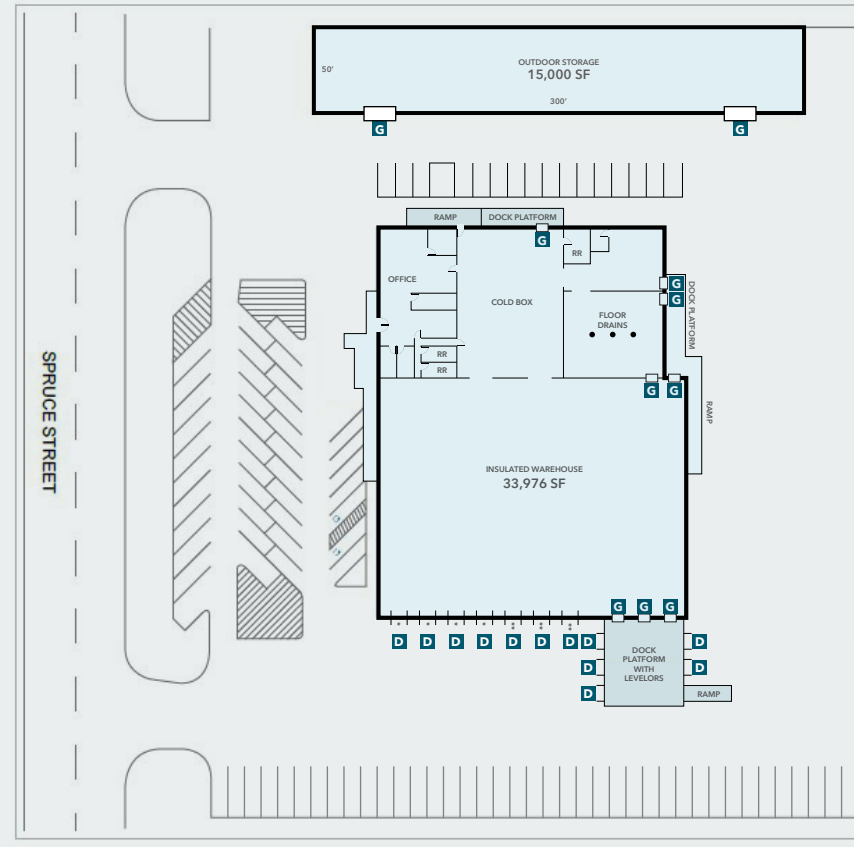

For more
information
contact

TODD DAVIS, CCIM, SIOR
760.430.1000
todd.davis@kidder.com
LIC N° 01383147

JIM BENSON
760.822.7428
jim.benson@kidder.com
LIC N° 01204845

KIDDER.COM

This information supplied herein is from sources we deem reliable. It is provided without any representation, warranty, or guarantee, expressed or implied as to its accuracy. Prospective Buyer or Tenant should conduct an independent investigation and verification of all matters deemed to be material, including, but not limited to, statements of income and expenses. Consult your attorney, accountant, or other professional advisor.



FOR LEASE | ±48,976 SF

Industrial Warehouses on 3.79 Acres

480 NORTH SPRUCE STREET, ESCONDIDO, CA 92025

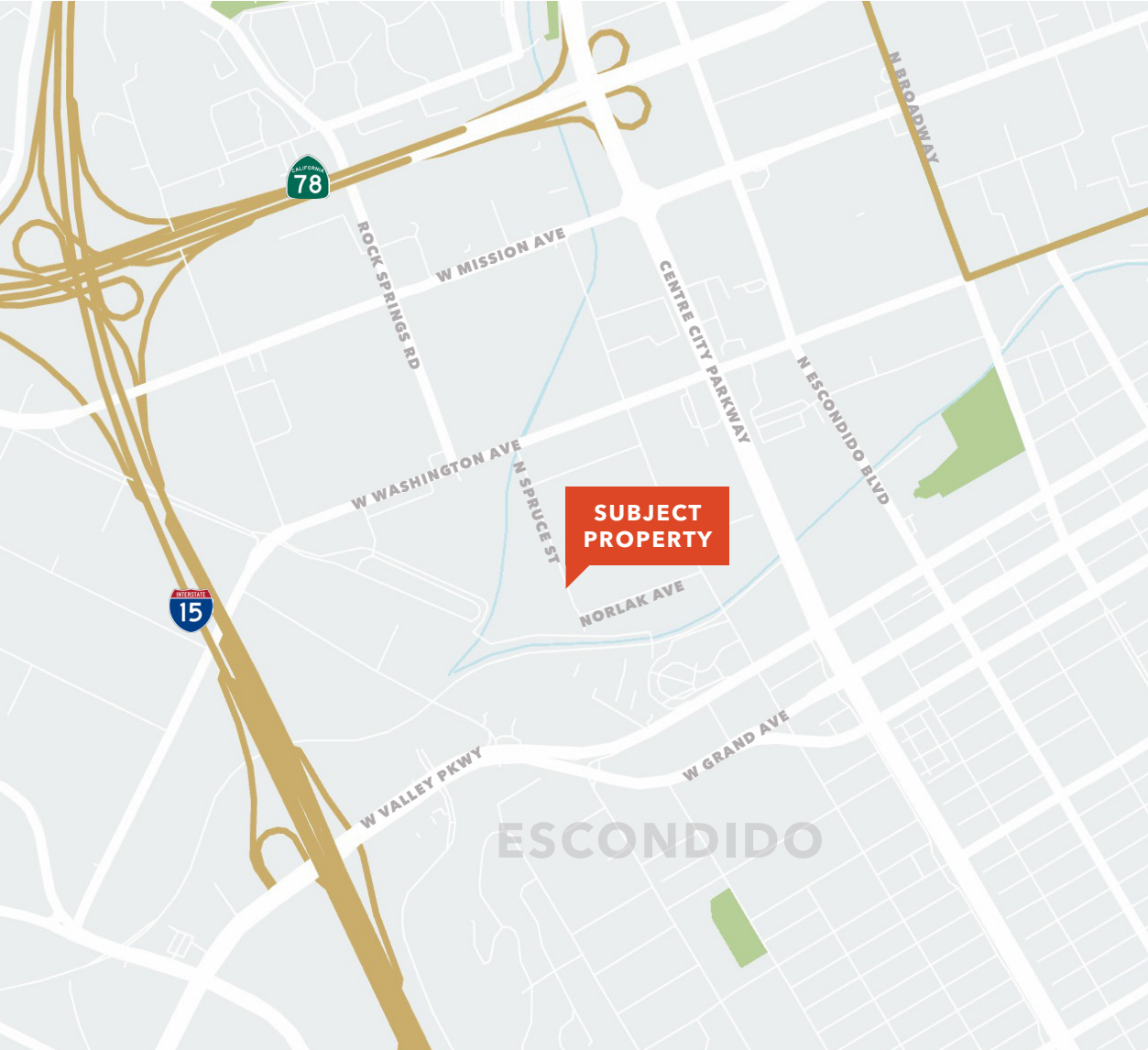

DRIVE TIMES

Oceanside	25 Minutes
Palomar Airport	25 Minutes
Fallbrook	33 Minutes
El Cajon	36 Minutes
Downtown San Diego	37 Minutes
US / Mexico Border	53 Minutes

This information supplied herein is from sources we deem reliable. It is provided without any representation, warranty, or guarantee, expressed or implied as to its accuracy. Prospective Buyer or Tenant should conduct an independent investigation and verification of all matters deemed to be material, including, but not limited to, statements of income and expenses. Consult your attorney, accountant, or other professional advisor.



For more information contact

TODD DAVIS, CCIM, SIOR
760.430.1000
todd.davis@kidder.com
LIC N° 01383147

JIM BENSON
760.822.7428
jim.benson@kidder.com
LIC N° 01204845

KIDDER.COM

This information supplied herein is from sources we deem reliable. It is provided without any representation, warranty, or guarantee, expressed or implied as to its accuracy. Prospective Buyer or Tenant should conduct an independent investigation and verification of all matters deemed to be material, including, but not limited to, statements of income and expenses. Consult your attorney, accountant, or other professional advisor.

