

FOR LEASE > OFFICE WITH FENCED YARD SPACE

467-473 Olive Avenue

Vista, CA 92083

LOCATED IN HUB ZONE



PROPERTY FEATURES

- » Two Office Buildings Totaling 2,213 SF
- » Zoning: M-1
- » Located in the HUB Zone
- » Close Proximity to Hwy 78
- » Call Brokers to Show

LEASE OPTIONS

- » Two Office Buildings and Yard Space - \$2,400/Month
- » Front Office Building Only with Small Yard - \$1,200/Month

LOCATION

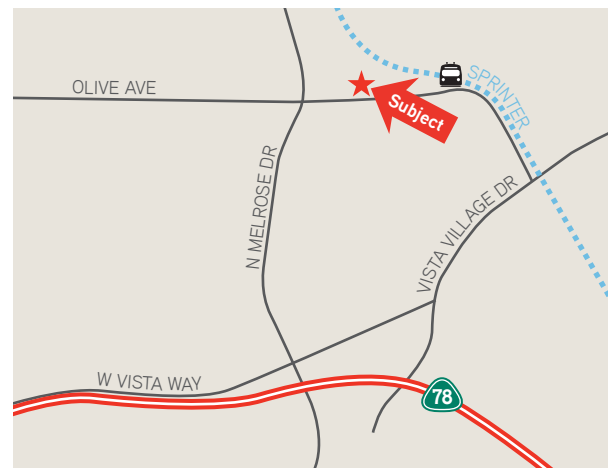

John Witherall
760 930 7927
john.witherall@colliers.com
Lic. #01759453

Joe McDermott
858 509 1200
joem@kiddermatthews.com
Lic. #01329963

5901 Priestly Drive, Suite 100
Carlsbad, CA 92008
www.colliers.com/carlsbad



FOR LEASE > OFFICE WITH FENCED YARD SPACE

467-473 Olive Avenue

Vista, CA 92083

SITE PLAN

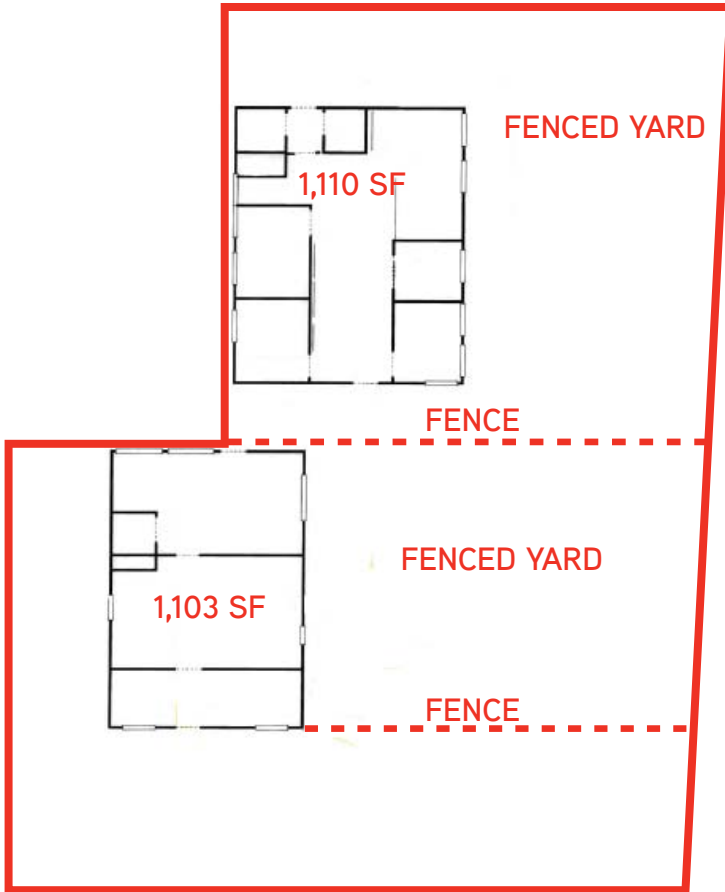

This document has been prepared by Colliers International for advertising and general information only. Colliers International makes no guarantees, representations or warranties of any kind, expressed or implied, regarding the information including, but not limited to, warranties of content, accuracy and reliability. Any interested party should undertake their own inquiries as to the accuracy of the information. Colliers International excludes unequivocally all inferred or implied terms, conditions and warranties arising out of this document and excludes all liability for loss and damages arising therefrom. Colliers International is a worldwide affiliation of independently owned and operated companies.

John Witherall
760 930 7927
john.witherall@colliers.com
Lic. #01759453

Joe McDermott
858 509 1200
joem@kiddermatthews.com
Lic. #01329963

5901 Priestly Drive, Suite 100
Carlsbad, CA 92008
www.colliers.com/carlsbad

