

FOR LEASE > 12,060 SF INDUSTRIAL SPACE

Vista Industrial Park

970 Park Center Drive, Suite B | Vista, CA 92081



24' - 26' Clear Height



PROPERTY HIGHLIGHTS

- » 12,060 SF available
- » Easy access to I-5 and Highway 78
- » 20% Office; Newly constructed and renovated
- » 24'-26' Clear height
- » 600 amps of 120/208 volt power
- » One (1) 16' grade-level door
- » Drive around access, gated parking areas
- » Available now
- » **Lease rate: \$0.75 NNN**



Russ Jabara
760 930 7923
russ.jabara@colliers.com
Lic. #01315296

Dave Pinnegar
760 930 7942
dave.pinnegar@colliers.com
Lic. #00856143

John Witherall
760 930 7927
john.witherall@colliers.com
Lic. #01759453

5901 Priestly Drive, Suite 100
Carlsbad, CA 92008
www.colliers.com/carlsbad

FOR LEASE > 12,060 SF INDUSTRIAL SPACE

Vista Industrial Park

970 Park Center Drive, Suite B | Vista, CA 92081



FLOOR PLAN & SITE PLAN

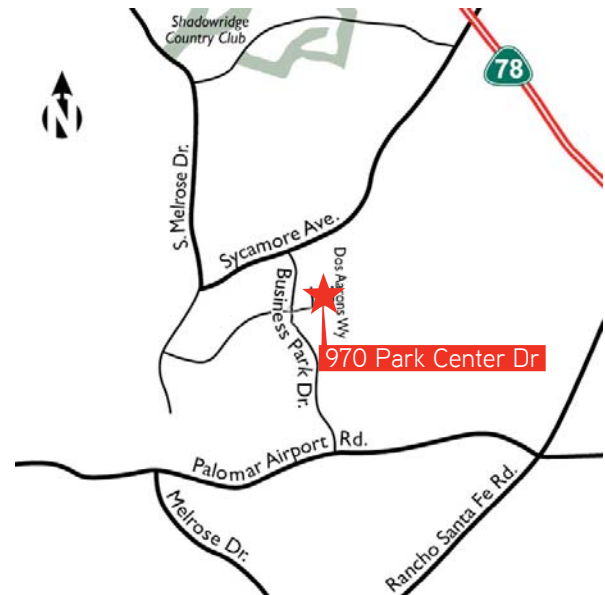
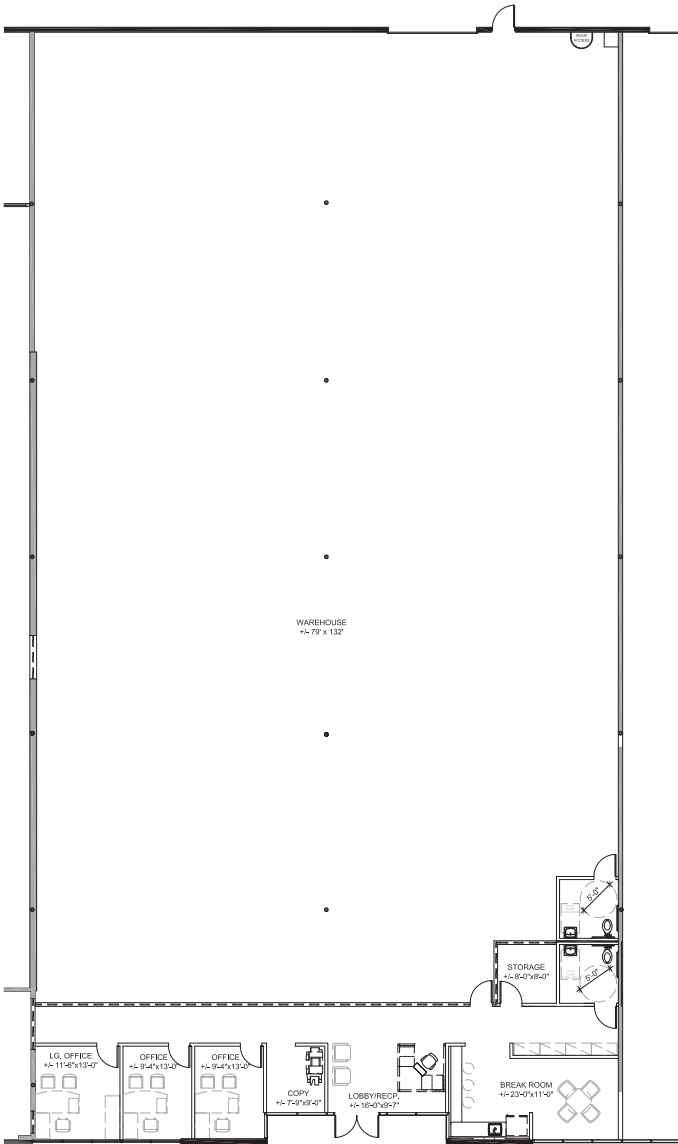

Additional office can be constructed, per tenant's needs

This document has been prepared by Colliers International for advertising and general information only. Colliers International makes no guarantees, representations or warranties of any kind, expressed or implied, regarding the information including, but not limited to, warranties of content, accuracy and reliability. Any interested party should undertake their own inquiries as to the accuracy of the information. Colliers International excludes unequivocally all inferred or implied terms, conditions and warranties arising out of this document and excludes all liability for loss and damages arising therefrom. Colliers International is a worldwide affiliation of independently owned and operated companies.

Russ Jabara
760 930 7923
russ.jabara@colliers.com
Lic. #01315296

Dave Pinnegar
760 930 7942
dave.pinnegar@colliers.com
Lic. #00856143

John Witherall
760 930 7927
john.witherall@colliers.com
Lic. #01759453

5901 Priestly Drive, Suite 100
Carlsbad, CA 92008
www.colliers.com/carlsbad