

FOR LEASE > 2,712 SF INDUSTRIAL SPACE

Waterview Business Park

1392 Poinsettia Avenue, Suite C | Vista, CA 92081

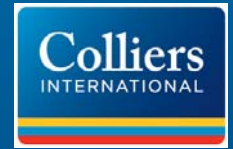

PROPERTY HIGHLIGHTS

- » Approximately 2,712 Rentable Square Feet
- » Reception, One Private Office, Breakroom, Restroom
- » Loading: One Roll Up Door
- » Parking: 2.92/1,000 SF
- » Fire Sprinklers
- » Natural Gas Available
- » Call to Show.
- » Lease Rate: \$1.05/SF

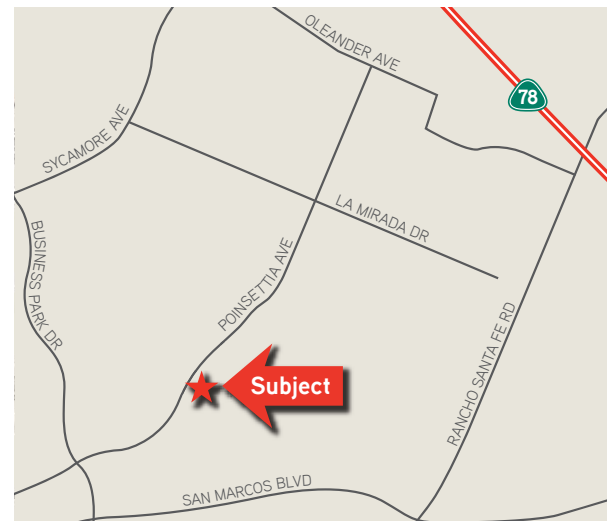

John Witherall
760 930 7927
john.witherall@colliers.com
Lic. #01759453

5901 Priestly Drive, Suite 100
Carlsbad, CA 92008
www.colliers.com/carlsbad

FOR LEASE > 2,712 SF INDUSTRIAL SPACE

Waterview Business Park

1392 Poinsettia Avenue, Suite C | Vista, CA 92081

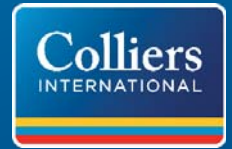

FLOOR PLAN & SITE PLAN

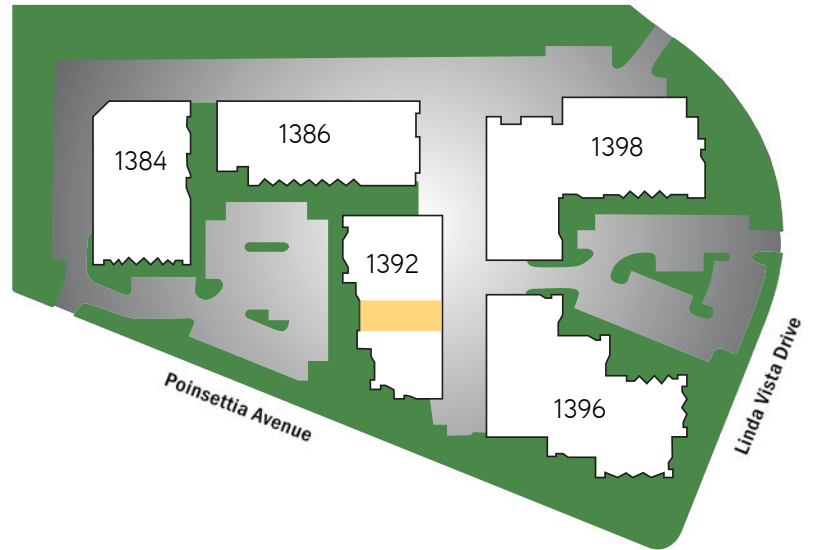
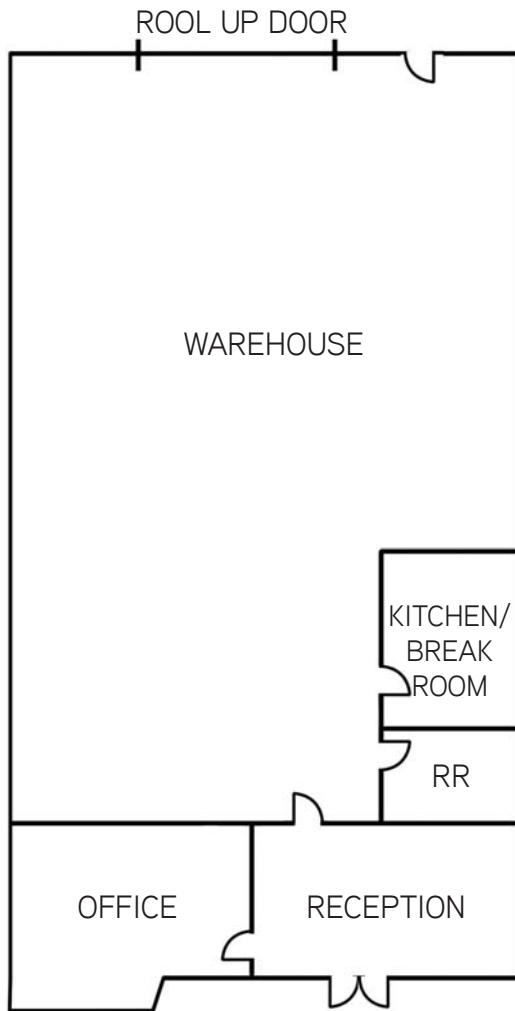

This document has been prepared by Colliers International for advertising and general information only. Colliers International makes no guarantees, representations or warranties of any kind, expressed or implied, regarding the information including, but not limited to, warranties of content, accuracy and reliability. Any interested party should undertake their own inquiries as to the accuracy of the information. Colliers International excludes unequivocally all inferred or implied terms, conditions and warranties arising out of this document and excludes all liability for loss and damages arising there from. Colliers International is a worldwide affiliation of independently owned and operated companies.

John Witherall
760 930 7927
john.witherall@colliers.com
Lic. #01759453

5901 Priestly Drive, Suite 100
Carlsbad, CA 92008
www.colliers.com/sandiego