

FOR SALE | 1,965 SF

925 POINSETTIA AVE

SUITE 16, VISTA, CA 92081



INDUSTRIAL CONDO - BELLA VISTA BUSINESS PARK

This document has been prepared by Colliers International for advertising and general information only. Colliers International makes no guarantees, representations or warranties of any kind, expressed or implied, regarding the information including, but not limited to, warranties of content, accuracy and reliability. Any interested party should undertake their own inquiries as to the accuracy of the information. Colliers International excludes unequivocally all inferred or implied terms, conditions and warranties arising out of this document and excludes all liability for loss and damages arising therefrom. Colliers International is a worldwide affiliation of independently owned and operated companies.



FOR SALE | 1,965 SF

925 POINSETTIA AVE

SUITE 16, VISTA, CA 92081

Property Features

- » 1,965 SF industrial condo with reception, one office, restroom and warehouse
- » Excellent access to HWY 78, I-5, and I-15
- » Grade-level loading 10' x 12'
- » 20' Minimum clear height
- » Power: 200 amps, 3 phase
- » Parking: 2.32/1,000 SF
- » Currently occupied. Please call to show.
- » **ASKING SALE PRICE: \$332,000**

JOHN WITHERALL

760 930 7927

john.witherall@colliers.com

Lic. No. 01759453

5901 Priestly Drive, Suite 100, Carlsbad, CA 92008 | 760 438 8950 | www.colliers.com/carlsbad



Colliers
INTERNATIONAL



Floor Plan

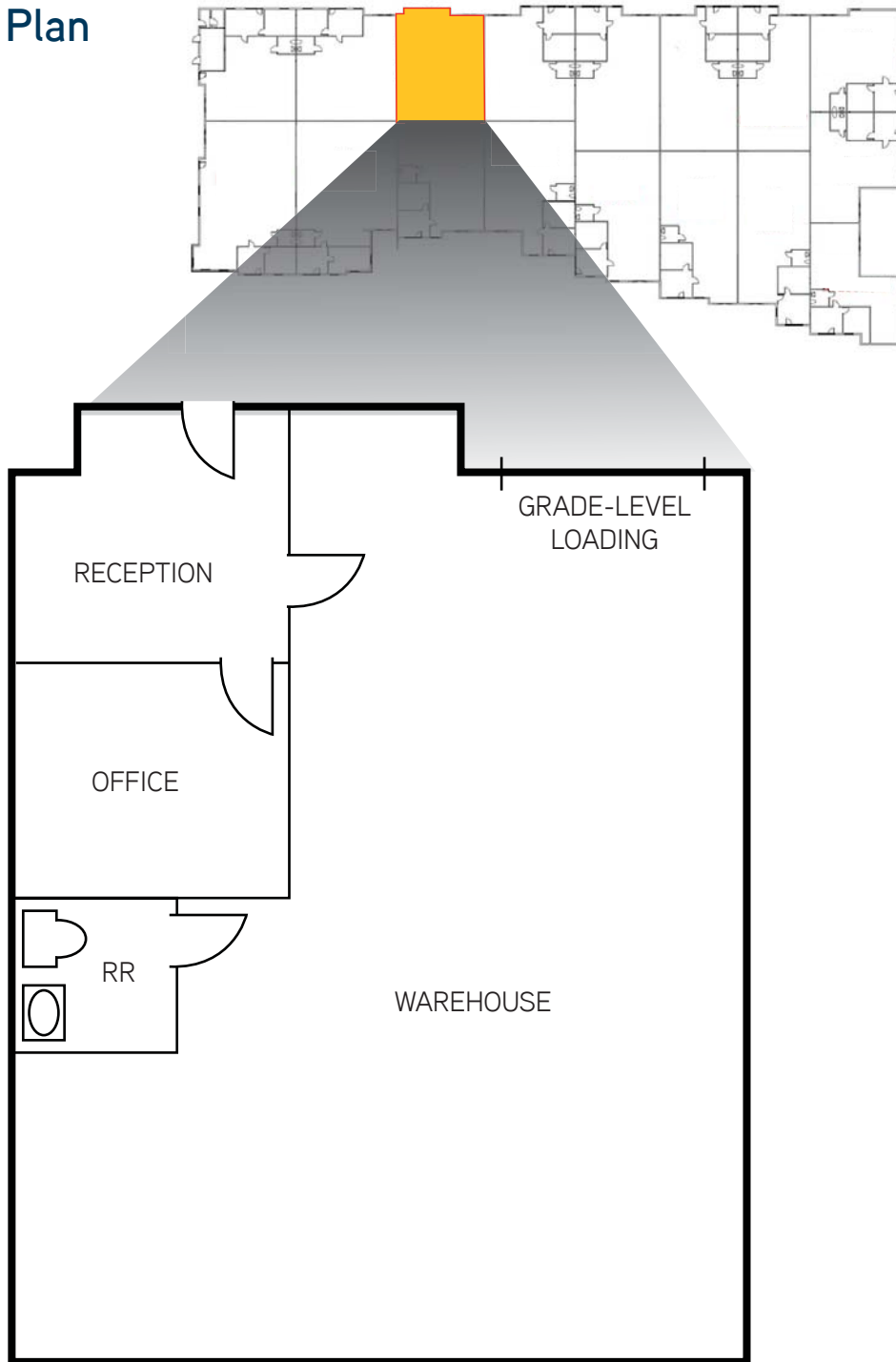

FOR SALE | 1,965 SF

925 POINSETTIA AVE

SUITE 16, VISTA, CA 92081



JOHN WITHERALL

760 930 7927

john.witherall@colliers.com

Lic. No. 01759453

5901 Priestly Drive, Suite 100, Carlsbad, CA 92008 | 760 438 8950 | www.colliers.com/carlsbad